

PRV4 PT Pressure Reducing Valve

Pressure Reducing Valve FxF ISO228 Parallel Thread

GENERAL INFORMATION

Size	Pattern No.	Pack 1 Qty	Code	Barcode
1/2	PRV4 PT	1	5A2031	5022050264244
3/4	PRV4 PT	1	5A2032	5022050264367
1	PRV4 PT	1	5A2033	5022050264510
1 1/4	PRV4 PT	1	5A2034	5022050264633
1 1/2	PRV4 PT	1	5A2035	5022050264787
2	PRV4 PT	1	5A2036	5022050264923
2 1/2	PRV4 PT	1	5A2037	5022050265050
3	PRV4 PT	1	5A2038	5022050265210
4	PRV4 PT	1	5A2039	5022050265357

DIMENSIONS (mm)

Code	Description	A	B	C	Kg
5A2031	1/2 PRV4 PT	118	77	99	0.706
5A2032	3/4 PRV4 PT	141	91	73	1.116
5A2033	1 PRV4 PT	152	91	75	1.326
5A2034	1.1/4 PRV4 PT	217	116	94	2.294
5A2035	1.1/2 PRV4 PT	218	125	95	2.422
5A2036	2 PRV4 PT	244	142	114	3.618
5A2037	2.1/2 PRV4 PT	264	147	114	3.998
5A2038	3 PRV4 PT	287	148	114	5.526
5A2039	4 PRV4 PT	325	188	125	6.798

GUARANTEE

Valves and Fittings

Pegler Yorkshire Customcare 5 Year Guarantee - Terms and Conditions

Products are subject to a 5 year guarantee that is between Pegler Yorkshire and the final purchaser of the product.

The guarantee is subject to proof of purchase being supplied.

This guarantee does not affect any statutory rights the consumer may have in law.

The guarantee covers manufacturing or material defects and does not cover parts subject to normal wear and tear.

This product range has been designed for the use of homeowners, domestic and commercial applications and therefore the guarantee is subject to the product being properly selected for their intended service conditions.

The guarantee is not applicable where the product is fitted contrary to the conditions in the fitting instructions.

This is reinforced where valves are covered by the European Pressure Equipment Directive (PED97/23/EC) where Installation, Operating and Maintenance Instructions are supplied with each product and/or carton.

Provided it is installed correctly and receives adequate preventative maintenance it should give years of trouble – free service.

Abusive behaviour and accidental damage to the product are not covered by this guarantee.

The extent of this liability is limited to the cost of the replacement of the defective item and not to fitting or consequential damages.

APPROVALS



[WRAS PRV4PT](#)

PEGLER

Installation, Care and Maintenance Instructions

PRV4PT – Pressure Reducing Valve

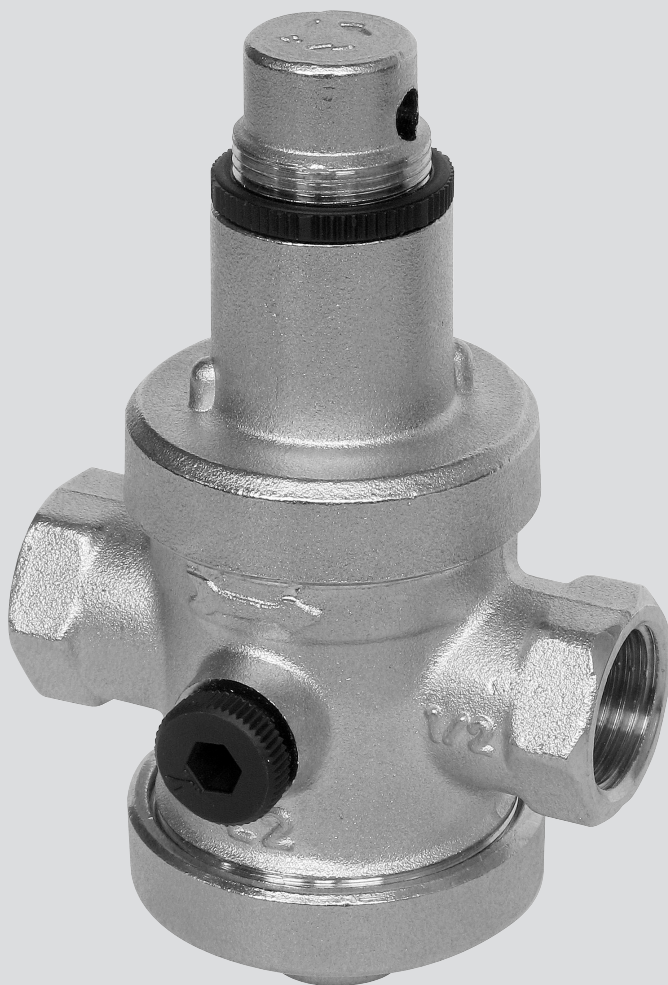

Features

- Brass water pressure reducing valves PN 25 with brass diaphragm functioning
- Maximum inlet pressure of 25 bar
- Maximum operating temperature: 80° C
- Adjustable outlet 0.5 - 6 bar; reduction rate 5:1
- Brass diaphragm
- Outlet pressure gauge connections 1/4" on both sides
- F x F connections ISO 228-1
- Stainless steel seat
- Stainless steel bar (pressure reducers bigger than 1")

Installation Guidelines

Pegler pressure reducing valves are suitable for domestic and industrial installations. In order to optimise use and life of the entire plant, please read the following installation guidelines. Before setting up the pressure reducer, remember to clean pipes removing sand, shavings, flashes, etc.

Discharge and Headloss Diagram

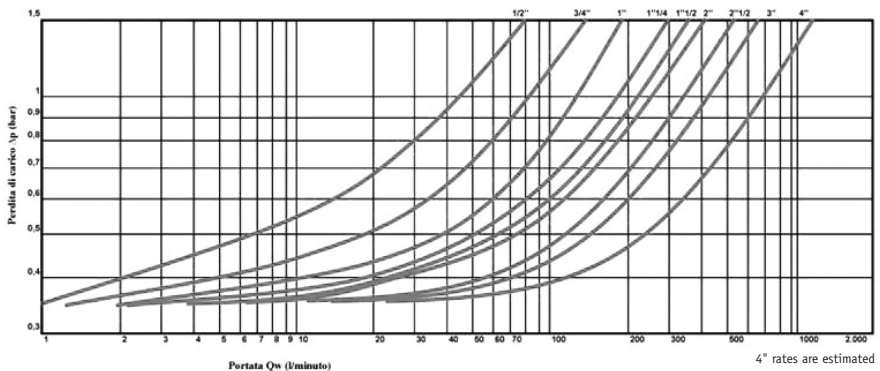

Typical Installation

- 1) Ball valve (PB500)
- 2) Self Cleaning Filter
- 3) PRV4PT Pressure reducing valve
- 4) Water hammer preventer
- 5) Expansion tank
- 6) Ball valve (PB500)

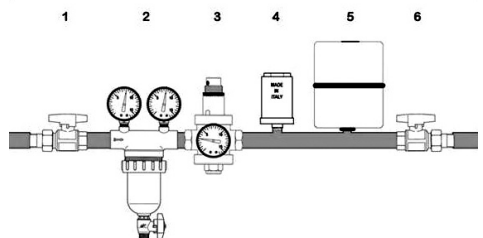

Orientation and Direction of Flow

In order to correctly set the pressure reducers, ensure that the flow direction indicated by the arrow embossed on the body of the pressure reducing valve is followed. The pressure reducing valves can work in any orientation (horizontal, vertical, up-side-down)

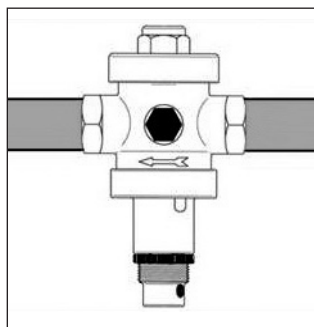
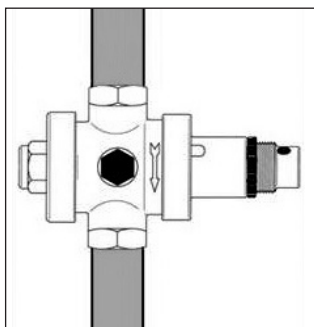
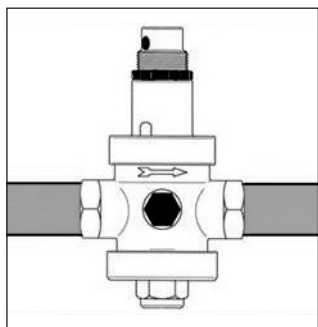

The PRV4PT pressure reducing valve has pressure gauge connections on both sides; both connections are placed on the outlet of the pressure reducing valve.

Pressure reducing valves should be installed at a reasonable distance from boilers; hot water produced by those devices, increases in volume and consequently also increases the pressure into the water plant downstream of the pressure reducing valve. This increase in pressure creates instability in the functioning of the pressure reducer. The fitting of an expansion vessel of the correct size between pressure reducers and boilers, will overcome this issue.

The PRV4PT pressure reducing valves are 100% tested and preset at 3 bar outlet.

To modify outlet pressure simply loosen the plastic locknut and turn the brass spring holder using a screwdriver as shown in the sequence below; by turning it clockwise the outlet pressure will be increased, turning it anticlockwise will reduce the outlet pressure.

The PRV4PT Pressure reducing valve must be set when the system is closed.

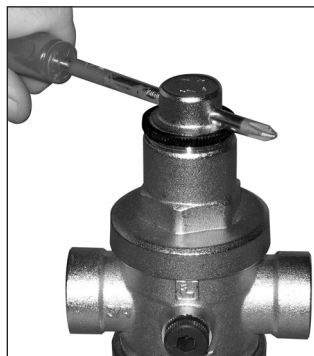

Our brands:

terrier

HEATING SOLUTIONS

YORKSHIRE

SOLDER RING SOLUTIONS

Tectite

PUSH-FIT SOLUTIONS

XPress

PRESS-FIT SOLUTIONS

ENDEX

END FEED SOLUTIONS

KUTERLITE

COMPRESSION SOLUTIONS

PRESTEX

DOMESTIC VALVE SOLUTIONS

PEGLER

COMMERCIAL VALVE SOLUTIONS

meibes

SOLAR SOLUTIONS

PERFORMA

UTILITY TAP AND MIXER SOLUTIONS

francis
pegler

LUXURY TAP SOLUTIONS



Pegler Yorkshire

UK sales

Free Phone: 0800 156 0010

Free Fax: 0808 156 1011

Email: uk.sales@pegler.yorkshire.co.uk

Export

Tel: +44 (0) 1302 855 656

Fax: +44 (0) 1302 730 513

Email: export@pegler.yorkshire.co.uk

Technical Help

Free Phone: 0800 156 0050

Free Fax: 0808 156 1012

Email: tech.help@pegler.yorkshire.co.uk

Brochure Hotline

Free Phone: 0800 156 0020

Free Fax: 0808 156 1011

Email: info@pegler.yorkshire.co.uk

www.pegler.yorkshire.co.uk

Pegler Yorkshire Group Limited

St. Catherine's Avenue, Doncaster,
South Yorkshire, DN4 8DF, England.
Tel: 0844 243 4400 Fax: 0844 243 9870

Registered in England Company No. 00401507
Registered Office: Haigh Park Road, Stourton, Leeds,
West Yorkshire, LS10 1RT, England.

All brand names and logo styles are registered trademarks.
Maintaining a policy of continual product development,
Pegler Yorkshire reserves the right to change specifications,
design and materials of products listed in this publication
without prior notice.

REF: XXXXXX