



Healthcare + Basin Pillar Tap Long Nose

GENERAL INFORMATION

Pattern No. key :CP : Chrome Plated

Size	Pattern No.	Pack 1 Qty	Code	Barcode
na	Basin Pillar Tap Long Nose CP Pair	1	360109	5022050173751

SPARES

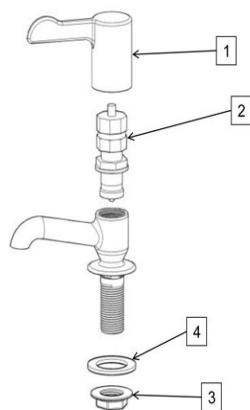

1

Pattern / Size	Description	Code	Barcode	Date From	Date To
Basin Pillar Tap Long Nose CP Pair / na	HDH59CP Handle with Screw Hot	854700	5022050218032	01/01/1900	current
Basin Pillar Tap Long Nose CP Pair / na	HDC59CP Handle with Screw Cold	854701	5022050222459	01/01/1900	current

2

Pattern / Size	Description	Code	Barcode	Date From	Date To
Basin Pillar Tap Long Nose CP Pair / na	HKH20 COMPLETE HEADWORK HOT	850859	5013866062704	01/01/1900	current
Basin Pillar Tap Long Nose CP Pair / na	HKC20 COMPLETE HEADWORK COLD	850868	5013866062797	01/01/1900	current

3

Pattern / Size	Description	Code	Barcode	Date From	Date To
Basin Pillar Tap Long Nose CP Pair / na	1/2 BN 915L BACKNUT	817074	5013866023385	01/01/1900	current

4

Pattern / Size	Description	Code	Barcode	Date From	Date To
Basin Pillar Tap Long Nose CP Pair / na	ARW2 1/2 ANTI ROTATIONAL WASHER	814162	5013866056758	01/01/1900	current

5 not shown

Pattern / Size	Description	Code	Barcode	Date From	Date To
Basin Pillar Tap Long Nose CP Pair / na	SK5 SEAL KIT	850860	5013866062711	01/01/1900	current

CARE & MAINTENANCE

Care

To maintain the surface finish, simply wipe occasionally with a mild detergent on a soft damp cloth. Dry, using a soft cloth. Never use abrasive cleaners or chemical household cleaners and avoid contact with concentrated bleach.

Maintenance

No regular maintenance is required for this product.

In case of complete replacement Pegler recommend service valves should be fitted to the supply inlets.

For any further help or replacement parts please contact the Service Support Team on 0800 1560050.

GUARANTEE

Luxury Taps and Mixers

Pegler Yorkshire Customcare 5 Year Guarantee - Terms and Conditions

Product are subject to a 5 year guarantee that is between Pegler Yorkshire and the final purchaser of the product.

The guarantee is subject to proof of purchase being supplied.

This guarantee does not affect any statutory rights the consumer may have in law.

The guarantee covers manufacturing or material defects and does not cover parts subject to normal wear and tear.

Finishes other than chrome are covered for a period of 3 years only and the guarantee on the finish is subject to the cleaning instructions being followed.

The guarantee is not applicable where the product is fitted contrary to the conditions in the fitting instructions.

Abusive behaviour and accidental damage to the product are not covered by this guarantee.

The extent of this liability is limited to the cost of the replacement of the defective item and not to fitting or consequential damages.



[Performa Healthcare](#)
[360109 & 360123](#)