



1029 Bronze Globe Valve

Bronze globe valve BS 5154 PN32 Series B/NM, non metallic renewable disk

GENERAL INFORMATION

Pattern No. key :Standard Thread = BS21 Taper, AT = American Thread, PT = Parallel Thread

Size	Pattern No.	Pack 1 Qty	Code	Barcode	Discontinued
1/4	1029	1	110005	5013866013072	
3/8	1029	1	110006	5013866013089	
1/2	1029	10	110007	5013866013096	
3/4	1029	5	110008	5013866013102	
1	1029	5	110009	5013866013119	
1 1/4	1029	2	110010	5013866013126	
1 1/2	1029	2	110011	5013866013133	
2	1029	1	110012	5013866001482	
2 1/2	1029	0	110013	5022050287717	12/01/2007
3	1029	0	110014	5022050318312	12/01/2007
4	1029	1	110015	5013866001512	31/10/2004
1/4	1029 AT	1	110025	5022050227317	21/07/2006
3/8	1029 AT	1	110026	5022050227409	21/07/2006
1/2	1029 AT	10	110027	5022050227454	
3/4	1029 AT	5	110028	5022050232809	
1	1029 AT	5	110029	5022050227560	
1 1/4	1029 AT	2	110030	5022050227676	
1 1/2	1029 AT	2	110031	5022050227775	
2	1029 AT	1	110032	5022050227874	
1/4	1029 PT	1	110045	5022050227935	21/07/2006
3/8	1029 PT	1	110046	5022050227980	21/07/2006
1/2	1029 PT	10	110047	5013866013164	
3/4	1029 PT	5	110048	5013866013171	
1	1029 PT	5	110049	5013866013188	
1 1/4	1029 PT	2	110050	5013866013195	
1 1/2	1029 PT	2	110051	5013866013201	
2	1029 PT	1	110052	5013866001598	

DIMENSIONS (mm)

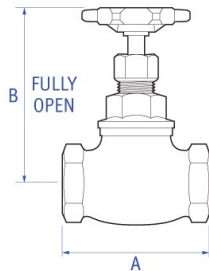

Code	Description	A	B	Kg
110005	1/4 1029 RD GM GLOBE VALVE	48	76	0.20
110006	3/8 1029 RD GM GLOBE VALVE	46	76	0.22
110007	1/2 1029 RD GM GLOBE VALVE	57	95	0.38
110008	3/4 1029 RD GM GLOBE VALVE	65	98	0.54
110009	1 1029 RD GM GLOBE VALVE	78	114	0.84
110010	1.1/4 1029 RD GM GLOBE VALVE	89	138	1.36
110011	1.1/2 1029 RD GM GLOBE VALVE	100	159	1.76
110012	2 1029 RD GM GLOBE VALVE	121	170	2.62
110013	2.1/2 1029 RD GM GLOBE VALVE	171	220	155
110014	3 1029 RD GM GLOBE VALVE	205	225	180
110015	4 1029 RD GM GLOBE VALVE	238	290	230
110025	1/4 1029 AT RD GM GLOBE VALVE	44	76	60
110026	3/8 1029 AT RD GM GLOBE VALVE	46	76	60
110027	1/2 1029 AT RD GM GLOBE VALVE	57	95	0.38
110028	3/4 1029 AT RD GM GLOBE VALVE	65	98	0.54
110029	1 1029 AT RD GM GLOBE VALVE	78	114	0.84
110030	1.1/4 1029 AT RD GM GLOBE VALVE	89	138	1.36
110031	1.1/2 1029 AT RD GM GLOBE VALVE	100	159	1.76
110032	2 1029 AT RD GM GLOBE VALVE	121	170	2.62
110045	1/4 1029 PT RD GM GLOBE VALVE	44	76	60
110046	3/8 1029 PT RD GM GLOBE VALVE	46	76	60
110047	1/2 1029 PT RD GM GLOBE VALVE	57	95	0.38
110048	3/4 1029 PT RD GM GLOBE VALVE	65	98	0.54
110049	1 1029 PT RD GM GLOBE VALVE	78	114	0.84
110050	1.1/4 1029 PT RD GM GLOBE VALVE	89	138	1.36
110051	1.1/2 1029 PT RD GM GLOBE VALVE	100	159	1.76
110052	2 1029 PT RD GM GLOBE VALVE	121	170	2.62

PRESSURE & TEMPERATURE

1029 Bronze Globe Valve	Minimum Operating Pressure (bar)	Maximum Cold Working Pressure (bar)	Maximum Hot Working Pressure (bar)
1.1/4 1029 PT RD GM GLOBE VALVE	No Minimum Operating Pressure	32.0 bar at temperatures up to 100oC	14.0 bar at temperatures up to 198oC

MATERIAL SPECIFICATIONS

Number	Component	Material
1	Body	Gunmetal
2	Bonnet	Forged Brass
3	Stem	Brass Bar
4	Disk Holder	Brass Bar
5	Disk Ring	Brass Bar
6	Disk	Glass Filled PTFE
7	Disk Nut	Brass Bar
8	Gland	Brass Bar
9	Gland Nut	Brass Bar
10	Packing	PTFE
11	Handwheel	Aluminium
12	Handwheel Nut	Brass Bar
13	Rating Disc	Aluminium

SPARES

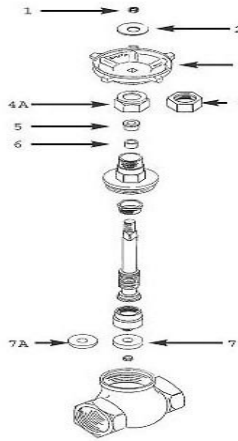

1					
Pattern / Size	Description	Code	Barcode	Date From	Date To
1029 / 1/4	WN1 HANDWHEEL NUT BRASS (M5)	850481	5013866060977	01/01/1900	current
1029 / 3/8	WN1 HANDWHEEL NUT BRASS (M5)	850481	5013866060977	01/01/1900	current
1029 / 1/2	WN2 HANDWHEEL NUT BRASS (M6)	850482	5013866060984	01/01/1900	current
1029 / 3/4	WN2 HANDWHEEL NUT BRASS (M6)	850482	5013866060984	01/01/1900	current
1029 / 1	WN2 HANDWHEEL NUT BRASS (M6)	850482	5013866060984	01/01/1900	current
1029 / 1.1/4	WN2 HANDWHEEL NUT BRASS (M6)	850482	5013866060984	01/01/1900	current
1029 / 1.1/2	CT3 CONNECTING TUBES (2 OFF) - DISCONTINUED	850842	5013866062650	01/01/1900	11/02/2013
1029 / 2	WN14 HANDWHEEL NUT BRASS (M8)	850512	5013866061141	01/09/1999	current
1029 / 2	WN3 HANDWHEEL NUT BRASS (5/16 UNC)	851411	5013866063923	01/01/1990	31/08/1999
1029 / 2.1/2	WN4 HANDWHEEL NUT BRASS (3/8 UNC)	851412	5013866063930	01/01/1900	current
1029 / 3	WN5 HANDWHEEL NUT BRASS (7/16 UNC)	850483	5013866060991	01/01/1900	current
1029 / 4	WN6 HANDWHEEL NUT BRASS (1/2 UNC)	850484	5013866061004	01/01/1900	current
1029 PT / 1/4	WN1 HANDWHEEL NUT BRASS (M5)	850481	5013866060977	01/01/1900	current
1029 PT / 3/8	WN1 HANDWHEEL NUT BRASS (M5)	850481	5013866060977	01/01/1900	current
1029 PT / 1/2	WN2 HANDWHEEL NUT BRASS (M6)	850482	5013866060984	01/01/1900	current
1029 PT / 3/4	WN2 HANDWHEEL NUT BRASS (M6)	850482	5013866060984	01/01/1900	current
1029 PT / 1	WN2 HANDWHEEL NUT BRASS (M6)	850482	5013866060984	01/01/1900	current
1029 PT / 1.1/4	WN2 HANDWHEEL NUT BRASS (M6)	850482	5013866060984	01/01/1900	current
1029 PT / 1.1/2	CT3 CONNECTING TUBES (2 OFF) - DISCONTINUED	850842	5013866062650	01/01/1900	11/02/2013
1029 PT / 2	WN3 HANDWHEEL NUT BRASS (5/16 UNC)	851411	5013866063923	01/01/1990	31/08/1999
1029 PT / 2	WN14 HANDWHEEL NUT BRASS (M8)	850512	5013866061141	01/09/1999	current

2					
Pattern / Size	Description	Code	Barcode	Date From	Date To
1029 / 1/4	RATING DISC 1029 - SIZE 1	850456	5013866060779	01/01/1900	current
1029 / 3/8	RATING DISC 1029 - SIZE 1	850456	5013866060779	01/01/1900	current
1029 / 1/2	RATING DISC 1029 - SIZE 1	850456	5013866060779	01/01/1900	current
1029 / 3/4	RATING DISC 1029 - SIZE 1	850456	5013866060779	01/01/1900	current
1029 / 1	RATING DISC 1029 - SIZE 1	850456	5013866060779	01/01/1900	current
1029 / 1.1/4	RATING DISC 1029 - SIZE 1	850456	5013866060779	01/01/1900	current
1029 / 1.1/2	RATING DISC 1029 - SIZE 1	850456	5013866060779	01/01/1900	current
1029 / 2	RATING DISC 1029 - SIZE 2	850457	5013866060786	01/01/1900	current
1029 / 2.1/2	RATING DISC 1029 - SIZE 3	850260	5013866059803	01/01/1900	current
1029 / 3	RATING DISC 1029 - SIZE 3	850260	5013866059803	01/01/1900	current
1029 / 4	RATING DISC 1029 - SIZE 3	850260	5013866059803	01/01/1900	current
1029 PT / 1/4	RATING DISC 1029 - SIZE 1	850456	5013866060779	01/01/1900	current
1029 PT / 3/8	RATING DISC 1029 - SIZE 1	850456	5013866060779	01/01/1900	current
1029 PT / 1/2	RATING DISC 1029 - SIZE 1	850456	5013866060779	01/01/1900	current
1029 PT / 3/4	RATING DISC 1029 - SIZE 1	850456	5013866060779	01/01/1900	current
1029 PT / 1	RATING DISC 1029 - SIZE 1	850456	5013866060779	01/01/1900	current
1029 PT / 1.1/4	RATING DISC 1029 - SIZE 1	850456	5013866060779	01/01/1900	current
1029 PT / 1.1/2	RATING DISC 1029 - SIZE 1	850456	5013866060779	01/01/1900	current
1029 PT / 2	RATING DISC 1029 - SIZE 2	850457	5013866060786	01/01/1900	current

3					
Pattern / Size	Description	Code	Barcode	Date From	Date To
1029 / 1/4	W1 HANDWHEEL (RED)	850100	5013866059513	01/01/1900	current
1029 / 3/8	W1 HANDWHEEL (RED)	850100	5013866059513	01/01/1900	current
1029 / 1/2	W3 HANDWHEEL (RED)	850101	5013866059520	01/05/2000	current
1029 / 1/2	W4 HANDWHEEL (RED)	850102	5013866059537	01/01/1990	30/04/2000
1029 / 3/4	W4 HANDWHEEL (RED)	850102	5013866059537	01/01/1990	30/04/2000
1029 / 3/4	W3 HANDWHEEL (RED)	850101	5013866059520	01/05/2000	current
1029 / 1	W5 HANDWHEEL (RED)	850103	5013866059544	01/01/1900	current
1029 / 1.1/4	W6 HANDWHEEL (RED)	850104	5013866059551	01/01/1900	current
1029 / 1.1/2	W7 HANDWHEEL (RED)	850105	5013866059568	01/01/1900	current
1029 / 2	W8 HANDWHEEL (RED)	850106	5013866059575	01/01/1900	current
1029 / 2.1/2	W10 HANDWHEEL (RED)	850107	5013866059582	01/01/1900	current
1029 / 3	W12 HANDWHEEL (RED)	850108	5013866059599	01/01/1900	current
1029 / 4	W14 HANDWHEEL (RED)	850109	5013866059605	01/01/1900	current
1029 PT / 1/4	W1 HANDWHEEL (RED)	850100	5013866059513	01/01/1900	current
1029 PT / 3/8	W1 HANDWHEEL (RED)	850100	5013866059513	01/01/1900	current
1029 PT / 1/2	W3 HANDWHEEL (RED)	850101	5013866059520	01/05/2000	current
1029 PT / 1/2	W4 HANDWHEEL (RED)	850102	5013866059537	01/01/1990	30/04/2000
1029 PT / 3/4	W3 HANDWHEEL (RED)	850101	5013866059520	01/05/2000	current
1029 PT / 3/4	W4 HANDWHEEL (RED)	850102	5013866059537	01/01/1990	30/04/2000
1029 PT / 1	W5 HANDWHEEL (RED)	850103	5013866059544	01/01/1900	current
1029 PT / 1.1/4	W6 HANDWHEEL (RED)	850104	5013866059551	01/01/1900	current
1029 PT / 1.1/2	W7 HANDWHEEL (RED)	850105	5013866059568	01/01/1900	current
1029 PT / 2	W8 HANDWHEEL (RED)	850106	5013866059575	01/01/1900	current

4					
Pattern / Size	Description	Code	Barcode	Date From	Date To
1029 / 1/4	GN1 GLAND NUT	850310	5013866059889	01/01/1990	30/04/2000
1029 / 3/8	GN1 GLAND NUT	850310	5013866059889	01/01/1990	30/04/2000
1029 / 1/2	GN3 GLAND NUT	842046	5013866059117	01/01/1990	30/04/2000
1029 / 3/4	GN3 GLAND NUT	842046	5013866059117	01/01/1990	30/04/2000
1029 / 1	GN4 GLAND NUT	842048	5013866059124	01/01/1990	30/04/2000
1029 / 1.1/4	GN5 GLAND NUT	850311	5013866059896	01/01/1990	30/04/2000
1029 / 1.1/2	GN6 GLAND NUT	851070	5013866063879	01/01/1990	30/04/2000
1029 / 2	GN7 GLAND NUT	851205	5013866063909	01/01/1990	30/04/2000
1029 / 2.1/2	GN24 GLAND NUT	852907	5013866063985	01/01/1990	current
1029 / 3	GN24 GLAND NUT	852907	5013866063985	01/01/1990	current
1029 / 4	GN16 GLAND NUT	850318	5013866059957	01/01/1990	current
1029 PT / 1/4	GN1 GLAND NUT	850310	5013866059889	01/01/1990	30/04/2000
1029 PT / 3/8	GN1 GLAND NUT	850310	5013866059889	01/01/1990	30/04/2000
1029 PT / 1/2	GN3 GLAND NUT	842046	5013866059117	01/01/1990	30/04/2000
1029 PT / 3/4	GN3 GLAND NUT	842046	5013866059117	01/01/1990	30/04/2000
1029 PT / 1	GN4 GLAND NUT	842048	5013866059124	01/01/1990	30/04/2000
1029 PT / 1.1/4	GN5 GLAND NUT	850311	5013866059896	01/01/1990	30/04/2000
1029 PT / 1.1/2	GN6 GLAND NUT	851070	5013866063879	01/01/1990	30/04/2000
1029 PT / 2	GN7 GLAND NUT	851205	5013866063909	01/01/1990	30/04/2000

4A					
Pattern / Size	Description	Code	Barcode	Date From	Date To
1029 / 1/4	GN62 GLAND NUT (CHAMFERED)	850790	5013866062292	01/05/2000	current
1029 / 3/8	GN62 GLAND NUT (CHAMFERED)	850790	5013866062292	01/05/2000	current
1029 / 1/2	GN8 GLAND NUT	850312	5013866059902	01/05/2000	current
1029 / 3/4	GN8 GLAND NUT	850312	5013866059902	01/05/2000	current
1029 / 1	GN63 GLAND NUT (CHAMFERED)	850791	5013866062308	01/05/2000	current
1029 / 1.1/4	GN64 GLAND NUT (CHAMFERED)	850792	5013866062315	01/05/2000	current
1029 / 1.1/2	GN65 GLAND NUT (CHAMFERED)	850793	5013866062322	01/05/2000	current
1029 / 2	GN66 GLAND NUT (CHAMFERED)	850794	5013866062339	01/05/2000	current
1029 PT / 1/4	GN62 GLAND NUT (CHAMFERED)	850790	5013866062292	01/05/2000	current
1029 PT / 3/8	GN62 GLAND NUT (CHAMFERED)	850790	5013866062292	01/05/2000	current
1029 PT / 1/2	GN8 GLAND NUT	850312	5013866059902	01/05/2000	current
1029 PT / 3/4	GN8 GLAND NUT	850312	5013866059902	01/05/2000	current
1029 PT / 1	GN63 GLAND NUT (CHAMFERED)	850791	5013866062308	01/05/2000	current
1029 PT / 1.1/4	GN64 GLAND NUT (CHAMFERED)	850792	5013866062315	01/05/2000	current
1029 PT / 1.1/2	GN65 GLAND NUT (CHAMFERED)	850793	5013866062322	01/05/2000	current
1029 PT / 2	GN66 GLAND NUT (CHAMFERED)	850794	5013866062339	01/05/2000	current

5					
Pattern / Size	Description	Code	Barcode	Date From	Date To
1029 / 1/4	G1 GLAND	855236	5013866065163	01/01/1900	current
1029 / 3/8	G1 GLAND	855236	5013866065163	01/01/1900	current
1029 / 1/2	G3 GLAND	842043	5013866059094	01/01/1900	current
1029 / 3/4	G3 GLAND	842043	5013866059094	01/01/1900	current
1029 / 1	G4 GLAND	842045	5013866059100	01/01/1900	current
1029 / 1.1/4	G5 GLAND	850301	5013866059827	01/01/1900	current
1029 / 1.1/2	G6 GLAND	850302	5013866059834	01/01/1900	current
1029 / 2	G7 GLAND	850303	5013866059841	01/01/1900	current
1029 / 2.1/2	G14 GLAND	852160	5013866063961	01/01/1900	current
1029 / 3	G14 GLAND	852160	5013866063961	01/01/1900	current
1029 / 4	G9 GLAND	850306	5013866059858	01/01/1900	current
1029 PT / 1/4	G1 GLAND	855236	5013866065163	01/01/1900	current
1029 PT / 3/8	G1 GLAND	855236	5013866065163	01/01/1900	current
1029 PT / 1/2	G3 GLAND	842043	5013866059094	01/01/1900	current
1029 PT / 3/4	G3 GLAND	842043	5013866059094	01/01/1900	current
1029 PT / 1	G4 GLAND	842045	5013866059100	01/01/1900	current
1029 PT / 1.1/4	G5 GLAND	850301	5013866059827	01/01/1900	current
1029 PT / 1.1/2	G6 GLAND	850302	5013866059834	01/01/1900	current
1029 PT / 2	G7 GLAND	850303	5013866059841	01/01/1900	current

6					
Pattern / Size	Description	Code	Barcode	Date From	Date To
1029 / 1/4	GP2 GLAND PACKING	855248	5013866065217	01/01/1900	current
1029 / 3/8	GP2 GLAND PACKING	855248	5013866065217	01/01/1900	current
1029 / 1/2	GP3 GLAND PACKING	842040	5013866059070	01/01/1900	current
1029 / 3/4	GP3 GLAND PACKING	842040	5013866059070	01/01/1900	current
1029 / 1	GP4 GLAND PACKING	842042	5013866059087	01/01/1900	current
1029 / 1.1/4	GP5 GLAND PACKING	850006	5013866059292	01/01/1900	current
1029 / 1.1/2	GP6 GLAND PACKING	850079	5013866059506	01/01/1900	current
1029 / 2	GP7 GLAND PACKING	855252	5013866065231	01/01/1900	current
1029 / 2.1/2	GP24 GLAND PACKING	852950	5013866064029	01/01/1900	current
1029 / 3	GP25 GLAND PACKING - DISCONTINUED	852953	5013866064036	01/01/1900	current
1029 / 4	GP15 GLAND PACKING	850330	5013866060052	01/01/1900	current
1029 PT / 1/4	GP2 GLAND PACKING	855248	5013866065217	01/01/1900	current
1029 PT / 3/8	GP2 GLAND PACKING	855248	5013866065217	01/01/1900	current
1029 PT / 1/2	GP3 GLAND PACKING	842040	5013866059070	01/01/1900	current
1029 PT / 3/4	GP3 GLAND PACKING	842040	5013866059070	01/01/1900	current
1029 PT / 1	GP4 GLAND PACKING	842042	5013866059087	01/01/1900	current
1029 PT / 1.1/4	GP5 GLAND PACKING	850006	5013866059292	01/01/1900	current
1029 PT / 1.1/2	GP6 GLAND PACKING	850079	5013866059506	01/01/1900	current
1029 PT / 2	GP7 GLAND PACKING	855252	5013866065231	01/01/1900	current

7					
Pattern / Size	Description	Code	Barcode	Date From	Date To
1029 / 1/4	RD1 RENEWABLE DISK (PTFE) - DISCONTINUED	850180	5013866059704	01/01/1900	23/12/2009
1029 / 3/8	RD1 RENEWABLE DISK (PTFE) - DISCONTINUED	850180	5013866059704	01/01/1900	23/12/2009
1029 / 1/2	RD2 RENEWABLE DISK (PTFE) - DISCONTINUED	850181	5013866059711	01/01/1900	23/12/2009
1029 / 3/4	RD2 RENEWABLE DISK (PTFE) - DISCONTINUED	850181	5013866059711	01/01/1900	23/12/2009
1029 / 1	RD4 RENEWABLE DISK (PTFE) - DISCONTINUED	850183	5013866059735	01/01/1900	23/12/2009
1029 / 1.1/4	RD5 RENEWABLE DISK (PTFE) - DISCONTINUED	850184	5013866059742	01/01/1900	23/12/2009
1029 / 1.1/2	RD6 RENEWABLE DISK (PTFE) - DISCONTINUED	850185	5013866059759	01/01/1900	23/12/2009
1029 / 2	RD7 RENEWABLE DISK (PTFE) - DISCONTINUED	850186	5013866059766	01/01/1900	23/12/2009
1029 / 2.1/2	RD8 RENEWABLE DISK (PTFE) - DISCONTINUED	850187	5013866059773	01/01/1900	23/12/2009
1029 / 3	RD9 RENEWABLE DISK (PTFE) - DISCONTINUED	850188	5013866059780	01/01/1900	23/12/2009
1029 / 4	RD10 RENEWABLE DISK (PTFE) - DISCONTINUED	850189	5013866059797	01/01/1900	23/12/2009
1029 PT / 1/4	RD1 RENEWABLE DISK (PTFE) - DISCONTINUED	850180	5013866059704	01/01/1900	23/12/2009
1029 PT / 3/8	RD1 RENEWABLE DISK (PTFE) - DISCONTINUED	850180	5013866059704	01/01/1900	23/12/2009
1029 PT / 1/2	RD2 RENEWABLE DISK (PTFE) - DISCONTINUED	850181	5013866059711	01/01/1900	23/12/2009
1029 PT / 3/4	RD2 RENEWABLE DISK (PTFE) - DISCONTINUED	850181	5013866059711	01/01/1900	23/12/2009
1029 PT / 1	RD4 RENEWABLE DISK (PTFE) - DISCONTINUED	850183	5013866059735	01/01/1900	23/12/2009
1029 PT / 1.1/4	RD5 RENEWABLE DISK (PTFE) - DISCONTINUED	850184	5013866059742	01/01/1900	23/12/2009
1029 PT / 1.1/2	RD6 RENEWABLE DISK (PTFE) - DISCONTINUED	850185	5013866059759	01/01/1900	23/12/2009
1029 PT / 2	RD7 RENEWABLE DISK (PTFE) - DISCONTINUED	850186	5013866059766	01/01/1900	23/12/2009

7A					
Pattern / Size	Description	Code	Barcode	Date From	Date To
1029 / 1/4	RD85 RENEWABLE DISK (PTFE DOME STYLE)	850787	5013866062261	01/05/2000	current
1029 / 3/8	RD85 RENEWABLE DISK (PTFE DOME STYLE)	850787	5013866062261	01/05/2000	current
1029 / 1/2	RD88 RENEWABLE DISK (PTFE DOME STYLE)	850806	5013866062384	01/05/2000	current
1029 / 3/4	RD88 RENEWABLE DISK (PTFE DOME STYLE)	850806	5013866062384	01/05/2000	current
1029 / 1	RD90 RENEWABLE DISK (PTFE DOME STYLE)	850808	5013866062407	01/05/2000	current
1029 / 1.1/4	RD91 RENEWABLE DISK (PTFE DOME STYLE)	850809	5013866062414	01/05/2000	current
1029 / 1.1/2	RD86 RENEWABLE DISK (PTFE DOME STYLE)	850788	5013866062278	01/05/2000	current
1029 / 2	RD87 RENEWABLE DISK (PTFE DOME STYLE)	850789	5013866062285	01/05/2000	current
1029 PT / 1/4	RD85 RENEWABLE DISK (PTFE DOME STYLE)	850787	5013866062261	01/05/2000	current
1029 PT / 3/8	RD85 RENEWABLE DISK (PTFE DOME STYLE)	850787	5013866062261	01/05/2000	current
1029 PT / 1/2	RD88 RENEWABLE DISK (PTFE DOME STYLE)	850806	5013866062384	01/05/2000	current
1029 PT / 3/4	RD88 RENEWABLE DISK (PTFE DOME STYLE)	850806	5013866062384	01/05/2000	current
1029 PT / 1	RD90 RENEWABLE DISK (PTFE DOME STYLE)	850808	5013866062407	01/05/2000	current
1029 PT / 1.1/4	RD91 RENEWABLE DISK (PTFE DOME STYLE)	850809	5013866062414	01/05/2000	current
1029 PT / 1.1/2	RD86 RENEWABLE DISK (PTFE DOME STYLE)	850788	5013866062278	01/05/2000	current
1029 PT / 2	RD87 RENEWABLE DISK (PTFE DOME STYLE)	850789	5013866062285	01/05/2000	current

CARE & MAINTENANCE

Care

No regular aesthetic care is required for this product

Maintenance

A regular maintenance program is the most efficient method of ensuring longer term operational efficiency of the selected valve. Such a program would need to include a risk assessment and a planned procedure of how the maintenance will be carried out. The possibility of operational limits being exceeded and the potential hazards ensuring must be considered as part of this assessment. This should be implemented to include visual checks on the valve's condition and any development of unforeseen conditions, which could lead to failure. The correct fitting tools and equipment should be used for valve maintenance work. Separate means of draining the pipe work must be provided when carrying out any maintenance to valves. Where there may be any system debris this could be collected and /or filtered by installation of the appropriate protective device.

For further help please contact your local engineer.

If your product is under warranty please contact the Service Support Team on: 0800 1560050

REGULATIONS

Regulations

THE PRESSURE EQUIPMENT DIRECTIVE 97/23/EC and CE MARKING

The Pressure Equipment Regulations 1999 (SI 1999/2001) have now been introduced into United Kingdom law.

Valves with a maximum allowable pressure greater than 0.5 bar are covered by these new Regulations. Valves are categorised according to their maximum working pressure, size and rising level of hazard. The level of hazard varies according to the fluid being carried. Fluids are classified as Group 1, dangerous fluids or Group 2, all other fluids including steam. The Categories designated are SEP (sound engineering practice). Valves up to and including 25mm (1") are designated SEP regardless of the fluid group. Those identified as having increased hazard are Categorised as, I, II, III or IV. All valves designated as SEP do not bear the CE mark nor require a Declaration of Conformity. Categories I, II, III or IV carry the CE mark and require a Declaration of Conformity. Valves classified from the piping chart would not be included in Category IV.

GUARANTEE

Valves and Fittings

Pegler Yorkshire Customcare 5 Year Guarantee - Terms and Conditions

Products are subject to a 5 year guarantee that is between Pegler Yorkshire and the final purchaser of the product.

The guarantee is subject to proof of purchase being supplied.

This guarantee does not affect any statutory rights the consumer may have in law.

The guarantee covers manufacturing or material defects and does not cover parts subject to normal wear and tear.

This product range has been designed for the use of homeowners, domestic and commercial applications and therefore the guarantee is subject to the product being properly selected for their intended service conditions.

The guarantee is not applicable where the product is fitted contrary to the conditions in the fitting instructions.

This is reinforced where valves are covered by the European Pressure Equipment Directive (PED97/23/EC) where Installation, Operating and Maintenance Instructions are supplied with each product and/or carton.

Provided it is installed correctly and receives adequate preventative maintenance it should give years of trouble – free service.

Abusive behaviour and accidental damage to the product are not covered by this guarantee.

The extent of this liability is limited to the cost of the replacement of the defective item and not to fitting or consequential damages.

Product Data Sheet: Valves Package THE PRESSURE EQUIPMENT DIRECTIVE 97/23/EC & CE MARKING

The Pressure Equipment Regulations 1999 (SI 1999/2001) have now been introduced into United Kingdom law. Valves within a maximum allowable pressure greater than 0.5 bar are covered by these new Regulations. Valves are categorised according to their maximum working pressure, size and rating level of hazard. The level of hazard varies according to the fluid being carried. Fluids are classified as Group 1 (dangerous fluids or Group 2, all other fluids including steam). The categories designated are SEP (sound engineering practice). Valves up to and including 250mm (1") are designated SEP (regardless of the fluid group). Those identified as having increased hazard are categorised as I, II, III or IV. All valves designated as SEP do not bear the CE mark, nor require a Declaration of Conformity. Categories I, II, III or IV carry the CE mark and require a Declaration of Conformity. Valves classified from the piping chart would not be included in Category IV.

CE MARKING & THE ATEX Directive 94/9/EC

Concerning equipment and protection systems intended for use in potentially explosive atmospheres. This has been implemented in United Kingdom law by the Equipment and Protective Systems Intended for Use in Potentially Explosive Atmosphere Regulations 1996/31 1996/192 and amended by The Equipment and Protective Systems (Amendment) Regulations 2001 (SI2001/3766). The regulations apply to all valves where each valve: a) has its own potential source of ignition; b) operates in a potentially explosive atmosphere created by:

- the presence of gases, vapours, mists released from the valve through leakage;
- the presence of gases, vapours, mists released from the valve through leakage.

The regulations will not apply to a valve without a potential source of ignition, which operates in a dust free environment and the fluid being transported is cold, inert gas or non-flammable liquid. The requisite level of protection for valves not exempt from the regulations is defined as Group II category 2 and shall bear the following markings: (Ex) II GEP X

VALVE SELECTION Selection, Storage & Protection

Valves must be properly selected for their intended service conditions. Provided it is installed correctly and receives adequate preventative maintenance it should give years of trouble-free service. They must be compatible with the system design, pressure and temperature requirements and must be suitable for the fluids that they are intended to carry. Interactions between parts in the pipe system and the valve must be considered as part of the valve selection.

Valves should be stored off the ground in a clean, dry, indoor area.

Where desiccant bags are included with the valve these should be changed after a period of 6 months.

Pegler valves are supplied in cardboard cartons or are bagged as appropriate and so adequate protection from damage is provided. When Pegler valves are fitted with pressure equipment or assemblies, suitable protective devices may be required.

PRESSURE/TEMPERATURE RATING

Valves must be installed in a piping system whose normal pressure and temperature does not exceed the stated rating of the valve. The maximum allowable pressure in valves as specified in the standards is for non-stopcock conditions. Water hammer and impact standards should also be avoided.

If system testing will subject the valve to pressures in excess of the working pressure, rating, this should be within the "shell test pressure" for the body, to a maximum of 1.5 times the PN rating and concluded with the valve fully opened. It may be hazardous to use these valves outside of their specified pressure and temperature limitations and also when not for the correct application.

LOCATION/END-OF-LINE SERVICE

To ensure ease of operation, adjustment, maintenance and repair, valve siting should be decided during the system design phase. To prevent imposing strain on the valve seat, pipe work and valves they must be adequately supported. The 1022, 1070/125, 1065 and 1068 Gate valves are suitable for end of line service but we strongly recommend the fitting of a blanking plug to the downstream end of the valve. Pegler Ball, Globe, Check, Flanged and Lever Gate valves are not suitable for end-of-line service.

INSTALLATION Health & Safety

Before starting work on any installation a risk assessment must be made to consider the possibility of operational limits being exceeded and reduction or elimination of any potential hazards. 1. Protective clothing and safety equipment must be utilised as appropriate to the hazard presented by the nature of the process to which the valve is being installed or maintained.

- Before installing or removing a valve the pipeline circulating pumps (when fitted) must be turned off. The pipeline must be de-pressurised, drained and vented. Valves must be fully opened to ensure release of any pipeline or valve pressure.
- Fitters must be trained in manual and mechanical handling to ensure release of any pipeline or valve pressure.
- Fitters must be trained in manual and mechanical handling to enable them to safely lift and install Pegler valves.
- The valve selected must be suitable for the required service conditions. The pressure and temperature limitations are indicated on the valve nomenclature, body or data plate. These must not be exceeded.
- Valve seats, seals and internal components can be damaged by system debris. Protective devices may need to be fitted and

system flushing may be required.

Any flushing fluid used to clean the pipeline must not cause any damage to the valve and its components.

7. Pegler valves must not be misused by fitting them by their hand wheels, levers or stems.

8. Pegler valves are not suitable for fatigue loading, creep conditions, fire testing, fire hazard environment, corrosive or erosive service, or for carrying fluids containing abrasive solids. There is no allowance for corrosion in the design of these valves. Designs for this valve do not allow for decomposition of unstable fluids and must not be used where this could occur.

9. Pegler valves are not designed to withstand the effects of fire, wind, earthquakes and traffic.

10. All Health and Safety Rules must be followed when installing and maintaining valves.

INSTALLATION

Unpack the valve and check that the flow paths and valve threads are clean and free from debris.

Check the body markings and nomenclature to ensure that the correct valve has been selected for installation.

Gate valves and globe valves may be fixed in "vertical pipe work with stem horizontal" or "horizontal pipe work with stem vertical and upright". Globe valves are marked with a directional flow arrow on the body. The valve will function correctly providing it is fitted so that the fluid transported follows the indicated flow direction. Make sure that a gate valve is fully closed during installation. Fitting a gate valve in the open position may cause twisting and the gate and seating may not mate properly. The valve should be operated from fully open to fully closed to test that it has been correctly installed.

The valve should not be installed in horizontal pipe work with stem horizontal because full closure may be hindered by an accumulation of system debris. Pegler Valves are manufactured to exacting standards and, therefore, should not be subjected to misuse. The following should be avoided: **Caress handling** (Valves should not be lifted using the hand wheel, lever or the stem). **Dirt and debris** entering the valve through the end ports. **Excessive force** during assembly and hand wheel operation.

Ball valves may be fixed in any orientation, always leaving enough space for the 90° operation of the lever handle.

Horizontal and Vertical pattern check valves may be fitted in horizontal pipe work with the cap uppermost and vertically with the flow in an upwards direction. The valve is marked with a directional flow arrow on the body. The valve will function correctly providing it is fitted so that the fluid transported follows the indicated flow direction. Check valves having 6 diameters of straight length of pipe upstream and 3 diameters downstream are suitable for velocities of 3 metres per second. If the valve is situated such that

non uniform or pulsating flow enters the valve, e.g. the valve is close to reciprocating pumps, then the velocity should not exceed 2 metres per second. Use suitable hangers close to both ends of the valve in order to remove stresses transmitted by the pipe. Confirm that the pipe threading length is correct to avoid excessive penetration of the pipe into the valve that would otherwise cause pipe only and not in the valve threads. Surplus compound will then be forced outwards and will not enter the valve. Over use of compound can lead to valve failure on the body ends. Threads should be engaged correctly when tightening the valve onto the pipe. The wrench should always be fitted on the body end adjacent to the joint being made. Severe damage can occur to stems, valves and seats by the use of hand tools or levers larger than those originally supplied by the manufacturer, and by wheelkeys.

Any electrical component e.g. actuators, limit switches must be explosion proof and comply with the ATEX Directive and Standards as listed in BS EN 1127-1 Clauses 6, 4.5.

OPERATION

To open - an anti-clockwise rotation of the hand wheel will open the valve. When it will go no further return the hand wheel clockwise 1/2 turn. To close the valve a clockwise rotation of the hand wheel will close the valve. Closure will be confirmed when the handle can be turned no further.

Caution: Service applications with extremes of temperature may cause the wedges to become tight in the valve. The valve may be become stiff to operate in these circumstances. Suitable hand protection should be worn when operating valves used in extreme temperature applications. The valve should only be used in the fully open or fully closed position. Gate valves are not suitable for regulating and throttling service.

Globe Valves

To open - an anti-clockwise rotation of the hand wheel will open the valve. When it will go no further return the hand wheel clockwise 1/2 turn. To close the valve a clockwise rotation of the hand wheel will close the valve. Closure will be confirmed when the handle can be turned no further.

Caution: Service applications with extremes of temperature may cause the wedges to become tight in the valve. The valve may be become stiff to operate in these circumstances. Suitable hand protection should be worn when operating valves used in extreme temperature applications. The valve should only be used in the fully open or fully closed position. Ball valves are not suitable for regulating and throttling service.

Globe Valves

To open - an anti-clockwise rotation of the hand wheel will open the valve. When it will go no further return the hand wheel clockwise 1/2 turn. To close the valve a clockwise rotation of the hand wheel will close the valve. Closure will be confirmed when the handle can be turned no further.

Caution: Suitable hand protection should be worn when operating valves used in extreme temperature applications. Globe valves are suitable for regulating and throttling service.

Check Valves

The Horizontal/vertical pattern check valves operate according to the flow within the pipeline and there is no external method of operation.

Ball Valves

PB LEVER HANDLE To open - turn the lever 90° so that it is in line with the pipe run in which it is installed. To close - turn the lever 90° so that it is across the line of the pipe in which it is installed. Full closure and closing is completed when a full 90° is achieved and the lever is firmly set against the stop on the valve body. Confirm that the pipe threading length is correct to avoid excessive penetration of the pipe into the valve that would otherwise cause pipe only and not in the valve threads. Surplus compound will then be forced outwards and will not enter the valve. Over use of compound can lead to valve failure on the body ends. Threads should be engaged correctly when tightening the valve onto the pipe. The wrench should always be fitted on the body end adjacent to the joint being made. Severe damage can occur to stems, valves and seats by the use of hand tools or levers larger than those originally supplied by the manufacturer, and by wheelkeys.

Any electrical component e.g. actuators, limit switches must be explosion proof and comply with the ATEX Directive and Standards as listed in BS EN 1127-1 Clauses 6, 4.5.

with the pipe run in which it is installed. To close - turn the lever 90° so that it is across the line of the pipe in which it is installed. Full closure and closing is completed when a full 90° is achieved and the lever is firmly set against the stop on the valve body.

PB T Models have lockable handles for use in both open and closed positions. In the fully open position the T handle is in line with the pipe work. To lock the valve in the open position a hexagon key of the appropriate size can be used to remove the securing screw. The T handle can then be fitted from the valve. This should then be rotated through 180° and refitted on to the valve spring ensuring the handle slot engages on to the body lug. Insert the securing screw and re-tighten with the hexagon key.

PB EL models are fitted with an extended spindle mechanism that lifts the lever away from the body and is particularly useful when pipe insulation is being used. This version is only available with a standard lever handle.

Caution: Service applications with extremes of temperature may cause the ball to become tight in the valve. The valve may be become stiff to operate in these circumstances. Suitable hand protection should be worn when operating valves used in extreme temperature applications. The valve should only be used in the fully open or fully closed position. Ball valves are not suitable for regulating or throttling applications.

MAINTENANCE

A regular maintenance program is the most efficient method of ensuring longer term operational efficiency of the selected valve. Such a program would need to include a risk assessment and a planned procedure of how the maintenance will be carried out. The possibility of operational limits being exceeded and the potential hazards ensuring must be considered as part of this assessment.

This should be implemented to include visual checks on the valve's condition and any development of unforeseen conditions, which could lead to failure. The correct fitting tools and equipment should be used for valve maintenance work. Separate means of draining the pipe work must be provided when carrying out any maintenance to valves. Where there may be any system debris this should be collected and/or filtered by installation of the appropriate protective device.

Gland Adjustment - The gland may need adjustment during installation and then periodically thereafter to maintain a stem gland seal.

NOTE: It is recommended that within the 1st year the gland be inspected at 3 monthly intervals to check for gland leakage. Gland replacement - Under normal working conditions Pegler gate and globe valves do not normally require any maintenance, however, in the event of maintenance being necessary, the following procedure should be followed:

Before starting work, de-pressurise the system, turn off any circulating pumps. Slacken the hand wheel nut and remove the nut, nomenclature and hand wheel. Remove the gland nut and gland ring. Using a suitable tool, lift out the existing packing and make sure the stem and stuffing box are clean & free from debris. Care must be taken not to damage the valve stem.

Fit a replacement Pegler packing gland into the stuffing box and push down firmly.

Re-assemble the gland ring and gland nut.
Re-attach the handwheel, nomenclature and nut.
Tighten the gland nut and confirm stem resistance while operating the valve. Once the pressure is re-established a check for leak tightness should be made, further adjust the gland nut as required necessary to achieve a satisfactory seal.

PB Permanent removal of the gland nut and for the Data Plate will invalidate the CE compliance of this valve. Pegler Ball valves and Check valves are generally NOT suitable for maintenance.

According to valve type, gland packing and valve discs may be replaced. Valves within the scope of the ATEX Directive with a protective level defined as Group I (category 2 will operate in Zone 1 (gases/vapours) or Zone 21 (dust) designated in BS1127-1 Explosion prevention and protection. Tools are either "single spark" e.g. screwdriver, spanner, impact screwdriver or "shower of sparks" e.g. sawing or grinding. Only steel "single spark" tools are permitted in Zones 1 & 21. Tools causing showers of sparks are only permissible if: a) no hazardous explosive atmosphere is present. b) dust deposits have been removed and no dust cloud is present. The use of tools on equipment in Zones 1 and 21 should be subject to a "permit to work" system.

1029 Renewable Valve Disc Replacement.

Before starting work, de-pressurise the system, turn off any circulating pumps, and ensure the valve is empty of fluid. Using a suitable wrench remove the complete bonnet assembly from the valve. Care should be taken to ensure the appwork is held securely during this process so that there is no distortion to the valve threads. Any damage to the threads could lead to valve failure. Slacken and remove disc nut and disc.

Assess damage to valve seat replacing the whole valve if necessary.

The valve disc can be replaced with an equivalent size disc and type as appropriate. Re-attach a replacement disc and disc nut. Re-assemble the bonnet in to the valve body, checking for damage. Ensure the valve bonnet is joined securely to body and will not leak. NB. The 1029 Globe valves have non-metallic PTFE valve discs. **Installation, Operating & Maintenance Instructions are available from Sales Office.** Pegler recommended spares must be used. Refer to Pegler Technical Department for further information.

PRODUCT LIFE SPAN

When a valve is properly selected for its service conditions it should give years of trouble-free service provided it is installed correctly and receives adequate preventative maintenance. By not considering the compatibility of the system design and the pressure and temperature requirements the life expectancy of the valves can be adversely affected and valve failure may occur. The nature of the fluid being carried through the valve could also affect the valve performance as this could lead to premature valve failure. There may also be interactions between metals in the pipe system and the valve which need to be considered. Appropriate flushing and cleaning of the pipe work installation should take place when commissioning the system as this would help extend the valve life.

Reference Material: Pegler Valves Package Brochure, Pegler Spares Catalogue, and Spares Price list. A Technical File is held at Doncaster as part of the requirements for compliance to the European Pressure Equipment Directive (PED 97/23 EC).

MAINTAINING A POLICY OF CONTINUAL PRODUCT DEVELOPMENT PRESERVED RESERVES THE RIGHT TO CHANGE SPECIFICATION DESIGN AND MATERIALS OR PRODUCTS LISTED IN THIS LABELLET WITHOUT PRIOR NOTICE

Head Office:

Pegler Limited, St Catherine's Avenue, Doncaster, South Yorkshire DN4 8DF England www.pegler.co.uk

UK Sales:

Northern Tel: 0870 1200281 Fax: 01302 560108
Southern Tel: 0870 1200282 Fax: 01302 560458
Western Tel: 0870 1200283 Fax: 01302 560109
uk.sales@pegler.co.uk

Export Sales:

Tel: 44 (0) 1302 855656 Fax: 44 (0) 1302 730513
export@pegler.co.uk

PL Pegler
QUALITY • RELIABILITY • INNOVATION

PL Pegler
QUALITY • RELIABILITY • INNOVATION

Engineers Valves

Installation, Operating & Maintenance Instructions

Pressure Equipment Directive

PED 97/23/EC Compliant

A Watertight Guarantee Of Quality

VALVE SUITABILITY

Product	Steam	Water	Oil	Air	Gas Inert	Gas Condensable	Gas Corrosive	Gas Oxygen
P8700	✓	✓	✓	✓	✓	✓	✓	X
P8500 RED	✓	✓	✓	✓	X	X	X	X
P8500 YELLOW	✓	✓	✓	✓	✓	✓	✓	X
P8300 RED/BLUE	✓	✓	✓	✓	X	X	X	X
P8300 YELLOW	✓	✓	✓	✓	✓	✓	✓	X
P8100	X	✓	✓	✓	X	X	X	X
1065	X	✓	✓	✓	X	X	X	X
1068	✓	✓	✓	✓	X	X	X	X
1072	✓	✓	✓	✓	X	X	X	X
1070/125	✓	✓	✓	✓	X	X	X	X
P81M	✓	✓	✓	X	X	X	X	X
63	X	✓	✓	X	X	X	X	X
GMS3	X	✓	✓	X	X	X	X	X
1029	✓	✓	✓	✓	✓	✓	✓	X
1031	✓	✓	✓	X	X	X	X	X
1039	✓	✓	✓	X	X	X	X	X
1060A	✓	✓	✓	X	X	X	X	X
1062	✓	✓	✓	X	X	X	X	X
1063	X	✓	✓	X	X	X	X	X
1064	X	✓	✓	X	X	X	X	X
1832	X	✓	✓	X	X	X	X	X
833GM, GM LS	X	✓	✓	X	X	X	X	X

* Pressure limited to 10 bar for Air & Gas applications. ** Pressure limited to 5 bar for Air applications.

Thread Depths (mm)

Product	1/4"	3/8"	1/2"	3/4"	1"	1.1/4"	1.1/2"	2"	2.1/2"	3"	4"
P8700	11.5	11.9	15.4	16.7	19.4	21.7	21.4	26.0	30.5	33.5	39.5
P8500 RED	11.5	11.9	15.4	16.7	19.4	21.7	21.4	26.0	30.5	33.5	39.5
P8500 YELLOW	11.5	11.9	15.4	16.7	19.4	21.7	21.4	26.0	30.5	33.5	39.5
P8300 RED/BLUE	-	-	-	-	-	-	-	-	-	-	-
P8300 YELLOW	-	-	-	-	-	-	-	-	-	-	-
P8100	-	-	12.7	14.0	16.2	18.5	18.5	22.8	-	-	-
1065	-	-	12.7	14.0	16.1	18.5	18.5	22.8	-	-	-
1068	-	-	15.0	16.3	19.1	21.4	21.4	25.7	30.2	33.3	39.3
1072	-	-	15.0	16.3	19.1	21.4	21.4	25.7	-	-	-
1070/125	11.4	11.4	15.0	16.3	19.1	21.4	21.4	25.7	30.2	33.3	39.3
P81M	-	-	-	-	-	-	-	-	-	-	-
63	-	-	-	-	-	-	-	-	-	-	-
GMS3	-	-	-	-	-	-	-	-	-	-	-
1029	7.5	7.9	9.9	11.1	12.3	14.3	14.3	18.2	19.8	22.6	-
1031	-	-	9.9	11.1	12.3	14.3	14.3	18.2	-	-	-
1039	-	-	9.9	11.1	12.3	14.3	14.3	18.2	-	-	-
1060A	-	-	15.0	16.3	19.1	21.4	21.4	25.7	25.0	33.0	33.0
1062	-	-	15.9	16.7	19.0	-	-	-	-	-	-
1063	-	10.3	12.8	14.2	15.0	15.2	16.4	17.2	19.8	26.0	26.6
1064	-	10.3	12.8	14.2	15.0	15.2	16.4	17.2	19.8	26.0	26.6
1832	-	-	-	-	-	-	-	-	-	-	-
833GM, GM LS	-	-	-	-	-	-	-	-	-	-	-

OPERATIONAL LIMITS

Product	PN	Non-Shock Pressure @ Temp. Range	Non-Shock Pressure @ Max. Range
P8700	40*	40 Bar - 10°C to 110°C	10 Bar at 180°C
P8500 RED	25	25 Bar - 10°C to 100°C	16.5 Bar at 150°C
P8500 YELLOW	25*	25 Bar - 10°C to 100°C	16.5 Bar at 150°C
P8300 RED/BLUE	16	16 Bar - 10°C to 30°C	5 Bar at 120°C
P8300 YELLOW	16*	16 Bar - 10°C to 30°C	5 Bar at 120°C
P8100	25	25 Bar - 10°C to 100°C	4 Bar at 120°C
1065	17.5	17.5 Bar - 0°C to 25°C	17.5 Bar at 93°C
1068	20	20 Bar - 10°C to 100°C	9 Bar at 180°C
1072	32	32 Bar - 10°C to 100°C	14 Bar at 198°C
1070/125	20	20 Bar - 10°C to 100°C	9 Bar at 180°C
P81M	16	20 Bar - 10°C to 100°C	9 Bar at 180°C
63	16	16 Bar - 10°C to 30°C	5 Bar at 120°C
GMS3	16	16 Bar - 10°C to 30°C	5 Bar at 120°C
1029	32*	32 Bar - 10°C to 100°C	14 Bar at 198°C
1031	32	32 Bar - 10°C to 100°C	14 Bar at 198°C
1039	32	32 Bar - 10°C to 100°C	14 Bar at 198°C
1060A	25	25 Bar - 10°C to 100°C	10.5 Bar at 186°C
1062	25	25 Bar - 10°C to 100°C	10.5 Bar at 186°C
1063	8 - 12	0°C to 90°C	90°C
1064	8 - 12	0°C to 90°C	90°C
1832	10	10 Bar - 0°C to 120°C	10 Bar at 120°C
833GM, GM LS	10	20 Bar - 10°C to 100°C	13 Bar at 120°C

* 10 bar for Gas

PED Categorisation Table

Product	1/4"	3/8"	1/2"	3/4"	1"	1.1/4"	1.1/2"	2"	2.1/2"	3"	4"
P8700	S.E.P	S.E.P	S.E.P	S.E.P	S.E.P	Cat 1	Cat 1	Cat 1	Cat 1	Cat 1	Cat 1
P8500 RED	S.E.P	S.E.P	S.E.P	S.E.P	S.E.P	S.E.P	S.E.P	S.E.P	S.E.P	S.E.P	S.E.P
P8500 YELLOW	S.E.P	S.E.P	S.E.P	S.E.P	S.E.P	Cat 1	Cat 1	Cat 1	Cat 1	Cat 1	Cat 1
P8300 RED/BLUE	-	-	-	-	-	-	-	-	-	-	-
P8300 YELLOW	-	-	-	-	-	-	-	-	-	-	-
P8100	-	-	-	-	-	-	-	-	-	-	-
1065	-	-	-	-	-	-	-	-	-	-	-
1068	-	-	-	-	-	-	-	-	-	-	-
1072	-	-	-	-	-	-	-	-	-	-	-
1070/125	S.E.P	S.E.P	S.E.P	S.E.P	S.E.P	S.E.P	S.E.P	S.E.P	S.E.P	S.E.P	S.E.P
P81M	-	-	-	-	-	-	-	-	-	-	-
63	-	-	-	-	-	-	-	-	-	-	-
GMS3	-	-	-	-	-	-	-	-	-	-	-
1029	S.E.P	S.E.P	S.E.P	S.E.P	S.E.P	Cat 1	Cat 1	Cat 1	Cat 2	Cat 2	-
1031	-	-	-	-	-	-	-	-	-	-	-
1039	-	-	-	-	-	-	-	-	-	-	-
1060A	-	-	-	-	-	-	-	-	-	-	-
1062	-	-	-	-	-	-	-	-	-	-	-
1063	-	-	-	-	-	-	-	-	-	-	-
1064	-	-	-	-	-	-	-	-	-	-	-
1832	-	-	-	-	-	-	-	-	-	-	-
833GM, GM LS	-	-	-	-	-	-	-	-	-	-	-

Category 1 and Category 2 carry the CE mark