

1070/125 LS Bronze Full Bore Lockshield Gate Valve

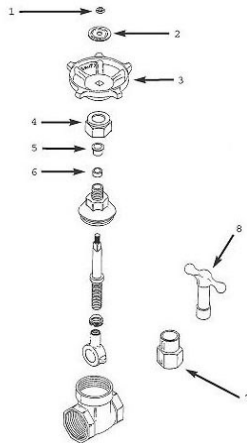
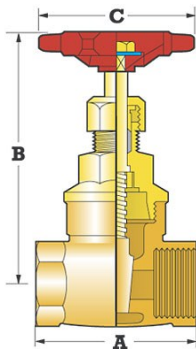

Bronze full way gate valve with lockshield. BS 5154 PN20 Series B. BS21 Taper thread.

GENERAL INFORMATION

Pattern No. key :LS = Lockshield

Size	Pattern No.	Pack 1 Qty	Code	Barcode
1/2	1070/125 LS	10	103057	5022050231765
3/4	1070/125 LS	5	103058	5022050231987
1	1070/125 LS	5	103059	5022050232243
1 1/4	1070/125 LS	2	103060	5022050232359
1 1/2	1070/125 LS	2	103061	5022050232519
2	1070/125 LS	2	103062	5022050232595

DIMENSIONS (mm)

Code	Description	A	B	Kg
103057	1/2 1070/125 LS GM GATEVALVE	52	85	60
103058	3/4 1070/125 LS GM GATEVALVE	56	95	60
103059	1 1070/125 LS GM GATEVALVE	65	110	70
103060	1.1/4 1070/125 LS GM GATEVALVE	73	125	75
103061	1.1/2 1070/125 LS GM GATEVALVE	76	145	95
103062	2 1070/125 LS GM GATEVALVE	90	170	105

SPARES

5					
Pattern / Size	Description	Code	Barcode	Date From	Date To
1070/125 LS / 1/2	G16 GLAND	850485	5013866061011	01/01/1900	current
1070/125 LS / 3/4	G16 GLAND	850485	5013866061011	01/01/1900	current
1070/125 LS / 1	G17 GLAND	850486	5013866061028	01/01/1900	current
1070/125 LS / 1.1/4	G18 GLAND	815202	5013866057274	01/01/1900	current
1070/125 LS / 1.1/2	G19 GLAND	850487	5013866061035	01/01/1900	current
1070/125 LS / 2	G20 GLAND	850488	5013866061042	01/01/1900	current

6					
Pattern / Size	Description	Code	Barcode	Date From	Date To
1070/125 LS / 1/2	GP12 GLAND PACKING	850327	5013866060021	01/01/1900	current
1070/125 LS / 3/4	GP12 GLAND PACKING	850327	5013866060021	01/01/1900	current
1070/125 LS / 1	GP8 GLAND PACKING	855241	5013866065187	01/01/1900	current
1070/125 LS / 1.1/4	GP10 GLAND PACKING	850325	5013866060007	01/01/1900	current
1070/125 LS / 1.1/2	GP9 GLAND PACKING	855247	5013866065200	01/01/1900	current
1070/125 LS / 2	GP16 GLAND PACKING	855245	5013866065194	01/01/1900	current

7					
Pattern / Size	Description	Code	Barcode	Date From	Date To
1070/125 LS / 1/2	LS6 LOCKSHIELD	855238	5013866065170	01/01/1900	current
1070/125 LS / 3/4	LS6 LOCKSHIELD	855238	5013866065170	01/01/1900	current
1070/125 LS / 1	LS3 LOCKSHIELD	850152	5013866059681	01/01/1900	current
1070/125 LS / 1.1/4	LS9 LOCKSHIELD	815201	5013866057267	01/01/1900	current
1070/125 LS / 1.1/2	LS13 LOCKSHIELD	850416	5013866060502	01/01/1900	current
1070/125 LS / 2	LS14 LOCKSHIELD	850367	5013866060250	01/01/1900	current

8					
Pattern / Size	Description	Code	Barcode	Date From	Date To
1070/125 LS / 1/2	K9 LOCKSHIELD KEY	850139	5013866059650	01/01/1900	current
1070/125 LS / 3/4	K9 LOCKSHIELD KEY	850139	5013866059650	01/01/1900	current
1070/125 LS / 1	K2 LOCKSHIELD KEY	817020	5013866058448	01/01/1900	current
1070/125 LS / 1.1/4	K3 LOCKSHIELD KEY	850132	5013866059612	01/01/1900	current
1070/125 LS / 1.1/2	K5 LOCKSHIELD KEY	850134	5013866059629	01/01/1900	current
1070/125 LS / 2	K6 LOCKSHIELD KEY	850135	5013866059636	01/01/1900	current

GUARANTEE

Valves and Fittings

Pegler Yorkshire Customcare 5 Year Guarantee - Terms and Conditions

Products are subject to a 5 year guarantee that is between Pegler Yorkshire and the final purchaser of the product.

The guarantee is subject to proof of purchase being supplied.

This guarantee does not affect any statutory rights the consumer may have in law.

The guarantee covers manufacturing or material defects and does not cover parts subject to normal wear and tear.

This product range has been designed for the use of homeowners, domestic and commercial applications and therefore the guarantee is subject to the product being properly selected for their intended service conditions.

The guarantee is not applicable where the product is fitted contrary to the conditions in the fitting instructions.

This is reinforced where valves are covered by the European Pressure Equipment Directive (PED97/23/EC) where Installation, Operating and Maintenance Instructions are supplied with each product and/or carton.

Provided it is installed correctly and receives adequate preventative maintenance it should give years of trouble – free service.

Abusive behaviour and accidental damage to the product are not covered by this guarantee.

The extent of this liability is limited to the cost of the replacement of the defective item and not to fitting or consequential damages.

APPROVALS



[WRAS 1070/125](#)