

# 1070/125 Bronze Full Bore Gate Valve



## Bronze full way gate valve BS 5154 PN20 Series B

### GENERAL INFORMATION

Pattern No. key :Standard Thread = BS21 Taper, AT = American Thread, PT = Parallel Thread

Size	Pattern No.	Pack 1 Qty	Code	Barcode	Discontinued
1/4	1070/125	10	103005	5013866012570	10/04/2009
3/8	1070/125	10	103006	5013866012587	10/04/2009
1/2	1070/125	10	103007	5013866012594	
3/4	1070/125	10	103008	5013866012600	
1	1070/125	5	103009	5013866012617	
1 1/4	1070/125	2	103010	5013866012624	
1 1/2	1070/125	2	103011	5013866012631	
2	1070/125	2	103012	5013866012648	
2 1/2	1070/125	1	103013	5013866000355	
3	1070/125	1	103014	5013866000362	
4	1070/125	1	103015	5013866000379	
1/4	1070/125 AT	10	103025	753818003403	21/07/2006
3/8	1070/125 AT	0	103026	5022050287175	21/07/2006
1/2	1070/125 AT	0	103027	5022050317957	21/07/2006
3/4	1070/125 AT	0	103028	5022050287243	21/07/2006
1	1070/125 AT	0	103029	5022050318015	21/07/2006
1 1/4	1070/125 AT	0	103030	5022050287328	21/07/2006
1 1/2	1070/125 AT	0	103031	5022050318077	21/07/2006
2	1070/125 AT	0	103032	5022050287397	21/07/2006
2 1/2	1070/125 AT	0	103033	5022050318138	22/05/2008
3	1070/125 AT	0	103034	5022050287496	22/05/2008
4	1070/125 AT	0	103035	5022050318190	22/05/2008
1/4	1070/125 PT	0	103045	5022050287564	21/07/2006
3/8	1070/125 PT	0	103046	5022050318251	21/07/2006
1/2	1070/125 PT	10	103047	5013866012679	
3/4	1070/125 PT	10	103048	5013866012686	
1	1070/125 PT	5	103049	5013866012693	
1 1/4	1070/125 PT	2	103050	5013866012709	
1 1/2	1070/125 PT	2	103051	5013866012716	
2	1070/125 PT	2	103052	5013866012723	
2 1/2	1070/125 PT	1	103053	5013866000461	
3	1070/125 PT	1	103054	5013866000478	
4	1070/125 PT	0	103055	5022050287649	21/07/2006

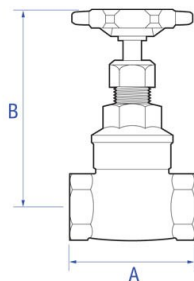

### DIMENSIONS (mm)

Code	Description	A	B	Kg
103005	1/4 1070/125 GM GATEVALVE	43	85	60
103006	3/8 1070/125 GM GATEVALVE	43	85	60
103007	1/2 1070/125 GM GATEVALVE	52	85	0.32
103008	3/4 1070/125 GM GATEVALVE	56	95	0.46
103009	1 1070/125 GM GATEVALVE	65	110	0.69
103010	1.1/4 1070/125 GM GATEVALVE	73	125	1.03
103011	1.1/2 1070/125 GM GATEVALVE	76	145	1.40
103012	2 1070/125 GM GATEVALVE	90	170	2.28
103013	2.1/2 1070/125 GM GATEVALVE	102	205	3.68
103014	3 1070/125 GM GATEVALVE	114	240	5.42
103015	4 1070/125 GM GATEVALVE	134	290	10.59
103025	1/4 1070/125 AT GM GATEVALVE	43	85	60
103026	3/8 1070/125 AT GM GATEVALVE	43	85	60
103027	1/2 1070/125 AT GM GATEVALVE	52	85	60
103028	3/4 1070/125 AT GM GATEVALVE	56	95	60
103029	1 1070/125 AT GM GATEVALVE	65	110	70
103030	1.1/4 1070/125 AT GM GATEVALVE	73	125	75
103031	1.1/2 1070/125 AT GM GATEVALVE	76	145	95
103032	2 1070/125 AT GM GATEVALVE	90	170	105
103033	2.1/2 1070/125 AT GM GATEVALVE	102	205	120
103034	3 1070/125 AT GM GATEVALVE	114	240	155
103035	4 1070/125 AT GM GATEVALVE	134	290	155
103045	1/4 1070/125 PT GM GATEVALVE	43	85	60
103046	3/8 1070/125 PT GM GATEVALVE	43	85	60
103047	1/2 1070/125 PT GM GATEVALVE	52	85	0.32
103048	3/4 1070/125 PT GM GATEVALVE	56	95	0.46
103049	1 1070/125 PT GM GATEVALVE	65	110	0.69
103050	1.1/4 1070/125 PT GM GATEVALVE	73	125	1.03
103051	1.1/2 1070/125 PT GM GATEVALVE	76	145	1.40
103052	2 1070/125 PT GM GATEVALVE	90	170	2.28
103053	2.1/2 1070/125 PT GM GATEVALVE	102	205	3.68
103054	3 1070/125 PT GM GATEVALVE	114	240	5.42
103055	4 1070/125 PT GM GATEVALVE	134	290	155

### PRESSURE & TEMPERATURE

1070/125 Bronze Full Bore Gate Valve	Minimum Operating Pressure (bar)	Maximum Cold Working Pressure (bar)	Maximum Hot Working Pressure (bar)
3/8 1070/125 GM GATEVALVE	No Minimum Operating Pressure	20.0 bar at temperatures up to 100oC	9 bar at temperatures up to 180oC

### MATERIAL SPECIFICATIONS

Number	Component	Material
1	Body	Gunmetal
2	Bonnet	Forged Brass (1/4" to 3") Gravity Die Cast Brass (4")
3	Stem	Brass Bar
4	Wedge	Gunmetal
5	Stem Ring	Brass Bar
6	Gland	Brass Bar
7	Gland Nut	Brass Bar (1/4" to 1") Forged Brass (1.1/4" to 4")
8	Handwheel	Aluminium
9	Handwheel Nut	Brass Bar
10	Gland Packing	PTFE
11	Rating Disc	Aluminum

### SPARES

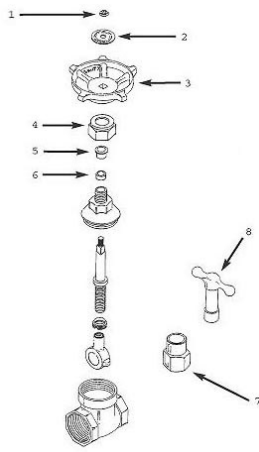

1					
Pattern / Size	Description	Code	Barcode	Date From	Date To
1070/125 / 1/4	WN1 HANDWHEEL NUT BRASS (M5)	850481	5013866060977	01/01/1900	current
1070/125 / 3/8	WN1 HANDWHEEL NUT BRASS (M5)	850481	5013866060977	01/01/1900	current
1070/125 / 1/2	WN1 HANDWHEEL NUT BRASS (M5)	850481	5013866060977	01/01/1900	current
1070/125 / 3/4	WN1 HANDWHEEL NUT BRASS (M5)	850481	5013866060977	01/01/1900	current
1070/125 / 1	WN2 HANDWHEEL NUT BRASS (M6)	850482	5013866060984	01/01/1900	current
1070/125 / 1.1/4	WN2 HANDWHEEL NUT BRASS (M6)	850482	5013866060984	01/01/1900	current
1070/125 / 1.1/2	WN14 HANDWHEEL NUT BRASS (M8)	850512	5013866061141	01/09/1999	current
1070/125 / 1.1/2	WN2 HANDWHEEL NUT BRASS (M6)	850482	5013866060984	01/01/1990	31/08/1999
1070/125 / 2	WN2 HANDWHEEL NUT BRASS (M6)	850482	5013866060984	01/01/1900	current
1070/125 / 2.1/2	WN14 HANDWHEEL NUT BRASS (M8)	850512	5013866061141	01/09/1999	current
1070/125 / 2.1/2	WN3 HANDWHEEL NUT BRASS (5/16 UNC)	851411	5013866063923	01/01/1990	31/08/1999
1070/125 / 3	WN4 HANDWHEEL NUT BRASS (3/8 UNC)	851412	5013866063930	01/01/1990	31/08/1999
1070/125 / 3	WN15 HANDWHEEL NUT BRASS (M10)	850724	5013866061929	01/09/1999	current
1070/125 / 4	WN15 HANDWHEEL NUT BRASS (M10)	850724	5013866061929	01/09/1999	current
1070/125 / 4	WN4 HANDWHEEL NUT BRASS (3/8 UNC)	851412	5013866063930	01/01/1990	31/08/1999
1070/125 PT / 1/4	WN1 HANDWHEEL NUT BRASS (M5)	850481	5013866060977	01/01/1900	current
1070/125 PT / 3/8	WN1 HANDWHEEL NUT BRASS (M5)	850481	5013866060977	01/01/1900	current
1070/125 PT / 1/2	WN1 HANDWHEEL NUT BRASS (M5)	850481	5013866060977	01/01/1900	current
1070/125 PT / 3/4	WN1 HANDWHEEL NUT BRASS (M5)	850481	5013866060977	01/01/1900	current
1070/125 PT / 1	WN2 HANDWHEEL NUT BRASS (M6)	850482	5013866060984	01/01/1900	current
1070/125 PT / 1.1/4	WN2 HANDWHEEL NUT BRASS (M6)	850482	5013866060984	01/01/1900	current
1070/125 PT / 1.1/2	WN2 HANDWHEEL NUT BRASS (M6)	850482	5013866060984	01/01/1990	31/08/1999
1070/125 PT / 1.1/2	WN14 HANDWHEEL NUT BRASS (M8)	850512	5013866061141	01/09/1999	current
1070/125 PT / 2	WN2 HANDWHEEL NUT BRASS (M6)	850482	5013866060984	01/01/1900	current
1070/125 PT / 2.1/2	WN3 HANDWHEEL NUT BRASS (5/16 UNC)	851411	5013866063923	01/01/1990	31/08/1999
1070/125 PT / 2.1/2	WN14 HANDWHEEL NUT BRASS (M8)	850512	5013866061141	01/09/1999	current
1070/125 PT / 3	WN15 HANDWHEEL NUT BRASS (M10)	850724	5013866061929	01/09/1999	current
1070/125 PT / 3	WN4 HANDWHEEL NUT BRASS (3/8 UNC)	851412	5013866063930	01/01/1990	31/08/1999
1070/125 PT / 4	WN4 HANDWHEEL NUT BRASS (3/8 UNC)	851412	5013866063930	01/01/1990	31/08/1999
1070/125 PT / 4	WN15 HANDWHEEL NUT BRASS (M10)	850724	5013866061929	01/09/1999	current

2					
Pattern / Size	Description	Code	Barcode	Date From	Date To
1070/125 / 1/4	RATING DISC 1070/125 - SIZE 1	850435	5013866060656	01/01/1900	current
1070/125 / 3/8	RATING DISC 1070/125 - SIZE 1	850435	5013866060656	01/01/1900	current
1070/125 / 1/2	RATING DISC 1070/125 - SIZE 1	850435	5013866060656	01/01/1900	current
1070/125 / 3/4	RATING DISC 1070/125 - SIZE 1	850435	5013866060656	01/01/1900	current
1070/125 / 1	RATING DISC 1070/125 - SIZE 1	850435	5013866060656	01/01/1900	current
1070/125 / 1.1/4	RATING DISC 1070/125 - SIZE 1	850435	5013866060656	01/01/1900	current
1070/125 / 1.1/2	RATING DISC 1070/125 - SIZE 1	850435	5013866060656	01/01/1900	current
1070/125 / 2	RATING DISC 1070/125 - SIZE 1	850435	5013866060656	01/01/1900	current
1070/125 / 2.1/2	RATING DISC 1070/125 - SIZE 2	850436	5013866060663	01/01/1900	current
1070/125 / 3	RATING DISC 1070/125 - SIZE 3	850437	5013866060670	01/01/1900	current
1070/125 / 4	RATING DISC 1070/125 - SIZE 3	850437	5013866060670	01/01/1900	current
1070/125 PT / 1/4	RATING DISC 1070/125 - SIZE 1	850435	5013866060656	01/01/1900	current
1070/125 PT / 3/8	RATING DISC 1070/125 - SIZE 1	850435	5013866060656	01/01/1900	current
1070/125 PT / 1/2	RATING DISC 1070/125 - SIZE 1	850435	5013866060656	01/01/1900	current
1070/125 PT / 3/4	RATING DISC 1070/125 - SIZE 1	850435	5013866060656	01/01/1900	current
1070/125 PT / 1	RATING DISC 1070/125 - SIZE 1	850435	5013866060656	01/01/1900	current
1070/125 PT / 1.1/4	RATING DISC 1070/125 - SIZE 1	850435	5013866060656	01/01/1900	current
1070/125 PT / 1.1/2	RATING DISC 1070/125 - SIZE 1	850435	5013866060656	01/01/1900	current
1070/125 PT / 2	RATING DISC 1070/125 - SIZE 1	850435	5013866060656	01/01/1900	current
1070/125 PT / 2.1/2	RATING DISC 1070/125 - SIZE 2	850436	5013866060663	01/01/1900	current
1070/125 PT / 3	RATING DISC 1070/125 - SIZE 3	850437	5013866060670	01/01/1900	current
1070/125 PT / 4	RATING DISC 1070/125 - SIZE 3	850437	5013866060670	01/01/1900	current

3					
Pattern / Size	Description	Code	Barcode	Date From	Date To
1070/125 / 1/4	W1 HANDWHEEL (RED)	850100	5013866059513	01/01/1900	current
1070/125 / 3/8	W1 HANDWHEEL (RED)	850100	5013866059513	01/01/1900	current
1070/125 / 1/2	W1 HANDWHEEL (RED)	850100	5013866059513	01/01/1900	current
1070/125 / 3/4	W1 HANDWHEEL (RED)	850100	5013866059513	01/01/1900	current
1070/125 / 1	W3 HANDWHEEL (RED)	850101	5013866059520	01/01/1900	current
1070/125 / 1.1/4	W4 HANDWHEEL (RED)	850102	5013866059537	01/01/1900	current
1070/125 / 1.1/2	W6 HANDWHEEL (RED)	850104	5013866059551	01/01/1900	current
1070/125 / 2	W7 HANDWHEEL (RED)	850105	5013866059568	01/01/1900	current
1070/125 / 2.1/2	W8 HANDWHEEL (RED)	850106	5013866059575	01/01/1900	current
1070/125 / 3	W10 HANDWHEEL (RED)	850107	5013866059582	01/01/1900	current
1070/125 / 4	W10 HANDWHEEL (RED)	850107	5013866059582	01/01/1900	current
1070/125 PT / 1/4	W1 HANDWHEEL (RED)	850100	5013866059513	01/01/1900	current
1070/125 PT / 3/8	W1 HANDWHEEL (RED)	850100	5013866059513	01/01/1900	current
1070/125 PT / 1/2	W1 HANDWHEEL (RED)	850100	5013866059513	01/01/1900	current
1070/125 PT / 3/4	W1 HANDWHEEL (RED)	850100	5013866059513	01/01/1900	current
1070/125 PT / 1	W3 HANDWHEEL (RED)	850101	5013866059520	01/01/1900	current
1070/125 PT / 1.1/4	W4 HANDWHEEL (RED)	850102	5013866059537	01/01/1900	current
1070/125 PT / 1.1/2	W6 HANDWHEEL (RED)	850104	5013866059551	01/01/1900	current
1070/125 PT / 2	W7 HANDWHEEL (RED)	850105	5013866059568	01/01/1900	current
1070/125 PT / 2.1/2	W8 HANDWHEEL (RED)	850106	5013866059575	01/01/1900	current
1070/125 PT / 3	W10 HANDWHEEL (RED)	850107	5013866059582	01/01/1900	current
1070/125 PT / 4	W10 HANDWHEEL (RED)	850107	5013866059582	01/01/1900	current

4					
Pattern / Size	Description	Code	Barcode	Date From	Date To
1070/125 / 1/4	GN1 GLAND NUT	850310	5013866059889	01/01/1900	current
1070/125 / 3/8	GN1 GLAND NUT	850310	5013866059889	01/01/1900	current
1070/125 / 1/2	GN11 GLAND NUT	851338	5013866063916	01/01/1900	current
1070/125 / 3/4	GN11 GLAND NUT	851338	5013866063916	01/01/1900	current
1070/125 / 1	GN8 GLAND NUT	850312	5013866059902	01/01/1900	current
1070/125 / 1.1/4	GN9 GLAND NUT	850313	5013866059919	01/01/1900	current
1070/125 / 1.1/2	GN10 GLAND NUT	850314	5013866059926	01/01/1900	current
1070/125 / 2	GN12 GLAND NUT	850315	5013866059933	01/01/1900	current
1070/125 / 2.1/2	GN13 GLAND NUT	851150	5013866063893	01/01/1900	current
1070/125 / 3	GN15 GLAND NUT	850317	5013866059940	01/01/1900	current
1070/125 / 4	GN23 GLAND NUT	851029	5013866063862	01/01/1900	current
1070/125 PT / 1/4	GN1 GLAND NUT	850310	5013866059889	01/01/1900	current
1070/125 PT / 3/8	GN1 GLAND NUT	850310	5013866059889	01/01/1900	current
1070/125 PT / 1/2	GN11 GLAND NUT	851338	5013866063916	01/01/1900	current
1070/125 PT / 3/4	GN11 GLAND NUT	851338	5013866063916	01/01/1900	current
1070/125 PT / 1	GN8 GLAND NUT	850312	5013866059902	01/01/1900	current
1070/125 PT / 1.1/4	GN9 GLAND NUT	850313	5013866059919	01/01/1900	current
1070/125 PT / 1.1/2	GN10 GLAND NUT	850314	5013866059926	01/01/1900	current
1070/125 PT / 2	GN12 GLAND NUT	850315	5013866059933	01/01/1900	current
1070/125 PT / 2.1/2	GN13 GLAND NUT	851150	5013866063893	01/01/1900	current
1070/125 PT / 3	GN15 GLAND NUT	850317	5013866059940	01/01/1900	current
1070/125 PT / 4	GN23 GLAND NUT	851029	5013866063862	01/01/1900	current

5					
Pattern / Size	Description	Code	Barcode	Date From	Date To
1070/125 / 1/4	G1 GLAND	855236	5013866065163	01/01/1900	current
1070/125 / 3/8	G1 GLAND	855236	5013866065163	01/01/1900	current
1070/125 / 1/2	G16 GLAND	850485	5013866061011	01/01/1900	current
1070/125 / 3/4	G16 GLAND	850485	5013866061011	01/01/1900	current
1070/125 / 1	G17 GLAND	850486	5013866061028	01/01/1900	current
1070/125 / 1.1/4	G18 GLAND	815202	5013866057274	01/01/1900	current
1070/125 / 1.1/2	G19 GLAND	850487	5013866061035	01/01/1900	current
1070/125 / 2	G20 GLAND	850488	5013866061042	01/01/1900	current
1070/125 / 2.1/2	G21 GLAND	850489	5013866061059	01/01/1900	current
1070/125 / 3	G22 GLAND	850490	5013866061066	01/01/1900	current
1070/125 / 4	G15 GLAND	850369	5013866060274	01/01/1900	current
1070/125 PT / 1/4	G1 GLAND	855236	5013866065163	01/01/1900	current
1070/125 PT / 3/8	G1 GLAND	855236	5013866065163	01/01/1900	current
1070/125 PT / 1/2	G16 GLAND	850485	5013866061011	01/01/1900	current
1070/125 PT / 3/4	G16 GLAND	850485	5013866061011	01/01/1900	current
1070/125 PT / 1	G17 GLAND	850486	5013866061028	01/01/1900	current
1070/125 PT / 1.1/4	G18 GLAND	815202	5013866057274	01/01/1900	current
1070/125 PT / 1.1/2	G19 GLAND	850487	5013866061035	01/01/1900	current
1070/125 PT / 2	G20 GLAND	850488	5013866061042	01/01/1900	current
1070/125 PT / 2.1/2	G21 GLAND	850489	5013866061059	01/01/1900	current
1070/125 PT / 3	G22 GLAND	850490	5013866061066	01/01/1900	current
1070/125 PT / 4	G15 GLAND	850369	5013866060274	01/01/1900	current

6					
Pattern / Size	Description	Code	Barcode	Date From	Date To
1070/125 / 1/4	GP2 GLAND PACKING	855248	5013866065217	01/01/1900	current
1070/125 / 3/8	GP2 GLAND PACKING	855248	5013866065217	01/01/1900	current
1070/125 / 1/2	GP12 GLAND PACKING	850327	5013866060021	01/01/1900	current
1070/125 / 3/4	GP12 GLAND PACKING	850327	5013866060021	01/01/1900	current
1070/125 / 1	GP8 GLAND PACKING	855241	5013866065187	01/01/1900	current
1070/125 / 1.1/4	GP10 GLAND PACKING	850325	5013866060007	01/01/1900	current
1070/125 / 1.1/2	GP9 GLAND PACKING	855247	5013866065200	01/01/1900	current
1070/125 / 2	GP16 GLAND PACKING	855245	5013866065194	01/01/1900	current
1070/125 / 2.1/2	GP17 GLAND PACKING	850331	5013866060069	01/01/1900	current
1070/125 / 3	GP18 GLAND PACKING	851907	5013866063954	01/01/1900	current
1070/125 / 4	GP19 GLAND PACKING	850332	5013866060076	01/01/1900	current
1070/125 PT / 1/4	GP2 GLAND PACKING	855248	5013866065217	01/01/1900	current
1070/125 PT / 3/8	GP2 GLAND PACKING	855248	5013866065217	01/01/1900	current
1070/125 PT / 1/2	GP12 GLAND PACKING	850327	5013866060021	01/01/1900	current
1070/125 PT / 3/4	GP12 GLAND PACKING	850327	5013866060021	01/01/1900	current
1070/125 PT / 1	GP8 GLAND PACKING	855241	5013866065187	01/01/1900	current
1070/125 PT / 1.1/4	GP10 GLAND PACKING	850325	5013866060007	01/01/1900	current
1070/125 PT / 1.1/2	GP9 GLAND PACKING	855247	5013866065200	01/01/1900	current
1070/125 PT / 2	GP16 GLAND PACKING	855245	5013866065194	01/01/1900	current
1070/125 PT / 2.1/2	GP17 GLAND PACKING	850331	5013866060069	01/01/1900	current
1070/125 PT / 3	GP18 GLAND PACKING	851907	5013866063954	01/01/1900	current
1070/125 PT / 4	GP19 GLAND PACKING	850332	5013866060076	01/01/1900	current

7					
Pattern / Size	Description	Code	Barcode	Date From	Date To
1070/125 / 1/2	LS6 LOCKSHIELD	855238	5013866065170	01/01/1900	current
1070/125 / 3/4	LS6 LOCKSHIELD	855238	5013866065170	01/01/1900	current
1070/125 / 1	LS3 LOCKSHIELD	850152	5013866059681	01/01/1900	current
1070/125 / 1.1/4	LS9 LOCKSHIELD	815201	5013866057267	01/01/1900	current
1070/125 / 1.1/2	LS13 LOCKSHIELD	850416	5013866060502	01/01/1900	current
1070/125 / 2	LS14 LOCKSHIELD	850367	5013866060250	01/01/1900	current
1070/125 / 2.1/2	LS15 LOCKSHIELD	850368	5013866060267	01/01/1900	current
1070/125 / 3	LS10 LOCKSHIELD	850159	5013866059698	01/01/1900	current
1070/125 PT / 1/2	LS6 LOCKSHIELD	855238	5013866065170	01/01/1900	current
1070/125 PT / 3/4	LS6 LOCKSHIELD	855238	5013866065170	01/01/1900	current
1070/125 PT / 1	LS3 LOCKSHIELD	850152	5013866059681	01/01/1900	current
1070/125 PT / 1.1/4	LS9 LOCKSHIELD	815201	5013866057267	01/01/1900	current
1070/125 PT / 1.1/2	LS13 LOCKSHIELD	850416	5013866060502	01/01/1900	current
1070/125 PT / 2	LS14 LOCKSHIELD	850367	5013866060250	01/01/1900	current
1070/125 PT / 2.1/2	LS15 LOCKSHIELD	850368	5013866060267	01/01/1900	current
1070/125 PT / 3	LS10 LOCKSHIELD	850159	5013866059698	01/01/1900	current

8					
Pattern / Size	Description	Code	Barcode	Date From	Date To
1070/125 / 1/2	K9 LOCKSHIELD KEY	850139	5013866059650	01/01/1900	current
1070/125 / 3/4	K9 LOCKSHIELD KEY	850139	5013866059650	01/01/1900	current
1070/125 / 1	K2 LOCKSHIELD KEY	817020	5013866058448	01/01/1900	current
1070/125 / 1.1/4	K3 LOCKSHIELD KEY	850132	5013866059612	01/01/1900	current
1070/125 / 1.1/2	K5 LOCKSHIELD KEY	850134	5013866059629	01/01/1900	current
1070/125 / 2	K6 LOCKSHIELD KEY	850135	5013866059636	01/01/1900	current
1070/125 / 2.1/2	K6 LOCKSHIELD KEY	850135	5013866059636	01/01/1900	current
1070/125 / 3	K7 LOCKSHIELD KEY	850136	5013866059643	01/01/1900	current
1070/125 PT / 1/2	K9 LOCKSHIELD KEY	850139	5013866059650	01/01/1900	current
1070/125 PT / 3/4	K9 LOCKSHIELD KEY	850139	5013866059650	01/01/1900	current
1070/125 PT / 1	K2 LOCKSHIELD KEY	817020	5013866058448	01/01/1900	current
1070/125 PT / 1.1/4	K3 LOCKSHIELD KEY	850132	5013866059612	01/01/1900	current
1070/125 PT / 1.1/2	K5 LOCKSHIELD KEY	850134	5013866059629	01/01/1900	current
1070/125 PT / 2	K6 LOCKSHIELD KEY	850135	5013866059636	01/01/1900	current
1070/125 PT / 2.1/2	K6 LOCKSHIELD KEY	850135	5013866059636	01/01/1900	current
1070/125 PT / 3	K7 LOCKSHIELD KEY	850136	5013866059643	01/01/1900	current

## CARE & MAINTENANCE

### Care

No regular aesthetic care is required for this product

### Maintenance

A regular maintenance program is the most efficient method of ensuring longer term operational efficiency of the selected valve. Such a program would need to include a risk assessment and a planned procedure of how the maintenance will be carried out. The possibility of operational limits being exceeded and the potential hazards ensuring must be considered as part of this assessment. This should be implemented to include visual checks on the valve's condition and any development of unforeseen conditions, which could lead to failure. The correct fitting tools and equipment should be used for valve maintenance work. Separate means of draining the pipe work must be provided when carrying out any maintenance to valves. Where there may be any system debris this could be collected and /or filtered by installation of the appropriate protective device.

For further help please contact your local engineer.

If your product is under warranty please contact the Service Support Team on: 0800 1560050

## REGULATIONS

### Regulations

#### THE PRESSURE EQUIPMENT DIRECTIVE 97/23/EC and CE MARKING

The Pressure Equipment Regulations 1999 (SI 1999/2001) have now been introduced into United Kingdom law.

Valves with a maximum allowable pressure greater than 0.5 bar are covered by these new Regulations. Valves are categorised according to their maximum working pressure, size and rising level of hazard. The level of hazard varies according to the fluid being carried. Fluids are classified as Group 1, dangerous fluids or Group 2, all other fluids including steam. The Categories designated are SEP (sound engineering practice). Valves up to and including 25mm (1") are designated SEP regardless of the fluid group. Those identified as having increased hazard are Categorised as, I, II, III or IV. All valves designated as SEP do not bear the CE mark nor require a Declaration of Conformity. Categories I, II, III or IV carry the CE mark and require a Declaration of Conformity. Valves classified from the piping chart would not be included in Category IV.

## GUARANTEE

### Valves and Fittings

#### Pegler Yorkshire Customcare 5 Year Guarantee - Terms and Conditions

Products are subject to a 5 year guarantee that is between Pegler Yorkshire and the final purchaser of the product.

The guarantee is subject to proof of purchase being supplied.

This guarantee does not affect any statutory rights the consumer may have in law.

The guarantee covers manufacturing or material defects and does not cover parts subject to normal wear and tear.

This product range has been designed for the use of homeowners, domestic and commercial applications and therefore the guarantee is subject to the product being properly selected for their intended service conditions.

The guarantee is not applicable where the product is fitted contrary to the conditions in the fitting instructions.

This is reinforced where valves are covered by the European Pressure Equipment Directive (PED97/23/EC) where Installation, Operating and Maintenance Instructions are supplied with each product and/or carton.

Provided it is installed correctly and receives adequate preventative maintenance it should give years of trouble – free service.

Abusive behaviour and accidental damage to the product are not covered by this guarantee.

The extent of this liability is limited to the cost of the replacement of the defective item and not to fitting or consequential damages.



[WRAS 1070/125](#)

## Product Data Sheet: Valves Package THE PRESSURE EQUIPMENT DIRECTIVE 97/23/EC & CE MARKING

The Pressure Equipment Regulations 1999 (SI 1999/2001) have now been introduced into United Kingdom law. Valves within a maximum allowable pressure greater than 0.5 bar are covered by these new Regulations. Valves are categorised according to their maximum working pressure, size and rating level of hazard. The level of hazard varies according to the fluid being carried. Fluids are classified as Group 1 (dangerous fluids or Group 2, all other fluids including steam). The categories designated are SEP (sound engineering practice). Valves up to and including 250mm (1") are designated SEP (regardless of the fluid group). Those identified as having increased hazard are categorised as I, II, III or IV. All valves designated as SEP do not bear the CE mark, nor require a Declaration of Conformity. Categories I, II, III or IV carry the CE mark and require a Declaration of Conformity. Valves classified from the piping chart would not be included in Category IV.

### CE MARKING & THE ATEX Directive 94/9/EC

Concerning equipment and protection systems intended for use in potentially explosive atmospheres. This has been implemented in United Kingdom law by the Equipment and Protective Systems Intended for Use in Potentially Explosive Atmosphere Regulations 1996/31 1996/192 and amended by The Equipment and Protective Systems (Amendment) Regulations 2001 (SI2001/3766). The regulations apply to all valves where each valve: a) has its own potential source of ignition; b) operates in a potentially explosive atmosphere created by:

- the presence of gases, vapours, mists released from the valve through leakage;
- the presence of gases, vapours, mists released from the valve through leakage.

The regulations will not apply to a valve without a potential source of ignition, which operates in a dust free environment and the fluid being transported is cold, inert gas or non-flammable liquid. The requisite level of protection for valves not exempt from the regulations is defined as Group II category 2 and shall bear the following markings: (Ex) II GEP X

### VALVE SELECTION Selection, Storage & Protection

Valves must be properly selected for their intended service conditions. Provided it is installed correctly and receives adequate preventative maintenance it should give years of trouble-free service. They must be compatible with the system design, pressure and temperature requirements and must be suitable for the fluids that they are intended to carry. Interactions between parts in the pipe system and the valve must be considered as part of the valve selection.

Valves should be stored off the ground in a clean, dry, indoor area.

Where desiccant bags are included with the valve these should be changed after a period of 6 months.

Pegler valves are supplied in cardboard cartons or are bagged as appropriate and so adequate protection from damage is provided. When Pegler valves are fitted with pressure equipment or assemblies, suitable protective devices may be required.

### PRESSURE/TEMPERATURE RATING

Valves must be installed in a piping system whose normal pressure and temperature does not exceed the stated rating of the valve. The maximum allowable pressure in valves as specified in the standards is for non-stoppcock conditions. Water hammer and impact standards should also be avoided.

If system testing will subject the valve to pressures in excess of the working pressure, rating, this should be within the "shell test pressure" for the body, to a maximum of 1.5 times the PN rating and concluded with the valve fully opened. It may be hazardous to use these valves outside of their specified pressure and temperature limitations and also when not for the correct application.

### LOCATION/END-OF-LINE SERVICE

To ensure ease of operation, adjustment, maintenance and repair, valve siting should be decided during the system design phase. To prevent imposing strain on the valve seat, pipe work and valves they must be adequately supported. The 1022, 1070/125, 1065 and 1068 Gate valves are suitable for end of line service but we strongly recommend the fitting of a blanking plug to the downstream end of the valve. Pegler Ball, Globe, Check, Flanged and Lever Gate valves are not suitable for end-of-line service.

### INSTALLATION Health & Safety

Before starting work on any installation a risk assessment must be made to consider the possibility of operational limits being exceeded and reduction or elimination of any potential hazards. 1. Protective clothing and safety equipment must be utilised as appropriate to the hazard presented by the nature of the process to which the valve is being installed or maintained.

- Before installing or removing a valve the pipeline circulating pumps (when fitted) must be turned off. The pipeline must be de-pressurised, drained and vented. Valves must be fully opened to ensure release of any pipeline or valve pressure.
- Fitters must be trained in manual and mechanical handling to ensure release of any pipeline or valve pressure.
- Fitters must be trained in manual and mechanical handling to enable them to safely lift and install Pegler valves.
- The valve selected must be suitable for the required service conditions. The pressure and temperature limitations are indicated on the valve nomenclature, body or data plate. These must not be exceeded.
- Valve seats, seals and internal components can be damaged by system debris. Protective devices may need to be fitted and

system flushing may be required.

Any flushing fluid used to clean the pipeline must not cause any damage to the valve and its components.

### OPERATION

6. After flushing the valve should be closed to prevent any damage to the valve and its components.

### INSTALLATION

7. Pegler valves must not be misused by fitting them by their hand wheels, levers or stems.

### OPERATION

8. Pegler valves are not suitable for fatigue loading, creep conditions, fire testing, fire hazard environment, corrosive or erosive service, or for carrying fluids containing abrasive solids. There is no allowance for corrosion in the design of these valves. Designs for this valve do not allow for decomposition of unstable fluids and must not be used where this could occur.

9. Pegler valves are not designed to withstand the effects of fire, wind, earthquakes and traffic.

### INSTALLATION

10. All Health and Safety Rules must be followed when installing and maintaining valves.

### OPERATION

Unpack the valve and check that the flow paths and valve threads are clean and free from debris.

### INSTALLATION

Check the body markings and nomenclature to ensure that the correct valve has been selected for installation. Gate valves and globe valves may be fixed in "vertical pipe work with stem horizontal" or "horizontal pipe work with stem vertical and upright". Globe valves are marked with a directional flow arrow on the body. The valve will function correctly providing it is fitted so that the fluid transported follows the indicated flow direction. Make sure that a gate valve is fully closed during installation. Fitting a gate valve in the open position may cause twisting and the gate and seating may not mate properly. The valve should be operated from fully open to fully closed to test that it has been correctly installed.

The valve should not be installed in horizontal pipe work with stem horizontal because full closure may be hindered by an accumulation of system debris. Pegler Valves are manufactured to exacting standards and, therefore, should not be subjected to misuse. The following should be avoided: **Caress handling** (Valves should not be lifted using the hand wheel, lever or the stem).

### OPERATION

**Dirt and debris** entering the valve through the end ports. **Excessive force** during assembly and hand wheel operation. **Ball valves may be fixed in any orientation, always leaving enough space for the 90° operation of the lever handle.**

### OPERATION

**Horizontal and Vertical pattern check valves may be fitted in horizontal pipe work with the cap uppermost and vertically with the flow in an upwards direction.** The valve is marked with a directional flow arrow on the body. The valve will function correctly providing it is fitted so that the fluid transported follows the indicated flow direction. Check valves having 6 diameters of straight length of pipe upstream and 3 diameters downstream are suitable for velocities of 3 metres per second. If the valve is situated such that

non uniform or pulsating flow enters the valve, e.g. the valve is close to reciprocating pumps, then the velocity should not exceed 2 metres per second. Use suitable hangers close to both ends of the valve in order to remove stresses transmitted by the pipe. Confirm that the pipe threading length is correct to avoid excessive penetration of the pipe into the valve that would otherwise cause damage. Care should be taken to apply jointing compound to the pipe only and not in the valve threads. Surplus compound will then be forced outwards and will not enter the valve. Over use of compound can lead to valve failure on the body ends. Threads should be engaged correctly when tightening the valve onto the pipe. The wrench should always be fitted on the body end adjacent to the joint being made. Severe damage can occur to stems, valves and seats by the use of hand tools or levers larger than those originally supplied by the manufacturer, and by wheelkeys. Any electrical component e.g. actuators, limit switches must be explosion proof and comply with the ATEX Directive and Standards as listed in BS EN 1127-1 Clauses 6, 4.5.

### OPERATION

**Gate Valves** To open - an anti-clockwise rotation of the hand wheel will open the valve. When it will go no further return the hand wheel clockwise 1/2 turn. To close the valve a clockwise rotation of the hand wheel will close the valve. Closure will be confirmed when the handle can be turned no further. **Caution:** Service applications with extremes of temperature may cause the wedges to become tight in the valve. The valve may be become stiff to operate in these circumstances. Suitable hand protection applications. The valve should only be used in the fully open or fully closed position. Gate valves are not suitable for regulating and throttling service.

### OPERATION

**Globe Valves** To open - an anti-clockwise rotation of the hand wheel will open the valve. When it will go no further return the hand wheel clockwise 1/2 turn. To close the valve a clockwise rotation of the hand wheel will close the valve. Closure will be confirmed when the handle can be turned no further. **Caution:** Suitable hand protection should be worn when operating valves used in extreme temperature applications. Globe valves are not suitable for regulating and throttling service.

### OPERATION

**Check Valves** The Horizontal/vertical pattern check valves operate according to the flow within the pipeline and there is no external method of operation. **Ball Valves** **PB LEVER HANDLE** To open - turn the lever 90° so that it is in line

with the pipe run in which it is installed. To close - turn the lever 90° so that it is across the line of the pipe in which it is installed. Full closure and closing is completed when a full 90° is achieved and the lever is firmly set against the stop on the valve body.

### OPERATION

**PB T** Models have lockable handles for use in both open and closed positions. In the fully open position the T handle is in line with the pipe work. To lock the valve in the open position a hexagon key of the appropriate size can be used to remove the securing screw. The T handle can then be fitted from the valve. This should then be rotated through 180° and refitted on to the valve spring ensuring the handle slot engages on to the body lug. Insert the securing screw and re-tighten with the hexagon key.

### OPERATION

**PB EL** models are fitted with an extended spindle mechanism that lifts the lever away from the body and is particularly useful when pipe insulation is being used. This version is only available with a standard lever handle. **Caution:** Service applications with extremes of temperature may cause the ball to become tight in the valve. The valve may be become stiff to operate in these circumstances. Suitable hand protection should be worn when operating valves used in extreme temperature applications. The valve should only be used in the fully open or fully closed position. Ball valves are not suitable for regulating or throttling applications.

### OPERATION

**MAINTENANCE** A regular maintenance program is the most efficient method of ensuring longer term operational efficiency of the selected valve. Such a program would need to include a risk assessment and a planned procedure of how the maintenance will be carried out. The possibility of operational limits being exceeded and the potential hazards ensuring must be considered as part of this assessment. This should be implemented to include visual checks on the valve's condition and any development of unforeseen conditions, which could lead to failure. The correct fitting tools and equipment should be used for valve maintenance work. Separate means of draining the pipe work must be provided when carrying out any maintenance to valves. Where there may be any system debris this should be collected and/or filtered by installation of the appropriate protective device.

### OPERATION

**Gland Adjustment** - The gland may need adjustment during installation and then periodically thereafter to maintain a stem gland seal. **NOTE:** It is recommended that within the 1st year the gland be inspected at 3 monthly intervals to check for gland leakage. **Gland Replacement** - Under normal working conditions Pegler gland and globe valves do not normally require any maintenance, however, in the event of maintenance being necessary, the following procedure should be followed:

### OPERATION

Before starting work, de-pressurise the system, turn off any circulating pumps. Slacken the hand wheel nut and remove the nut, nomenclature and hand wheel. Remove the gland nut and gland ring. Using a suitable tool, lift out the existing packing and make sure the stem and stuffing box are clean & free from debris. Care must be taken not to damage the valve stem.

### OPERATION

**Fit a replacement Pegler packing gland into the stuffing box and push down firmly.** Re-assemble the gland ring and gland nut. Re-attach the handwheel, nomenclature and nut. Tighten the gland nut and confirm stem resistance while operating the valve. Once the pressure is re-established a check for leak tightness should be made, further adjust the gland nut as required necessary to achieve a satisfactory seal.

### OPERATION

**PB Permanent removal of the gland nut and for the Data Plate will invalidate the CE compliance of this valve. Pegler Ball valves and Check valves are generally NOT suitable for maintenance.** According to valve type, gland packing and valve discs may be replaced. Valves within the scope of the ATEX Directive with a protective level defined as Group I (category 2 will operate in Zone 1 (gases/vapours) or Zone 21 (dust) designated in BS1127-1 Explosion prevention and protection. Tools are either "single spark" e.g. screwdriver, spanner, impact screwdriver or "shower of sparks" e.g. sawing or grinding. Only steel "single spark" tools are permitted in Zones 1 & 21. Tools causing explosive atmosphere are only permissible if: a) no hazardous explosive atmosphere is present. b) dust deposits have been removed and no dust cloud is present. The use of tools on equipment in Zones 1 and 21 should be subject to a "permit to work" system.

### OPERATION

**1029 Renewable Valve Disc System.** Before starting work, de-pressurise the system, turn off any circulating pumps, and ensure the valve is empty of fluid. Using a suitable wrench remove the complete bonnet assembly from the valve. Care should be taken to ensure the gasket is held securely during this process so that there is no distortion to the valve threads. Any damage to the threads could lead to valve failure. Strichen and remove disc nut and disc. Assess damage to valve seat replacing the whole valve if necessary. The valve disc can be replaced with an equivalent size disc and type as appropriate. Re-attach a replacement disc and disc nut. Re-assemble the bonnet in to the valve body, checking for damage. Ensure the valve bonnet is joined securely to body and will not leak. NB. The 1029 Globe valves have non-metallic PTFE valve discs. **Installation, Operating & Maintenance Instructions are available from Sales Office.** Pegler recommended spares must be used. Refer to Pegler Technical Department for further information.

## PRODUCT LIFE SPAN

When a valve is properly selected for its service conditions it should give years of trouble-free service provided it is installed correctly and receives adequate preventative maintenance. By not considering the compatibility of the system design and the pressure and temperature requirements the life expectancy of the valves can be adversely affected and valve failure may occur. The nature of the fluid being carried through the valve could also affect the valve performance as this could lead to premature valve failure. There may also be interactions between metals in the pipe system and the valve which need to be considered. Appropriate flushing and cleaning of the pipe work installation should take place when commissioning the system as this would help extend the valve life.

### OPERATION

**Reference Material:** Pegler Valves Package Brochure, Pegler Spares Catalogue, and Spares Price list. A Technical File is held at Doncaster as part of the requirements for compliance to the European Pressure Equipment Directive (PED 97/23 EC).

### OPERATION

**MAINTAINING A POLICY OF CONTINUAL PRODUCT DEVELOPMENT PRESERVED RESERVES THE RIGHT TO CHANGE SPECIFICATION DESIGN AND MATERIALS OR PRODUCTS LISTED IN THIS LABELLET WITHOUT PRIOR NOTICE**

### OPERATION

**Head Office:** Pegler Limited, St Catherine's Avenue, Doncaster, South Yorkshire DN4 8DF England www.pegler.co.uk

### OPERATION

**UK Sales:** Northern Tel: 0870 1200281 Fax: 01302 560108 Southern Tel: 0870 1200282 Fax: 01302 560456 Western Tel: 0870 1200283 Fax: 01302 560109 uk.sales@pegler.co.uk

### OPERATION

**Export Sales:** Tel: 44 (0) 1302 855656 Fax: 44 (0) 1302 730513 export@pegler.co.uk



QUALITY • RELIABILITY • INNOVATION



QUALITY • RELIABILITY • INNOVATION

## Engineers Valves

## Installation, Operating & Maintenance Instructions

## Pressure Equipment Directive

## PED 97/23/EC Compliant

## A Watertight Guarantee Of Quality



**VALVE SUITABILITY**

Product	Steam	Water	Oil	Air	Gas Inert	Gas Condensable	Gas Corrosive	Gas Oxygen
P8700	✓	✓	✓	✓	✓	✓	✓	X
P8500 RED	✓	✓	✓	✓	X	X	X	X
P8500 YELLOW	✓	✓	✓	✓	✓	✓	✓	X
P8300 RED/BLUE	✓	✓	✓	✓	X	X	X	X
P8300 YELLOW	✓	✓	✓	✓	✓	✓	✓	X
P8100	X	✓	✓	✓	X	X	X	X
1065	X	✓	✓	✓	X	X	X	X
1068	✓	✓	✓	✓	X	X	X	X
1072	✓	✓	✓	✓	X	X	X	X
1070/125	✓	✓	✓	✓	X	X	X	X
P81M	✓	✓	✓	✓	X	X	X	X
63	X	✓	✓	✓	X	X	X	X
GMS3	X	✓	✓	✓	X	X	X	X
1029	✓	✓	✓	✓	✓	✓	✓	X
1031	✓	✓	✓	✓	X	X	X	X
1039	✓	✓	✓	✓	X	X	X	X
1060A	✓	✓	✓	✓	X	X	X	X
1062	✓	✓	✓	✓	X	X	X	X
1063	X	✓	✓	✓	X	X	X	X
1064	X	✓	✓	✓	X	X	X	X
1832	X	✓	✓	✓	X	X	X	X
833GM, GM LS	X	✓	✓	✓	X	X	X	X

\* Pressure limited to 10 bar for Air & Gas applications. \*\* Pressure limited to 5 bar for Air applications.

**Thread Depths (mm)**

Product	1/4"	3/8"	1/2"	3/4"	1"	1.1/4"	1.1/2"	2"	2.1/2"	3"	4"
P8700	11.5	11.9	15.4	16.7	19.4	21.7	21.4	26.0	30.5	33.5	39.5
P8500 RED	11.5	11.9	15.4	16.7	19.4	21.7	21.4	26.0	30.5	33.5	39.5
P8500 YELLOW	11.5	11.9	15.4	16.7	19.4	21.7	21.4	26.0	30.5	33.5	39.5
P8300 RED/BLUE	-	-	-	-	-	-	-	-	-	-	-
P8300 YELLOW	-	-	-	-	-	-	-	-	-	-	-
P8100	-	-	12.7	14.0	16.2	18.5	18.5	22.8	-	-	-
1065	-	-	12.7	14.0	16.1	18.5	18.5	22.8	-	-	-
1068	-	-	15.0	16.3	19.1	21.4	21.4	25.7	30.2	33.3	39.3
1072	-	-	15.0	16.3	19.1	21.4	21.4	25.7	-	-	-
1070/125	11.4	11.4	15.0	16.3	19.1	21.4	21.4	25.7	30.2	33.3	39.3
P81M	-	-	-	-	-	-	-	-	-	-	-
63	-	-	-	-	-	-	-	-	-	-	-
GMS3	-	-	-	-	-	-	-	-	-	-	-
1029	7.5	7.9	9.9	11.1	12.3	14.3	14.3	18.2	19.8	22.6	-
1031	-	-	9.9	11.1	12.3	14.3	14.3	18.2	-	-	-
1039	-	-	9.9	11.1	12.3	14.3	14.3	18.2	-	-	-
1060A	-	-	15.0	16.3	19.1	21.4	21.4	25.7	25.0	33.0	33.0
1062	-	-	15.9	16.7	19.0	-	-	-	-	-	-
1063	-	10.3	12.8	14.2	15.0	15.2	16.4	17.2	19.8	26.0	26.6
1064	-	10.3	12.8	14.2	15.0	15.2	16.4	17.2	19.8	26.0	26.6
1832	-	-	-	-	-	-	-	-	-	-	-
833GM, GM LS	-	-	-	-	-	-	-	-	-	-	-

**OPERATIONAL LIMITS**

Product	PN	Non-Shock Pressure @ Temp. Range	Non-Shock Pressure @ Max. Range
P8700	40*	40 Bar - 10°C to 110°C	10 Bar at 180°C
P8500 RED	25	25 Bar - 10°C to 100°C	16.5 Bar at 150°C
P8500 YELLOW	25*	25 Bar - 10°C to 100°C	16.5 Bar at 150°C
P8300 RED/BLUE	16	16 Bar - 10°C to 30°C	5 Bar at 120°C
P8300 YELLOW	16*	16 Bar - 10°C to 30°C	5 Bar at 120°C
P8100	25	25 Bar - 10°C to 100°C	4 Bar at 120°C
1065	17.5	17.5 Bar - 0°C to 25°C	17.5 Bar at 93°C
1068	20	20 Bar - 10°C to 100°C	9 Bar at 180°C
1072	32	32 Bar - 10°C to 100°C	14 Bar at 198°C
1070/125	20	20 Bar - 10°C to 100°C	9 Bar at 180°C
P81M	16	20 Bar - 10°C to 100°C	9 Bar at 180°C
63	16	16 Bar - 10°C to 30°C	5 Bar at 120°C
GMS3	16	16 Bar - 10°C to 30°C	5 Bar at 120°C
1029	32*	32 Bar - 10°C to 100°C	14 Bar at 198°C
1031	32	32 Bar - 10°C to 100°C	14 Bar at 198°C
1039	32	32 Bar - 10°C to 100°C	14 Bar at 198°C
1060A	25	25 Bar - 10°C to 100°C	10.5 Bar at 186°C
1062	25	25 Bar - 10°C to 100°C	10.5 Bar at 186°C
1063	8 - 12	0°C to 90°C	90°C
1064	8 - 12	0°C to 90°C	90°C
1832	10	10 Bar - 0°C to 120°C	10 Bar at 120°C
833GM, GM LS	10	20 Bar - 10°C to 100°C	13 Bar at 120°C

\* 10 bar for Gas

**PED Categorisation Table**

Product	1/4"	3/8"	1/2"	3/4"	1"	1.1/4"	1.1/2"	2"	2.1/2"	3"	4"
P8700	S.E.P	S.E.P	S.E.P	S.E.P	S.E.P	Cat 1	Cat 1	Cat 1	Cat 1	Cat 1	Cat 1
P8500 RED	S.E.P	S.E.P	S.E.P	S.E.P	S.E.P	S.E.P	S.E.P	S.E.P	S.E.P	S.E.P	S.E.P
P8500 YELLOW	S.E.P	S.E.P	S.E.P	S.E.P	S.E.P	Cat 1	Cat 1	Cat 1	Cat 1	Cat 1	Cat 1
P8300 RED/BLUE	-	-	-	-	-	-	-	-	-	-	-
P8300 YELLOW	-	-	-	-	-	-	-	-	-	-	-
P8100	-	-	-	-	-	-	-	-	-	-	-
1065	-	-	-	-	-	-	-	-	-	-	-
1068	-	-	-	-	-	-	-	-	-	-	-
1072	-	-	-	-	-	-	-	-	-	-	-
1070/125	S.E.P	S.E.P	S.E.P	S.E.P	S.E.P	S.E.P	S.E.P	S.E.P	S.E.P	S.E.P	S.E.P
P81M	-	-	-	-	-	-	-	-	-	-	-
63	-	-	-	-	-	-	-	-	-	-	-
GMS3	-	-	-	-	-	-	-	-	-	-	-
1029	S.E.P	S.E.P	S.E.P	S.E.P	S.E.P	Cat 1	Cat 1	Cat 1	Cat 2	Cat 2	-
1031	-	-	-	-	-	-	-	-	-	-	-
1039	-	-	-	-	-	-	-	-	-	-	-
1060A	-	-	-	-	-	-	-	-	-	-	-
1062	-	-	-	-	-	-	-	-	-	-	-
1063	-	-	-	-	-	-	-	-	-	-	-
1064	-	-	-	-	-	-	-	-	-	-	-
1832	-	-	-	-	-	-	-	-	-	-	-
833GM, GM LS	-	-	-	-	-	-	-	-	-	-	-

Category 1 and Category 2 carry the CE mark