

MATCHMATE RANGE

FEATURES

Myson Matchmaster 10 BAR radiator valves

- Maximum operating pressure 10 BAR
- Pressure tested in accordance with BS2767
- Available in nickel or satin brass finish
- Available with drain-off facility
- Graphite Gland Packing

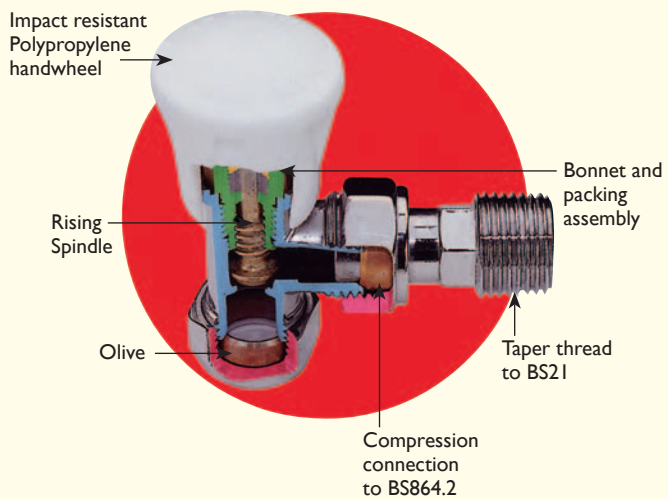
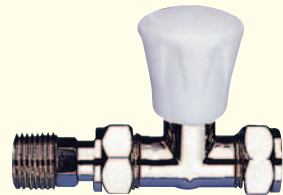
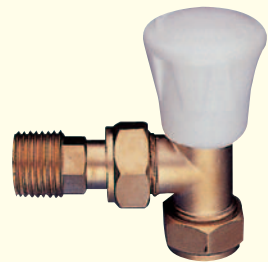
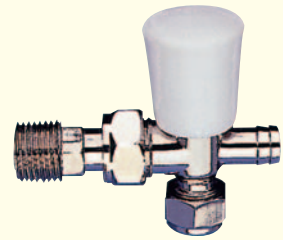

RANGE

ORDER CODE

MATCHMASTER (10 BAR RATED)	WHEELHEAD	LOCKSHIELD
8mm Angle Brass	MM8 WAB	MM8 LAB
10mm Angle Brass	MM10 WAB	MM10 LAB
15mm Angle Brass	MM15 WAB	MM15 LAB
8mm Angle Nickel	MM8 WAN	MM8 LAN
10mm Angle Nickel	MM10 WAN	MM10 LAN
15mm Angle Nickel	MM15 WAN	MM15 LAN
8mm Angle Brass with Drain Off	–	MM8 LABD
10mm Angle Brass with Drain Off	–	MM10 LABD
15mm Angle Brass with Drain Off	–	MM15 LABD
8mm Angle Nickel with Drain Off	–	MM8 LAND
10mm Angle Nickel with Drain Off	–	MM10 LAND
15mm Angle Nickel with Drain Off	–	MM15 LAND
15mm Straight Brass	MM15 WSB	MM15 LSB
15mm Straight Nickel	MM15 WSN	MM15 LSN

MATCHMATE RANGE

SPECIFICATION

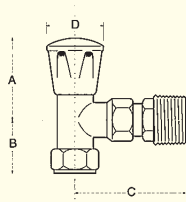

8/10/15mm Angle wheelhead

A	B	C	D
50.4	28.0	58.0	37.0

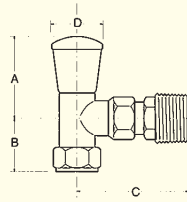

8/10/15mm Angle lockshield

A	B	C	D
54.0	28.0	58.0	32.2

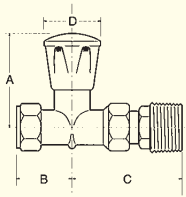

15mm Straight wheelhead

A	B	C	D
60.5	30.5	58.0	37.0

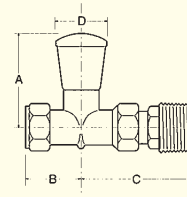

15mm Straight lockshield

A	B	C	D
60.5	30.5	58.0	32.2

PERFORMANCE

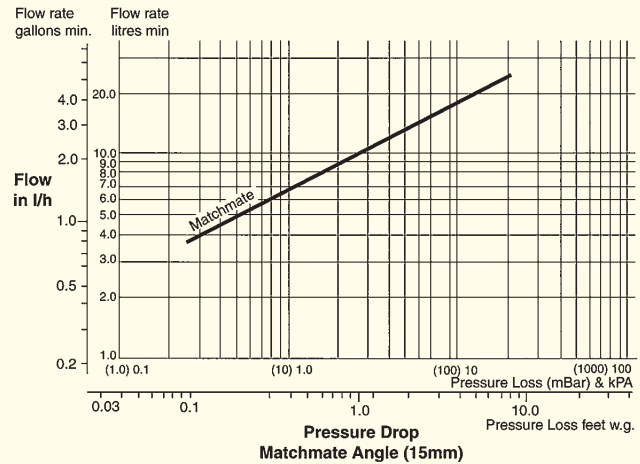

MATCHMATE WITH DRAIN-OFF FACILITY

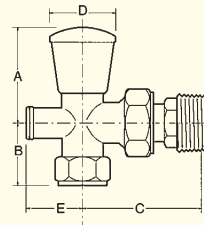
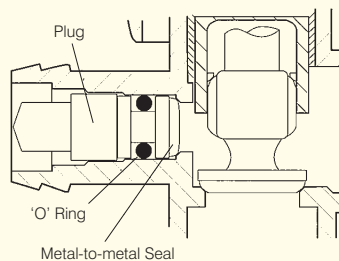

A	B	C	D	E
54.0	28.0	58.0	32.2	28.0

FEATURES

- Maximum operating pressure 10 BAR
- Tested in accordance with BS 2767
- Tamperproof plug
- Double seal (metal-to-metal and 'O'-ring)
- Available in brass and nickel
- Sizes 15mm, 10mm and 8mm

OPERATION

- Close radiator valves
- Place drip tray under Drain-Off
- Release air from radiator, close air vent
- Remove plug using air vent key
- Fit hosepipe or use a suitable receptacle
- Open air vent in radiator. (Note: The flow from the Drain-Off can be stopped by closing air vent)
- When Drain-Off is completed close air vent and replace plug