

# FULLFLOW RANGE

## FEATURES

- Maximum operating pressure 10 BAR
- Maximum water temperature 120°C
- Conforms to BS 2767-10
- Available in polished chrome or satin brass finish
- One valve for copper or iron pipes –  
15mm : 1/2" ; 22mm : 3/4"
- Double 'O'-Ring seal and non-rising spindle
- 'O'-Ring seal on union guarantees water tight seal
- Available with drain-off facility

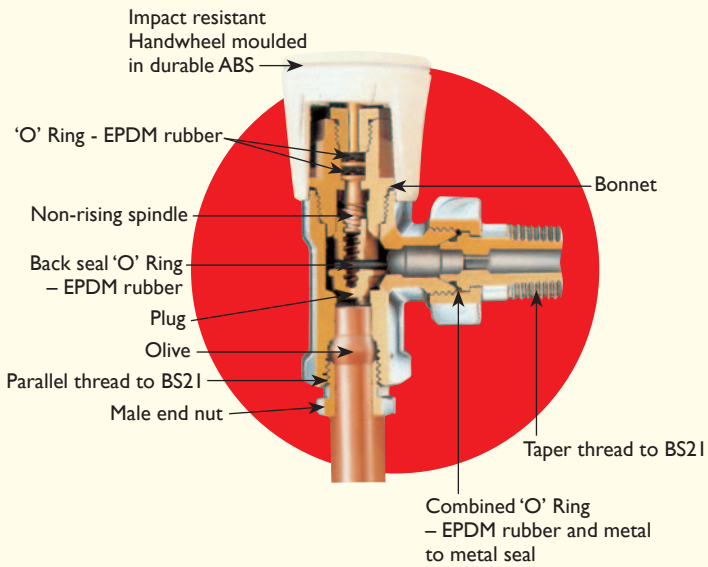
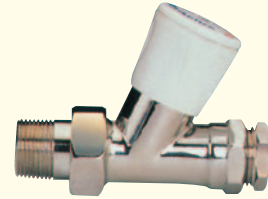
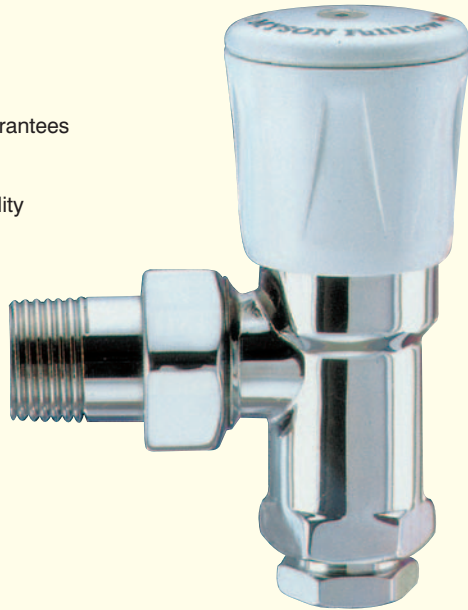

2 TRV 15 AN  
with 2 TRV HEAD  
Commercial TRV 2-way  
to match Fullflow Range.  
Please see pages 5 and 6.

RANGE		
	ORDER CODE	
FULLFLOW (BS 2767-10)	WHEELHEAD	LOCKSHIELD
15mm 1/2" Angle Brass	FF15 WAB	FF15 LAB
15mm 1/2" Angle Chrome	FF15 WAC	FF15 LAC
15mm 1/2" Straight Brass	FF15 WSB	FF15 LSB
15mm 1/2" Straight Chrome	FF15 WSC	FF15 LSC
22mm 3/4" Angle Brass	FF22 WAB	FF22 LAB
22mm 3/4" Angle Chrome	FF22 WAC	FF22 LAC
22mm 3/4" Straight Brass	FF22 WSB	FF22 LSB
22mm 3/4" Straight Chrome	FF22 WSC	FF22 LSC
15mm 1/2" Straight Brass with Drain Off		FF15 LABD
15mm 1/2" Angle Chrome with Drain Off		FF15 LACD

# FULLFLOW RANGE

## SPECIFICATION

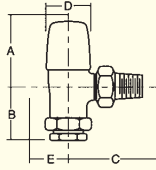
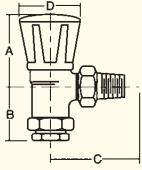

Wheelhead Straight Valve

	A	B	C	D
15mm / 1/2"	55.0	39.0	54.8	40.0
22mm / 3/4"	56.0	45.2	61.1	40.0

Lockshield Straight Valve

	A	B	C	D	E
15mm / 1/2"	52.5	39.0	54.8	34.0	30.0
22mm / 3/4"	53.5	45.2	61.1	34.0	-

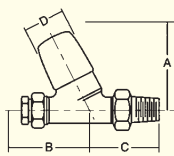
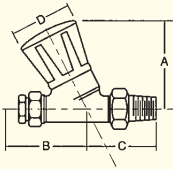

Wheelhead Straight Valve

	A	B	C	D
15mm / 1/2"	69.0	47.0	47.8	40.0
22mm / 3/4"	72.1	54.5	54.1	40.0

Lockshield Straight Valve

	A	B	C	D
15mm / 1/2"	62.0	47.0	47.8	34.0
22mm / 3/4"	65.1	54.5	54.1	34.0

## PERFORMANCE

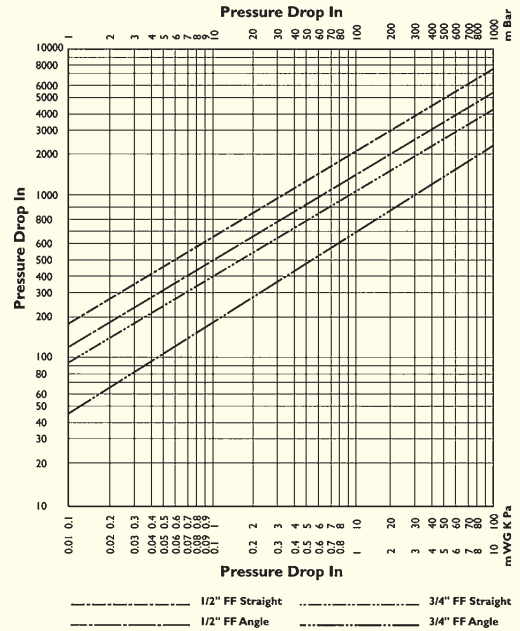

## FULLFLOW WITH DRAIN-OFF FACILITY

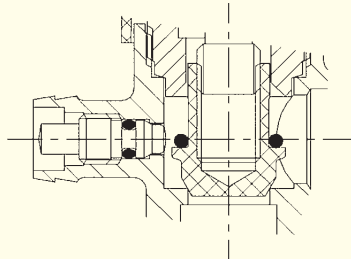

## FEATURES

- Maximum operating pressure 10 BAR
- Tested in accordance with BS2767
- Tamperproof plug
- Double seal (metal-to-metal and 'O'-ring)
- Available in brass and chrome
- Sizes 15mm, 22mm

## OPERATION

- Close radiator valves
- Place drip tray under Drain-Off
- Release air from radiator, close air vent
- Remove plug using air vent key
- Fit hosepipe or use a suitable receptacle
- Open air vent in radiator. (Note: The flow from the Drain-Off can be stopped by closing air vent)
- When Drain-Off is completed close air vent and replace plug