



UNVENTED CYLINDERS 100 TO 500 LITRES



Maximum hot water, minimum fuss



Being able to turn on any tap in the home and get hot and cold water at mains pressure is something that we would all love to have. With the highly innovative range of Ariston unvented cylinders - this is now a reality. Feeding all the home's taps directly from the incoming cold water main removes the need for a cold water storage tank in the loft, freeing up the space, eliminating the risk of freezing pipes and providing many other benefits.

Unvented systems have been widely used across the world for decades, and started becoming increasingly popular in the UK over 20 years ago. Nowadays, they account for approaching half of all new hot water storage systems with installations increasing by 20% per year.

To ensure that our products meet the changing needs of our customers we undertake continuous research into new technologies and design; as is demonstrated by the current range of Ariston unvented cylinders.

These versatile water heaters are either wall mounted (50 litres – 100 litres) or floor standing (100 litres – 500 litres). They can be heated either directly by electricity or indirectly by an additional heat source e.g. gas or oil. The 100l – 210l floor standing cylinders, at just 550mm wide, boast low heat loss. And, with all the connections accessible from the front, they can be readily fitted in the tightest of spaces. As part of our ongoing commitment to the environment, Ariston has developed a range of twin coil (solar compatible) cylinders - 200, 250 and 300 litres capacity.

1 traditional open-vent system

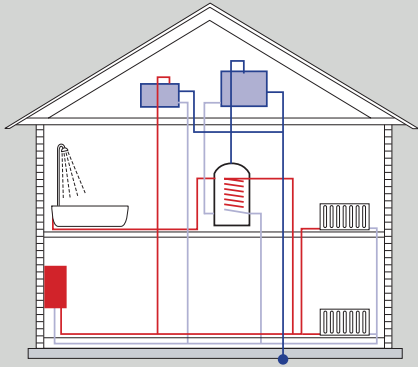

2 unvented indirect & sealed heating systems

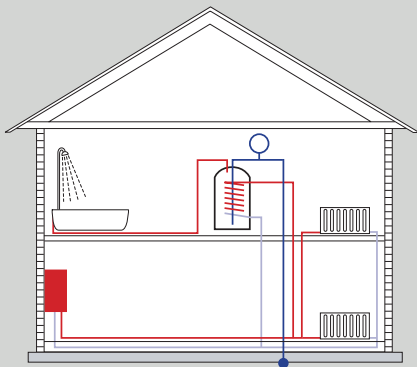

3 unvented direct system & electric space heating

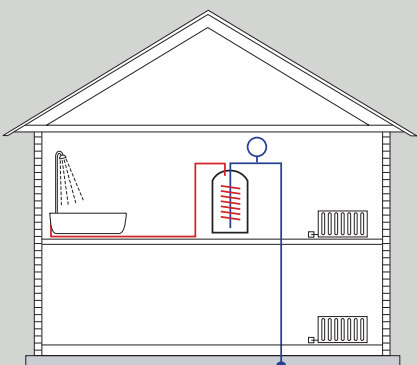

Advantages of an unvented system

- Hot and cold water supply to all outlets at mains pressure
- Drinking water at all cold water outlets, as water is supplied directly from the incoming mains water pipe
- Good shower flow and pressure without the need for pumps
- High performance, energy efficient and quiet operation
- Balanced hot and cold water supply giving wider choice of taps and fittings
- No storage tank in the loft freeing up potentially valuable loft space and removing the risk of:
 - Water stagnation
 - Frost damage to pipes
- Lower insurance premiums due to the absence of stored water in the loft
- Greater system design and flexibility
- Simpler plumbing system – less pipework, less time, less cost

CLASSICO HE

DIRECT: STD 125, 150, 210, 300

HIGH EFFICIENCY FLOOR STANDING
DIRECT UNVENTED CYLINDERS



SLIM



ENAMELLED
STEEL TANK

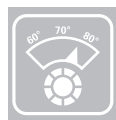

TEMPERATURE
REGULATION



ENVIRONMENTALLY
FRIENDLY
INSULATION

- QUALITY STEEL TANK, 12 BAR PRESSURE TESTED AND EXCLUSIVE VITREOUS ENAMEL COATING (GLASS LINING)
- ENVIRONMENTALLY SOUND AND HIGHLY EFFICIENT THERMAL INSULATION
- ALL PLUMBING AND ELECTRICAL CONNECTIONS WITHIN A 90° ANGLE
- MAGNESIUM ANODE TO PROTECT AGAINST CORROSION

- IMMERSION HEATERS SUPPLIED WITH REGULATION THERMOSTATS AND DUAL POLE THERMAL CUT-OUTS
- FACTORY FITTED 1/2" T&P RELIEF VALVE
- UNVENTED CONTROL KIT SUPPLIED WITH CYLINDER
- SIMPLE INSTALLATION
- 5 YEAR TANK GUARANTEE (2 YEAR GUARANTEE ON ELECTRICAL COMPONENTS)

Technical data - Overall dimensions

Model Product Code		STD 125 HE 3060267	STD 150 HE 3060268	STD 210 HE 3060269	STD 300 HE 3060270
Nominal capacity	l	125	150	200	300
Weight empty	kg	42	49	54	94
Weight full	kg	167	199	254	394
Voltage	V	240	240	240	240
Power	kW	3+3	3+3	3+3	3+3
Reheat time* (ΔT= 45°C)	min.	131	171	229	339
Reheat time** (ΔT= 45°C)	min.	99	130	184	255
Max. Working Temp.	°C	70	70	70	70
Typical application***		D	E	F	G

	STD 125 HE	STD 150 HE	STD 210 HE	STD 300 HE
a mm	666	806	956	1199
b mm	763	921	1237	1540
c mm	1024	1182	1498	1792
d mm	550	550	550	600
e mm	281	281	281	259

* Based on single heating element 100% capacity
** Based on single heating element 70% capacity

***Typical application
• D: domestic usage <3 people (kitchen, shower)
• E: domestic usage 3/4 people (kitchen, bathroom + shower)

• F: domestic usage 4/5 people (kitchen, 2 bathrooms)
• G: domestic usage 5 people (kitchen, 2 bathrooms + shower)

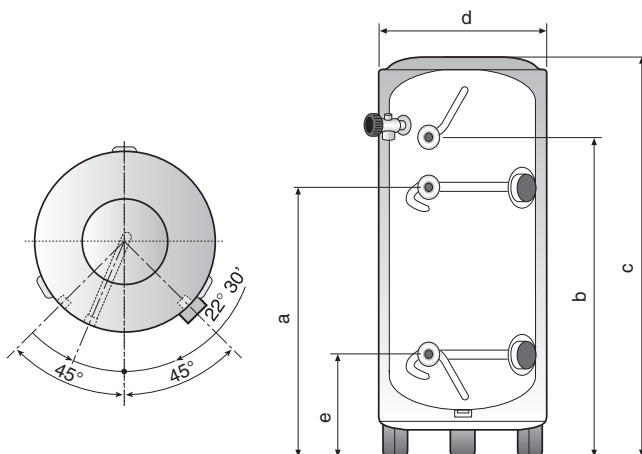

CLASSICO HE

INDIRECT: STI 125,
150, 210, 300, 500

HIGH EFFICIENCY FLOOR STANDING
INDIRECT UNVENTED CYLINDERS



SLIM



ENAMELLED
STEEL TANK

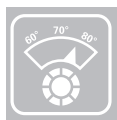

TEMPERATURE
REGULATION



ENVIRONMENTALLY
FRIENDLY
INSULATION

- QUALITY STEEL TANK, 12 BAR PRESSURE TESTED AND EXCLUSIVE VITREOUS ENAMEL COATING (GLASS LINING)
- ENVIRONMENTALLY SOUND AND HIGHLY EFFICIENT THERMAL INSULATION
- ALL PLUMBING AND ELECTRICAL CONNECTIONS WITHIN A 90° ANGLE
- MAGNESIUM ANODE TO PROTECT AGAINST CORROSION
- IMMERSION HEATER SUPPLIED WITH REGULATION THERMOSTAT AND DUAL POLE THERMAL CUT-OUT

- CYLINDER THERMOSTAT WITH EXTERNAL REGULATION
- UNIQUE COIL DESIGN ALLOWS FULL QUANTITY OF WATER TO BE HEATED
- FACTORY FITTED 1/2" T&P RELIEF VALVE
- UNVENTED CONTROL KIT SUPPLIED WITH CYLINDER
- SIMPLE INSTALLATION
- 5 YEAR TANK GUARANTEE (2 YEAR GUARANTEE ON ELECTRICAL COMPONENTS)



Technical data - Overall dimensions

Model		STI 125 HE	STI 150 HE	STI 210 HE	STI 300 HE	STI 500 HE		STI 125 HE	STI 150 HE	STI 210 HE	STI 300 HE	STI 500 HE
Product Code		3060271	3060272	3060273	3060274	3060276						
Nominal capacity	l	125	150	200	300	495	a mm	666	806	956	1199	1390
Weight empty	kg	49	58	63	103	146	b mm	763	921	1237	1540	335
Weight full	kg	164	208	363	403	641	c mm	1024	1182	1498	1792	1870
Indirect coil rating	kW	21.6	18.2	23.6	21.2	31.8	d mm	641	781	781	784	700
Coil surface area	m ²	0.65	0.84	0.84	0.84	1.5	e mm	550	550	550	600	714
Reheat time* (ΔT= 45°C)	min.	18	21	28	47	54	f mm	281	281	281	259	-
Reheat time** (ΔT= 45°C)	min.	16	19	25	38	-	g mm	241	241	241	244	-
Voltage	V	240	240	240	240	240/415						
Power	kW	3	3	3	3	6						
Immersion reheat (ΔT= 45°C)	min.	131	171	229	339	290						
Max. temperature.	°C	70	70	70	70	70						
Typical application***	E	F	G	H	H/I							

* Heated to 100% capacity
** Heated to 70% capacity
(Tests in accordance with BS EN 12897:2006)

***Typical application
• E: domestic usage 3/4 people (kitchen, shower)
• F: domestic usage 4/5 people (kitchen, 2 bathrooms)

• G: domestic usage 5 people and above (kitchen, 2 bathrooms + shower)
• H: above average household use
• I: light commercial use

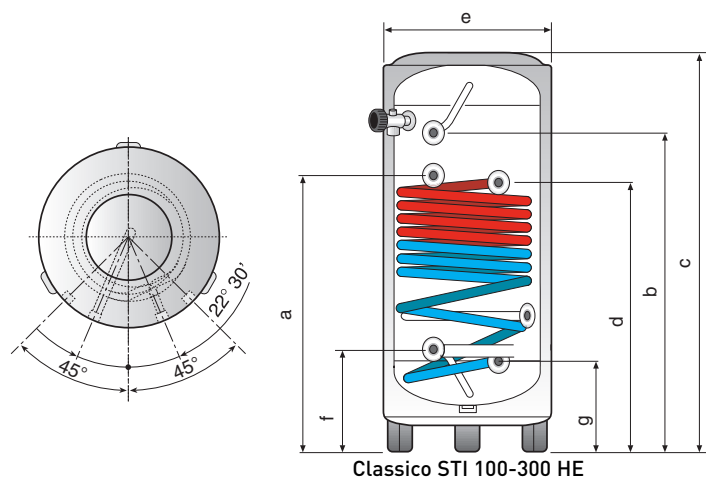

Classico STI 100-300 HE

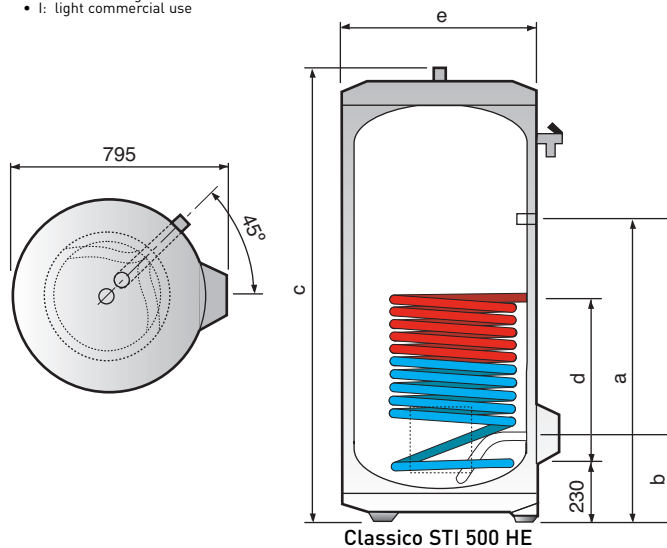

Classico STI 500 HE

PRIMO HE

DIRECT: ITD 125, 150, 210, 300

HIGH EFFICIENCY FLOOR STANDING
DIRECT UNVENTED CYLINDERS

25 25 year
guarantee



SLIM



STAINLESS
STEEL TANK

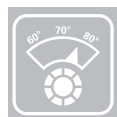

TEMPERATURE
REGULATION



ENVIRONMENTALLY
FRIENDLY
INSULATION

- QUALITY STAINLESS STEEL TANK, 12 BAR PRESSURE TESTED
- ENVIRONMENTALLY SOUND AND HIGHLY EFFICIENT THERMAL INSULATION
- ALL PLUMBING AND ELECTRICAL CONNECTIONS WITHIN A 90° ANGLE
- EXCLUSIVE HIGH QUALITY 'ORANGE-PEEL' OUTER FINISH
- IMMERSION HEATERS SUPPLIED WITH REGULATION THERMOSTAT AND DUAL POLE THERMAL CUT-OUT

- FACTORY FITTED 1/2" T&P RELIEF VALVE
- UNVENTED CONTROL KIT SUPPLIED WITH CYLINDER
- SIMPLE INSTALLATION
- 25 YEAR TANK GUARANTEE (2 YEAR GUARANTEE ON ELECTRICAL COMPONENTS)

Technical data - Overall dimensions

Model		ITD 125 HE	ITD 150 HE	ITD 210 HE	ITD 300 HE
Product Code		3060252	3060253	3060254	3060255
Nominal capacity	l	125	150	200	300
Weight empty	kg	30	32	43	56
Weight full	kg	155	182	243	356
Voltage	V	240	240	240	240
Power	kW	3+3	3+3	3+3	3+3
Reheat time* (ΔT= 45°C)	min.	131	171	229	339
Reheat time** (ΔT= 45°C)	min.	99	130	184	255
Max. Working Temp.	°C	70	70	70	70
Typical application***		D	E	F	G

* Based on single heating element 100% capacity
** Based on single heating element 70% capacity
(Tests in accordance with BS EN 12897:2006)

***Typical application
• D: Domestic usage <3 people (kitchen/shower)
• E: Domestic usage 3/4 people (kitchen, bathroom + shower)

	ITD 125 HE	ITD 150 HE	ITD 210 HE	ITD 300 HE
a mm	666	806	956	1199
b mm	763	921	1237	1540
c mm	1024	1182	1498	1792
d mm	550	550	550	600
e mm	281	281	281	259

• F: Domestic usage 4/5 people (kitchen, 2 bathrooms)
• G: Domestic usage 5 people and above (kitchen, 2 bathrooms + shower)

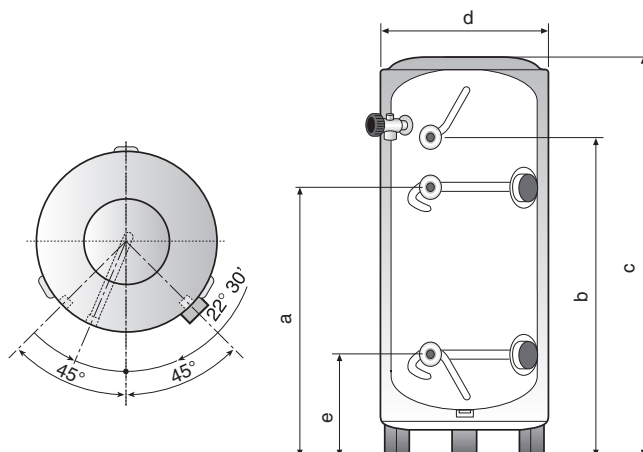

PRIMO HE

INDIRECT: ITI 100, 125, 150, 210, 250, 300

HIGH EFFICIENCY FLOOR STANDING
INDIRECT UNVENTED CYLINDERS

25 25 year
guarantee



SLIM



STAINLESS
STEEL TANK

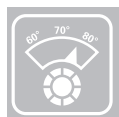

TEMPERATURE
REGULATION



ENVIRONMENTALLY
FRIENDLY
INSULATION

- QUALITY STAINLESS STEEL TANK, 12 BAR PRESSURE TESTED.
- ENVIRONMENTALLY SOUND AND HIGHLY EFFICIENT THERMAL INSULATION
- ALL PLUMBING AND ELECTRICAL CONNECTIONS WITHIN A 90° ANGLE
- EXCLUSIVE HIGH QUALITY 'ORANGE-PEEL' OUTER FINISH
- IMMERSION HEATER SUPPLIED WITH REGULATION THERMOSTAT AND DUAL POLE THERMAL CUT-OUT

- CYLINDER THERMOSTAT WITH EXTERNAL REGULATION
- UNIQUE COIL DESIGN ALLOWS FULL QUANTITY OF WATER TO BE HEATED
- FACTORY FITTED 1/2" T&P RELIEF VALVE
- UNVENTED CONTROL KIT SUPPLIED WITH CYLINDER
- SIMPLE INSTALLATION
- 25 YEAR TANK GUARANTEE (2 YEAR GUARANTEE ON ELECTRICAL COMPONENTS)



Technical data - Overall dimensions

Model		ITI 100 HE	ITI 125 HE	ITI 150 HE	ITI 210 HE	ITI 250 HE	ITI 300 HE		ITI 100 HE	ITI 125 HE	ITI 150 HE	ITI 210 HE	ITI 250 HE	ITI 300 HE
Product Code		3060256	3060257	3060259	3060260	3060266	3060261							
Nominal capacity	L	100	125	150	200	250	300	a mm	508	666	806	956	964	1199
Weight empty	kg	28	35	37	48	55	61	b mm	605	763	921	1237	1305	1540
Weight full	kg	128	160	187	248	305	361	c mm	863	1024	1182	1498	1600	1792
Indirect coil rating	kW	13.2	21.6	18.2	23.6	23.1	21.2	d mm	571	641	781	781	784	784
Coil surface area	m ²	0.5	0.67	0.8	0.9	0.9	0.9	e mm	550	550	550	550	600	600
Reheat time* (ΔT= 45°C)	min.	17	18	21	28	33	47	f mm	281	281	281	281	259	259
Reheat time** (ΔT= 45°C)	min.	15	16	19	25	32	38	g mm	241	241	241	241	244	244
Voltage	V	240	240	240	240	240	240							
Power	kW	3	3	3	3	3	3							
Immersion reheat †	min.	112	131	171	229	289	339							
Max. temperature.	°C	70	70	70	70	70	70							
Typical application***	D	E	F	G	G/H	H								

* Heated to 100% capacity

** Heated to 70% capacity

† Based on single heating element to 100% capacity

(Tests in accordance with BS EN 12897:2006)

***Typical application

• D: Domestic usage <3 people (kitchen, shower)

• E: Domestic usage 3/4 people (kitchen, bathroom and shower)

• F: Domestic usage 4/5 people (kitchen, 2 bathrooms)

• G: Domestic usage 5 people and above (kitchen, 2 bathrooms and shower)

• H: Above average household use

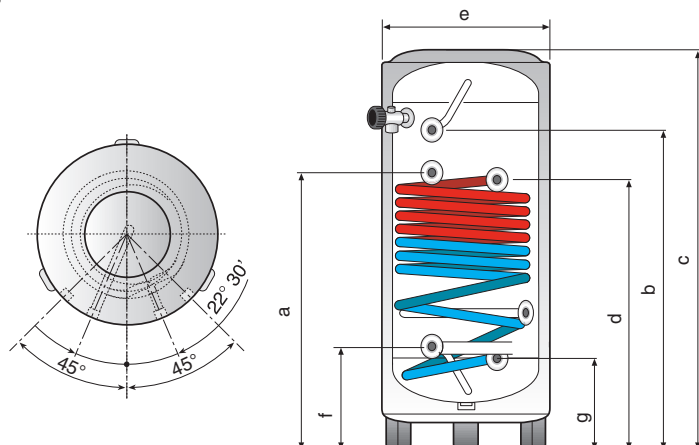

PRIMO TWIN HE

INDIRECT TWIN COIL: ITSI 210, 250, 300

HIGH EFFICIENCY FLOOR STANDING SOLAR
COMPATIBLE UNVENTED CYLINDERS

25 25 year
guarantee



SLIM

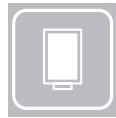

STAINLESS
STEEL TANK

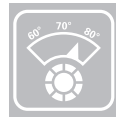

TEMPERATURE
REGULATION



ENVIRONMENTALLY
FRIENDLY
INSULATION

- QUALITY STAINLESS STEEL TANK, 12 BAR PRESSURE TESTED
- ENVIRONMENTALLY SOUND AND HIGHLY EFFICIENT THERMAL INSULATION
- ALL PLUMBING AND ELECTRICAL CONNECTIONS WITHIN A 90° ANGLE
- EXCLUSIVE HIGH QUALITY 'ORANGE-PEEL' OUTER FINISH
- TWIN INDIRECT COILS FOR DUAL HEAT SOURCE APPLICATIONS
- TWIN IMMERSION HEATERS SUPPLIED WITH REGULATION THERMOSTAT AND DUAL POLE THERMAL CUT-OUT

- CYLINDER THERMOSTATS WITH EXTERNAL REGULATION
- UNIQUE COIL DESIGN ALLOWS FULL QUANTITY OF WATER TO BE HEATED
- FACTORY FITTED 1/2" T&P RELIEF VALVE
- UNVENTED CONTROL KIT SUPPLIED WITH CYLINDER
- SIMPLE INSTALLATION
- 25 YEAR TANK GUARANTEE (2 YEAR GUARANTEE ON ELECTRICAL COMPONENTS)

Technical data - Overall dimensions

Model		ITSI 210 HE	ITSI 250 HE	ITSI 300 HE		ITSI 210 HE	ITSI 250 HE	ITSI 300 HE
Product Code		3060263	3060264	3060265				
Nominal capacity	l	200	250	300	a mm	956	964	1199
Weight empty	kg	53	60	66	b mm	241	244	244
Weight full	kg	253	310	366	c mm	1498	1600	1792
Indirect coil rating (top)	kW	17.0	17.0	20.9	d mm	641	644	784
Indirect coil rating (bottom)	kW	19.5	19.5	21.9	e mm	550	600	600
Coil surface area (top)	m ²	0.67	0.67	0.67	f mm	281	259	259
Coil surface area (bottom)	m ²	0.67	0.67	0.89	g mm	822	865	1100
Indirect reheat time* (ΔT= 45°C)	min.	36	42	47	h mm	1222	1265	1500
Indirect reheat time** (ΔT= 45°C)	min.	30	34	37	i mm	1237	1305	1540
Voltage	V	240	240	240				
Power	kW	3+3	3+3	3+3				
Immersion reheat time*** (ΔT= 45°C)	min.	227	271	310				
Max. temperature.	°C	70	70	70				

* Based on bottom coil only to 100% capacity (Tests in accordance with BS EN 12897:2006)

** Based on bottom coil only to 70% capacity (Tests in accordance with BS EN 12897:2006)

*** Based on single heating element to 100% capacity (Tests in accordance with BS EN 12897:2006)

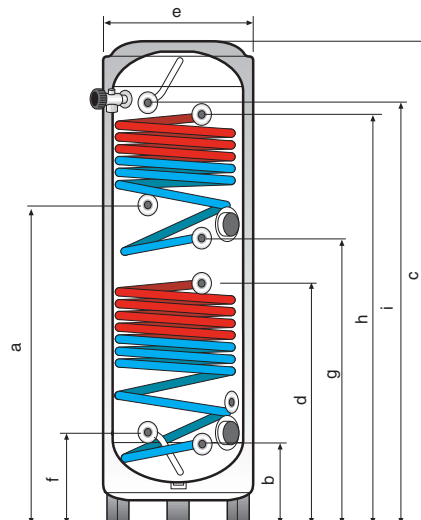
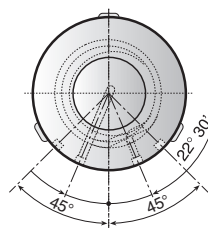

WALL-HUNG

DIRECT: ST 100

WALL-HUNG UNVENTED CYLINDERS

10 10 year
guarantee



SLIM

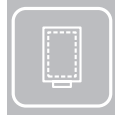

ENAMELLED
STEEL TANK

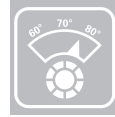

TEMPERATURE
REGULATION



ENVIRONMENTALLY
FRIENDLY
INSULATION

- QUALITY STEEL TANK, 12 BAR PRESSURE TESTED AND EXCLUSIVE VITREOUS ENAMEL COATING
- ENVIRONMENTALLY SOUND AND HIGHLY EFFICIENT THERMAL INSULATION
- PROTECH ANTI-CORROSION SYSTEM
- INTERNAL REGULATION THERMOSTAT
- FACTORY FITTED 1/2" T&P RELIEF VALVE
- DUAL POLE THERMAL CUT-OUTS

- UNVENTED CONTROL KIT SUPPLIED WITH CYLINDER
- SPACE SAVING WALL FIXING
- SIMPLE INSTALLATION
- 10 YEAR TANK GUARANTEE (2 YEAR GUARANTEE ON ELECTRICAL COMPONENTS)



Technical data - Overall dimensions

Model		ST 100
Product Code		893168/406814
Nominal capacity	l	100
Weight empty	kg	41
Weight full	kg	141
Voltage	V	240
Power	kW	3
Reheat time ($\Delta T = 50^\circ\text{C}$)	min.	120
Max. Working Temp.	$^\circ\text{C}$	70
Typical application*		A

	ST 100
a mm	530
b mm	230
c mm	750
d mm	175
e mm	560
f mm	500
g mm	575
h mm	3/4"

**Typical application

- A: domestic usage <2 people (kitchen, bathrooms)

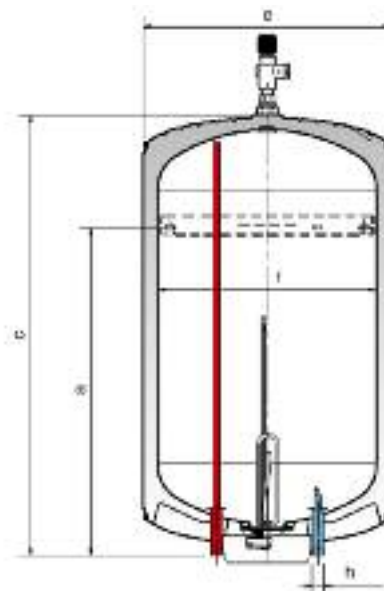
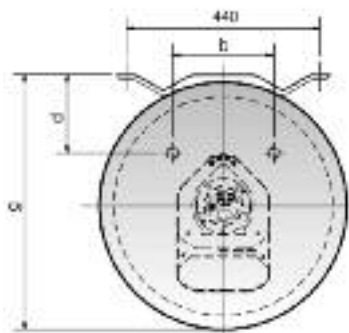

CLAS HE R, CLAS HE & E-SYSTEM

CLAS HE R 12, 18 & 24
CLAS HE 18, 24 & 30
E-SYSTEM 24 & 30



WALL-HUNG HIGH EFFICIENCY
GAS SYSTEM BOILERS



COMPACT
DIMENSIONS



QUIET
OPERATION



AUTO



SAVING

- SEDBUK BAND A
- AVAILABLE IN THREE & TWO OUTPUTS
- COMPREHENSIVE RANGE OF WIRED AND WIRELESS CONTROLS
- UNIQUE 'AUTO' FUNCTION OPTIMISES EFFICIENCY OF BOILER AND SYSTEM
- AUTO-DIAGNOSTIC SYSTEM
- SIMPLE MAINTENANCE WITH ACCESS FROM THE FRONT OF THE APPLIANCE

- ANTI-FROST DEVICE
- BUILT-IN AUTOMATIC BY-PASS
- INCLUDES CONNECTION KIT AND FILLING LOOP (E-SYSTEM & CLAS HE SYSTEM)
- 5 YEAR GUARANTEE (CLAS HE), 2 YEAR GUARANTEE (E-SYSTEM)

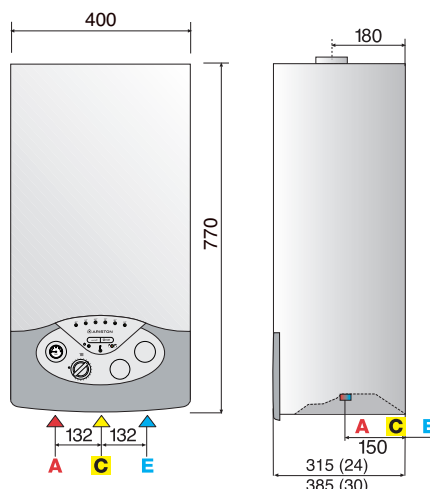
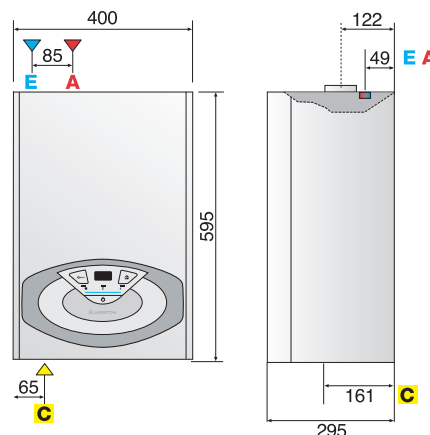
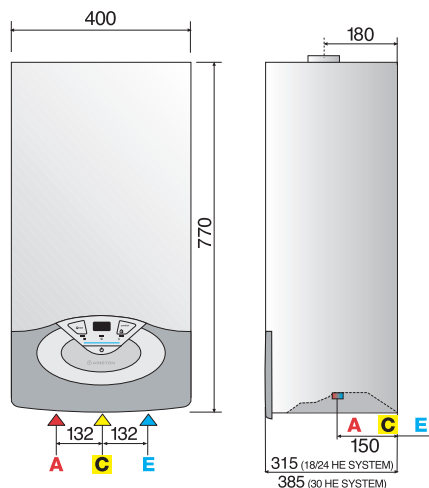

LEGEND

- A: Central heating flow 22mm compression
C: Gas inlet 15mm compression
E: Central heating return 22mm compression
F: Flue (Ø mm)
F1: 60/100 - 80/125
F2: 80

Coaxial exhaust - CLAS HE, E-SYSTEM

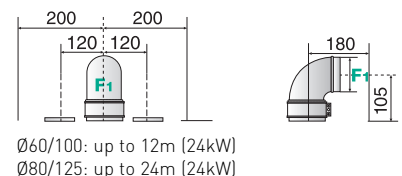

Twin pipe exhaust - CLAS HE, E-SYSTEM

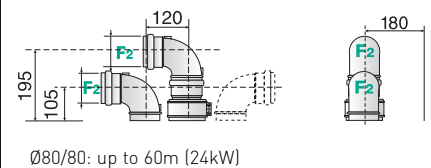

Coaxial exhaust - CLAS HE R

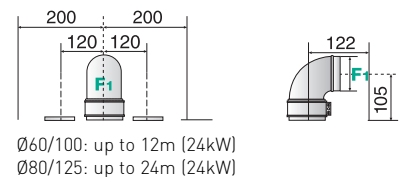

Twin pipe exhaust - CLAS HE R

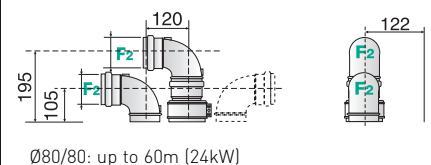

SOLAR COLLECTORS

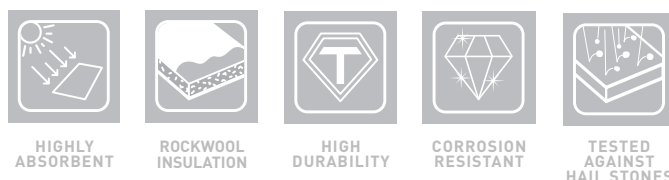

- TOTAL SURFACE AREA 2M²
- CAPTIVE SURFACE AREA 1.8M²
- SPECIAL SOLAR GLASS – HIGH TRANSPARENCY, TEMPERED, ANTI REFLECTIVE AND PRISMATIC
- ABSORBER PLATE: HIGH GRADE COPPER WITH TINOX TITANIUM COATING
- FRAME: GREY ANODISED ALUMINIUM
- INSULATION: 50MM ROCKWOOL
- LOW MOUNTING PROFILE
- EN12975 APPROVED
- 5 YEAR GUARANTEE

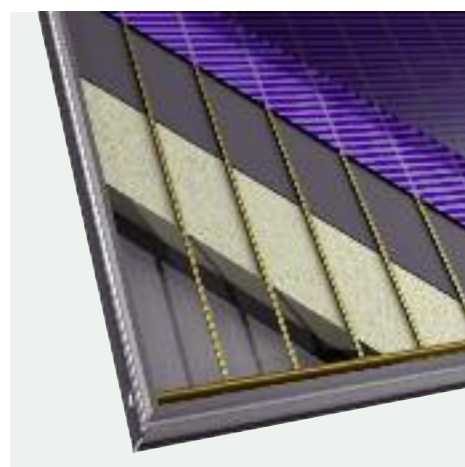

Technical Data - Overall Dimensions

		Solar Collector CF 2.0
Weight when empty	Kg	35.6
Working pressure	bar	6
Collector tube diameter	mm	18
Collector liquid capacity	l	1.02
Absorption	%	95
Reflection	%	5
Aperture area	m ²	1.82
Absorbent area	m ²	1.74
η_0		0.738*
k_1	W/m ² K	4.0*
k_2	W/m ² K ²	0.012*
T stagnation	°C	161.6

* Data refers to the aperture area

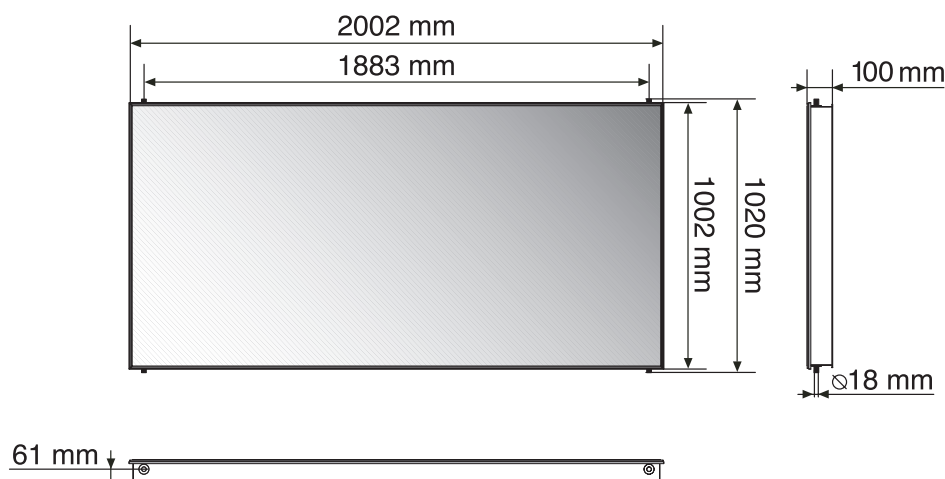
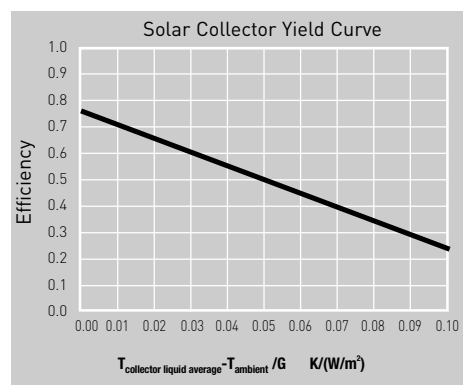

Ariston Thermo UK Limited
Ariston Building
Hughenden Avenue
High Wycombe
Bucks HP13 5FT
Telephone 01494 755600
Fax 01494 459775

Technical Advice & Customer Service
Fax 01494 463066
technical.uk@aristonthermo.com
info.uk@aristonthermo.com

www.ariston.co.uk

 **0870 241 8180**
technical advice

 **0870 600 9888**
customer service