

Fixed Integral Orifice Double Regulating Valve (FODRV) DM941 PN16 DA941 Class 125

CRANE

FLUID SYSTEMS

**DM941 Flanged BSEN 1092-2
BSEN 1092-2 for Single Unit System**

Specification

Single unit Y-pattern globe valves incorporating an integral orifice plate to form a fixed orifice flow measurement unit with regulation and isolation capacity. Valves conform to requirements of BS 7350.

Application

Primarily used in injection or other circuits requiring a double regulating valve for systems balancing. Accuracy of flow measurement is $\pm 5\%$ at all open positions of the valve in accordance with BS 7350.

Pressure/Temperature Ratings

Temperature °C	-10 to 100	110	120
Pressure (bar)	16.0	16.0	16.0

Ratings align with BSEN 1092-2 PN16 (formerly BS4504)



DM941

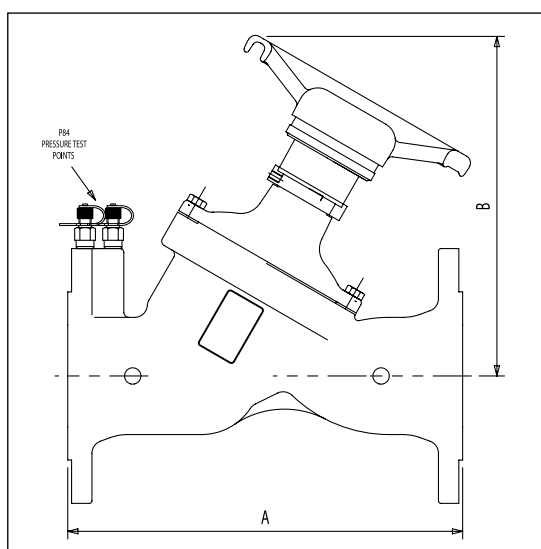

Dimensions and Weights

DN	Face-to-face A mm	Centre-to-top B mm	Weight kg
65	290	262	16.3
80	310	267	20.0
100	350	300	28.5
125	400	325	38.0
150	480	340	51.0
200	600	525	124.0
250	730	575	194.0
300	850	645	254.0

Materials

Part	Material
Body	Ductile Iron
Bonnet:	Ductile Iron
Bonnet gasket	Non-asbestos
Disc (All sizes)	EPDM Coated Cast Iron
Disc Bush	Bronze
Stem	410 SS
Gland (65 to 150mm)	Brass
Gland (200 to 300mm)	Cast Iron
Gland nut	Brass
Packing	Non-asbestos
Seat ring	Bronze

Coefficients*

DN	Flow Kv	Headloss K	Kvs
65	93	6.9	90
80	99	6.8	120
100	136	12.7	220
125	229	8.7	342
150	342	8.9	468
200	550	10.3	792
250	1052	6.0	1224
300	1367	7.8	1800

* Fully open position