

## TECHNICAL DATASHEET

### COMMERCIAL

### OPAC THERMOSTATIC EXPOSED SHOWER VALVE WITH CHROME HANDWHEEL

#### Product Specification

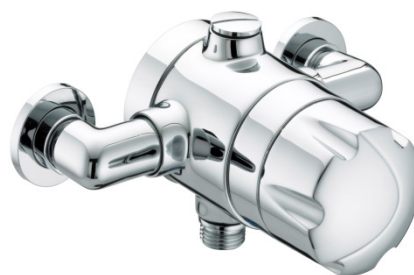

|                         |   |
|-------------------------|---|
| Product Code:           | OP TS1503 EH C  |
| Finish:                 | Chrome  |
| Product Type:           | Commercial  |
| Construction:           | Body is of brass construction and is designed to conform to BS EN 1111:1999 (HP) & BS EN 1287:1999 (LP) |
| Valve Type:             | Thermostatic Cartridge  |
| Supply:                 | Suitable for all plumbing systems (Preferably balanced)   |
| Inlet Connections:      | 15mm compression elbows   |
| Outlet Connections:     | ½" BSP  |
| Working Pressures:      | Min 0.2bar, Max 8.0bar<br>Maximum Static Pressure: 10.0 bar   |
| Dimensions for Fitting: | 148-158mm inlet centres   |

#### Additional Information

- Single sequential control for both temperature & flow.
- Automatic thermostatic shut-off in the event of hot or cold water failure.
- Check valves and serviceable filters as standard
- Supplied as 'valve only' and thus can be customised by choosing accessories from our Pick 'N' Mix showering options. Please see our Product and Price guide for details.
- Adjustable inlet centres between 148-158mm.
- Chrome plated to BS EN 248.

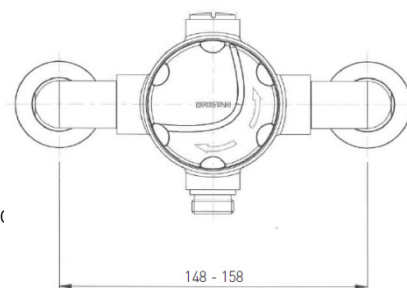
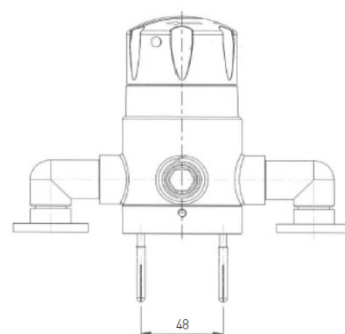
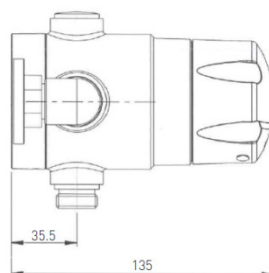

**Technical Advice:** For further information please call 0844 7016273 or email [customer@bristan.com](mailto:customer@bristan.com)

**Guarantee:** 1 year covering manufacturing faults.

#### Compliance / Approvals

WRAS: Certificate N°: 0712092

TMV3: Certificate N°: BC397/1208

#### Flow Rates (litres per minute)

| System Pressure     | 0.2bar | 0.5bar | 1bar | 2bar | 3bar | 4bar | 5bar |
|---------------------|--------|--------|------|------|------|------|------|
| Flow Limiter Fitted | 4.6    | 6.8    | 7.1  | 8.1  | 8.6  | 8.9  | 9.0  |

Bristan, Birch Coppice Business Park, Dordon, Tamworth, B78 1SG  
Telephone: 0844 701 6274 Facsimile: 0844 701 6275  
Web Site: [www.bristan.com](http://www.bristan.com) Email: [enquire@bristan.com](mailto:enquire@bristan.com)



The information contained on this page was correct at date of issue. Fitting dimensions are provided as a guide only. Some variation may occur due to manufacturing tolerances. Bristan pursues a policy of continuing improvement in design and performance of its products and so reserves the right to change specifications without prior notice.

D2