

HEALTHCARE

Twyford
For life

FOR LIFE IN HEALTHCARE

The definitive
product guide
to meeting your
HTM 64 requirements



TWYFORD BATHROOMS THE ESSENTIAL CHOICE FOR COMPLETE HTM64 COMPLIANCE

Contents

- WCs P5
- Washbasins P8
- Urinals/Bidets P11
- Disposal Units P12
- Sinks/Troughs P16
- Stainless Steel Sinks P18
- Janitorial Unit P21
- Brassware P22
- Traps & Wastes P28
- Case Study P30
- Quick Reference Table P32
- SpecMaster P34

With so much at stake, why take risks? Specify Twyford every time - for complete compliance and total peace of mind.

The healthcare sector is one of the most challenging environments facing any specifying professional. It's a sector where issues of hygiene, flexibility and regulatory compliance are as important as product quality and durability.

Twyford's healthcare range has been specifically designed following extensive research into the needs of healthcare managers and specifying professionals. It combines innovation with the highest levels of practicality and attention to detail - enabling specifiers to completely satisfy sanitaryware requirements and regulations, across all areas of the healthcare market.

Market leading products

Twyford leads the market in the provision of innovative products that provide a safer environment for patients, staff and the general public.

- Our revolutionary Avalon and Sola Rimless WCs are unique. They are **the only truly rimless toilets** available in the UK healthcare market - offering cleaner, healthier and safer facilities
- Our healthcare range of WCs include **4 litre single flush low water consumption** options to comply with BREEM

Exceeding national standards

The healthcare environment is highly regulated - as of course it should be. Twyford have responded by investing heavily in continuous product development and innovation. From compliance with HTM 64 to TMV3 and the new water regulations, specifying professionals can be sure that Twyford's healthcare product range will exceed the national standards covering healthcare institutions. Why risk specifying any other? With Twyford you can enjoy complete peace of mind about quality and compliance.

'If Twyford 4 litre low flush option WCs were installed in an average large hospital, the amount of water saved would be as much as 70,080,000 litres per year!'

This assumes the average large hospital has 1000 WCs each flushing on 6 litres.



Twyford specified PFI projects include:

University Hospital, Coventry Contractor: Skanska	Queen Elizabeth Hospital, Birmingham Contractor: Balfour Beatty	Derby Hospital Contractor: Skanska	Freeman Hospital, Newcastle-upon-Tyne Contractor: Laing O'Rourke	Stoke Mandeville Hospital, Buckinghamshire Contractor: Haden Young	Addenbrooks Hospital, Cambridge Contractor: Haden Young	St Helens & Whiston Hospitals, Merseyside Contractor: Taylor Woodrow	North Middlesex University Hospital Contractor: Bouygues
--	--	---------------------------------------	---	---	--	---	---

Taylor Woodrow is now part of Vinci Construction UK Ltd



THEPRODUCTRANGE

AN EASY REFERENCE GUIDE TO ALL
OUR HTM 64 COMPLIANT PRODUCTS

HTM 64 Requirements

Putting emphasis on the prevention of infection, the Department of Health HTM 64 provides regulatory guidance on the design, application and specification of sanitary assemblies in health buildings.

Twyford Solutions

The Twyford healthcare range is fully compliant to all regulations, and indeed exceeds national standards. We offer the complete solution for every healthcare application - in terms of product design and quality, installation and maintenance. **SpecMaster**, our print and online specifiers tool, makes specification easier and more efficient, no matter how complex or demanding the application may be.



WC

For fully ambulant and ambulant disabled users.

CODE: WC H

TYPICAL HTM 64 WC REQUIREMENTS

- Rimless pan for all back-to-wall hospital pattern pans
- Fully enclosed seat holes
- Seat ring only
- WC suite to fully comply with the WC suite Performance Specifications of the Water Supply (Water fittings) Regulations 1999
- Cistern to include flushing arrangements (syphon) adjusted to deliver no more than 6 litre full flush and, if dual flush, smaller volume not to exceed two-thirds of full-flush volume

TWYFORD SOLUTION

- Avalon back-to-wall rimless WC pan
- Seat ring only - White (WH), Blue (BE) or Grey (GY)
- 6 litre concealed plastic cistern with lever, SSIO
- 4 litre concealed plastic cistern with lever, SSIO
- 4 litre concealed plastic cistern with lever, SSIO, delayed action inlet valve

AV1968WH
AV7861..
CX9560XX
CX9540XX
CX9544XX

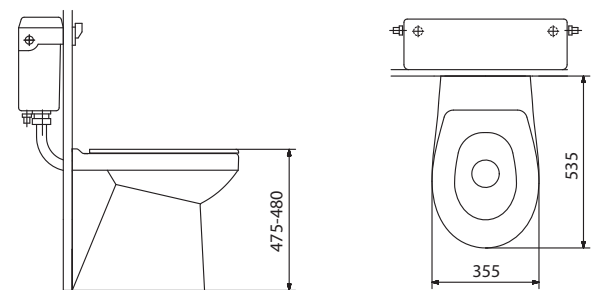

WC

For fully ambulant and ambulant disabled users.

CODE: WC H

TYPICAL HTM 64 WC REQUIREMENTS

- Rimless pan for all back-to-wall hospital pattern pans
- Fully enclosed seat holes
- Seat ring only
- WC suite to fully comply with the WC suite Performance Specifications of the Water Supply (Water fittings) Regulations 1999
- Cistern to include flushing arrangements (syphon) adjusted to deliver no more than 6 litre full flush and, if dual flush, smaller volume not to exceed two-thirds of full-flush volume

TWYFORD SOLUTION

- Sola wall hung rimless WC pan
- Seat ring only - White (WH), Blue (BE) or Grey (GY)
- 6 litre concealed plastic cistern with lever, SSIO
- 4 litre concealed plastic cistern with lever, SSIO
- 4 litre concealed plastic cistern with lever, SSIO, delayed action inlet valve
- Supporting bracket and fixing kit

SA1738WH
AV7861..
CX9560XX
CX9540XX
CX9544XX
SR8138XX

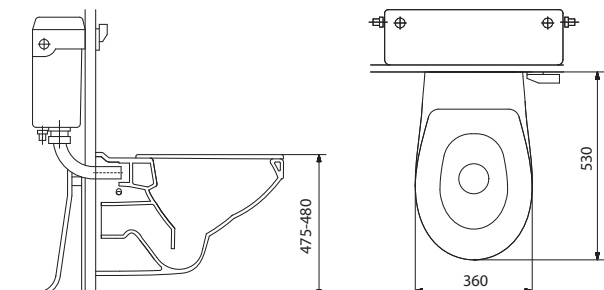

WC

For assisted ambulant disabled/wheelchair users.

CODE: WC HD

TYPICAL HTM 64 WC REQUIREMENTS

- Rimless pan for all back-to-wall hospital pattern pans
- 475 - 480mm height and 700mm projection
- Fully enclosed seat holes
- Seat ring only
- WC suite to fully comply with the WC suite Performance Specifications of the Water Supply (Water fittings) Regulations 1999
- Cistern to include flushing arrangements (syphon) adjusted to deliver no more than 6 litre full flush and, if dual flush, smaller volume not to exceed two-thirds of full-flush volume

TWYFORD SOLUTION

- | | |
|--|----------|
| - Avalon back-to-wall rimless WC pan | AV1968WH |
| - Seat ring only - White (WH), Blue (BE) or Grey (GY) | AV7861.. |
| - 6 litre concealed plastic cistern with lever, SSIO | CX9560XX |
| - 4 litre concealed plastic cistern with lever, SSIO | CX9540XX |
| - 4 litre concealed plastic cistern with lever, SSIO, delayed action inlet valve | CX9544XX |
| - Back rest with cushion White | AV4912WH |
| - 165mm spacer box to achieve overall 700mm projection to comply to HTM 64 | TP9451XX |
| - 215mm spacer box to achieve overall 750mm projection to comply to DOC M | TP9452XX |

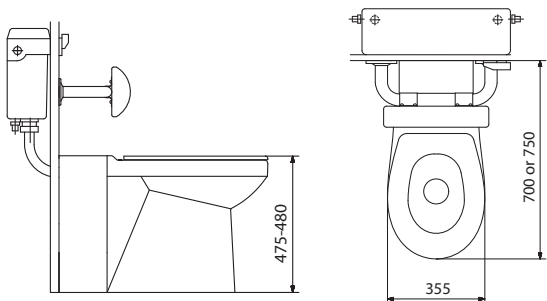

WC

For assisted ambulant disabled/wheelchair users.

CODE: WC HD

TYPICAL HTM 64 WC REQUIREMENTS

- Rimless pan for all back-to-wall hospital pattern pans
- 475 - 480mm height and 700mm projection
- Fully enclosed seat holes
- Seat ring only
- WC suite to fully comply with the WC suite Performance Specifications of the Water Supply (Water fittings) Regulations 1999
- Cistern to include flushing arrangements (syphon) adjusted to deliver no more than 6 litre full flush and, if dual flush, smaller volume not to exceed two-thirds of full-flush volume

TWYFORD SOLUTION

- | | |
|--|----------|
| - Sola wall hung rimless WC pan | SA1738WH |
| - Seat ring only - White (WH), Blue (BE) or Grey (GY) | AV7861.. |
| - 6 litre concealed plastic cistern with lever, SSIO | CX9560XX |
| - 4 litre concealed plastic cistern with lever, SSIO | CX9540XX |
| - 4 litre concealed plastic cistern with lever, SSIO, delayed action inlet valve | CX9544XX |
| - Back rest with cushion White | AV4912WH |
| - 220mm spacer box to achieve overall 750mm projection to comply to DOC M | TP9453XX |
| - Supporting bracket and fixing kit | SR8138XX |

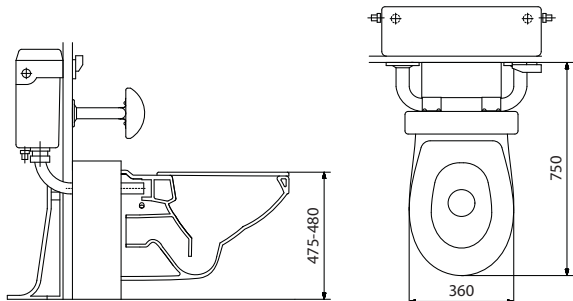

Twyford's healthcare range enables specifiers to completely satisfy sanitaryware requirements and regulations, across all areas of the healthcare market.



WASHBASIN

For use in all clinical areas. For use with concealed services; use with wall mounted supply fittings.

CODE: LB H M

TYPICAL HTM 64 WASHBASIN REQUIREMENTS

- Hospital pattern basin integral back outlet
- No plug, tap hole or overflow
- Connection to concealed services
- Lever action integral TMV3 D08 approved thermostatic or automatic sensor controlled bib mixer tap

TWYFORD SOLUTION

- | | |
|--|----------|
| - 500mm Spectrum basin no tap hole, back outlet | SA4280WH |
| - Spectrum waste & fixing kit | SR1314XX |
| - Sola thermostatic TMV3 wall mounted single lever action tap mixer (TB H2a) | SF1015CP |
| - Sola thermostatic wall mounted infra-red sensor controlled tap mixer (TB H6) | SF1019CP |
| - Electric 240v conversion kit for SF1019CP | SF1020CP |

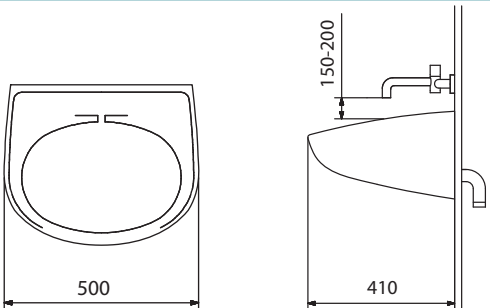

WASHBASIN

For use in areas other than clinical areas. For use with concealed services.

CODE: LB G L

TYPICAL HTM 64 WASHBASIN REQUIREMENTS

- General basin for use with plug and chain with screw stay
- No overflow
- No chainstay hole
- Right hand tap hole or 2 tap hole

TWYFORD SOLUTION

- | | |
|---|----------|
| - 600mm Sola medical basin, 2 tap hole, no overflow (LB G L) | SA4352WH |
| - 600mm Sola medical basin, 1 right hand tap hole, no overflow (LB G L) | SA4355WH |
| - 600mm Sola medical basin, 1 left hand tap hole, no overflow | SA4356WH |
| - 600mm Sola medical basin, no tap hole, no overflow | SA4350WH |
| - ½" inch lever pillar action taps (pair) (TP5) | SF2401CP |
| - Sequential monobloc thermostatic TMV3 basin mixer (TP6) | SF1014CP |
| - 1½" unslotted grid waste (WT1) | WF4341CP |
| - 1½" plastic resealing bottle trap | WF8438XX |
| - Wall bolts | SR1015XX |
| - Total Install® fixing bracket | TI1960XX |

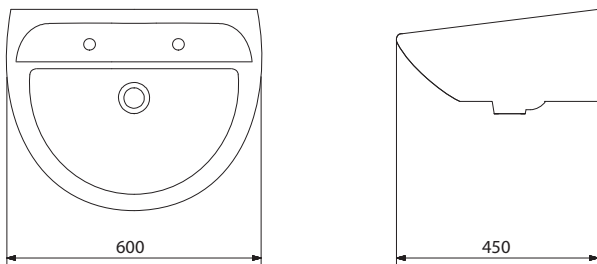

WASHBASIN

For use in areas other than clinical areas. For use with concealed services.

CODE: LB G M

TYPICAL HTM 64 WASHBASIN REQUIREMENTS

- General basin for use with plug and chain with screw stay
- No overflow
- No chainstay hole
- Right hand tap hole or 2 tap hole

TWYFORD SOLUTION

- | | |
|---|----------|
| - 500mm Sola medical basin, 2 tap hole, no overflow (LB G M) | SA4252WH |
| - 500mm Sola medical basin, 1 right hand tap hole, no overflow (LB G M) | SA4255WH |
| - 500mm Sola medical basin, 1 left hand tap hole, no overflow | SA4256WH |
| - 500mm Sola medical basin, no tap hole, no overflow | SA4250WH |
| - ½" inch lever pillar action taps (pair) (TP5) | SF2401CP |
| - Sequential monobloc thermostatic TMV3 basin mixer (TP6) | SF1014CP |
| - 1½" unslotted grid waste (WT1) | WF4341CP |
| - 1½" plastic resealing bottle trap (TRR1/P) | WF8438XX |
| - Wall bolts | SR1015XX |
| - Total Install® fixing bracket | TI1960XX |

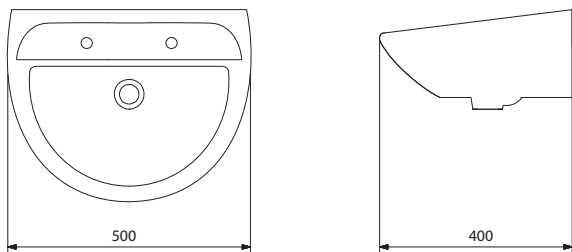

HANDRINSE BASIN

For use other than for clinical procedures or personal washing. For use with concealed services.

CODE: LB G S

TYPICAL HTM 64 HANDRINSE BASIN REQUIREMENTS

- General basin for use with plug and chain with screw stay
- No overflow
- No chainstay hole
- Handrinse basin only
- Right hand tap hole or 2 tap hole

TWYFORD SOLUTION

- | | |
|---|----------|
| - 400mm Sola medical basin, 1 right hand tap hole, no overflow (LB G S) | SA4155WH |
| - 400mm Sola medical basin, 1 left hand tap hole, no overflow | SA4156WH |
| - 400mm Sola medical basin, 2 tap hole, no overflow | SA4152WH |
| - 400mm Sola medical basin, no tap hole, no overflow | SA4150WH |
| - Sequential monobloc thermostatic TMV3 basin mixer (TP6) | SF1014CP |
| - ½" inch lever pillar action taps (pair) (TP5) | SF2401CP |
| - 1½" unslotted grid waste (WT1) | WF4341CP |
| - 1½" plastic resealing bottle trap (TRR1/P) | WF8438XX |
| - Wall bolts | SR1015XX |
| - Total Install® fixing bracket | TI1961XX |

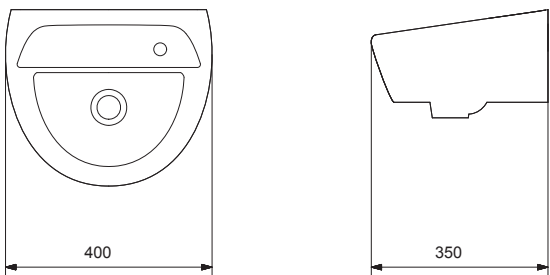

Why risk specifying any other? With Twyford you can enjoy complete peace of mind about quality and compliance.



URINAL

For use with concealed services.

CODE: UR H 1/2/3

TYPICAL HTM 64 URINAL REQUIREMENTS

- Wall mounted single, double or triple urinal
- Concealed trap and for mounted in duct

TWYFORD SOLUTION

- Spectrum bowl urinal
- Spectrum waste & fixing kit
- 4.5 litre ceramic cistern (single urinal)
- 9 litre ceramic cistern (double or triple urinals)
- 4.5 litre plastic cistern (single urinal)
- 9 litre plastic cistern (double or triple urinals)
- Concealed flushpipe (single urinal)
- Concealed flushpipe (double urinal)
- Concealed flushpipe (triple urinal)
- Urinal division
- Hangers

VC7004WH
SR8096XX
CX8611WH
CX8612WH
CX9121XX
CX9122XX
SS6271SS
SS6272SS
SS6273SS
VC8051WH
SR5706XX

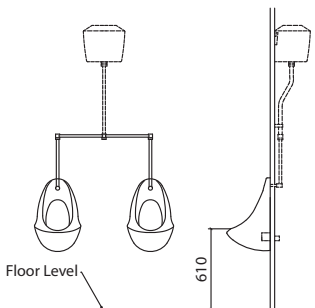

BIDET

Back-to-wall pedestal bidet and sensor-operated spout.

CODE: BD H

TYPICAL HTM 64 BIDET REQUIREMENTS

- Hospital pattern bidet with flush grated waste
- Rimless
- One tap hole
- No overflow & no plug
- With sensor operated TMV3 controlled brassware

TWYFORD SOLUTION

- Sola hospital bidet BD H, 1 tap hole
- 1 1/2" grid waste (WT1)
- Infra red monobloc
- Thermostatic TMV3 mixing valve

SA3521WH
WF4341CP
SF2601CP
SF1037XX

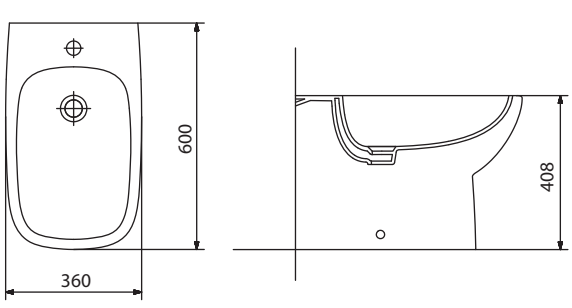

Twyford have invested heavily in continuous product development and innovation in the healthcare market.

DISPOSAL UNIT

For disposal of liquid and solid waste. For use with concealed services: use with wall mounted supply fittings.

CODE: DU

TYPICAL HTM 64 DISPOSAL UNITS REQUIREMENTS

- Hospital pattern disposal unit
- Without drainer
- No tap holes

TWYFORD SOLUTION

- | | |
|--|----------|
| - 600x600x300mm stainless steel hopper, back inlet, no grid (DU) | SS8112SS |
| - 600x600x300mm stainless steel hopper, back inlet | SS8110SS |
| - 600x670x300mm stainless steel hopper, top inlet | SS8109SS |
| Back Inlet Hopper | |
| - Concealed cistern, 6 litre, lever, SS10 | CX9560XX |
| - Plastic flushpipe | CF6217WH |
| Top Inlet Hopper | |
| - Vitreous china high level 6 litre cistern, complete with valveless fittings and chain pull | CX7610WH |
| - Cistern support brackets | SR1300XX |
| - Plastic flushpipe and clip | CF6409WH |
| For Back Inlet and Top Inlet Hopper | |
| - P trap, plastic (white) | WF8602XX |
| - Stainless steel removable outlet grating for hopper | SS9017SS |
| - Stainless steel cantilever brackets (pair) | SS9018SS |
| - Lever bib taps (pair) (TB H1) | SF2301CP |
| - Exposed tap extensions for 150mm projection (pair) | SF2701CP |
| - Exposed tap extensions for 190mm projection (pair) | SF2702CP |
| - Tap extension for concealed pipework (single) | ZQ5567XX |
| - Extended 150mm levers (pair) | SF2704CP |

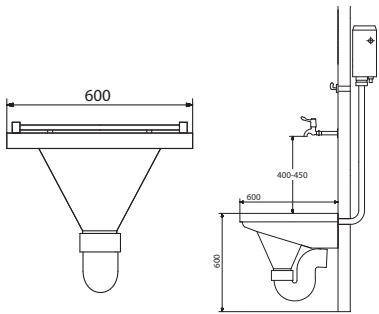

DISPOSAL UNIT

For disposal of liquid and solid waste. For use with concealed services: use with wall mounted supply fittings.

CODE: DU H

TYPICAL HTM 64 DISPOSAL UNITS REQUIREMENTS

- Hospital pattern disposal unit
- No tap holes

TWYFORD SOLUTION

- | | | | |
|---|----------|--|----------|
| - 1000x600mm stainless steel hopper with left hand drainer, right hand hopper, top inlet | SS8101SS | Top Inlet Hopper | |
| - 1000x600mm stainless steel hopper with left hand drainer, right hand hopper, back inlet | SS8102SS | - Vitreous china high level 6 litre cistern, complete with valveless fittings and chain pull | CX7610WH |
| - 1000x600mm stainless steel hopper with right hand drainer, left hand hopper, top inlet | SS8103SS | - Cistern support brackets | SR1300XX |
| - 1000x600mm stainless steel hopper with right hand drainer, left hand hopper, back inlet | SS8104SS | - Plastic flushpipe and clip | CF6409WH |
| Back Inlet Hopper | | For Top Inlet Hopper and Back Inlet Hopper | |
| - Concealed cistern, 6 litre, lever, SS10 | CX9560XX | - P trap, plastic (white) | WF8602XX |
| - High level adaptor kit | CF3067CP | - S trap, plastic (white) | WF8603XX |
| - Plastic flushpipe | CF6217WH | - Stainless steel removable outlet grating for hopper | SS9017SS |
| | | - Stainless steel cantilever brackets (pair) | SS9018SS |
| | | - Stainless steel leg supports (pair) | SS9019SS |
| | | - Lever bib taps (pair) (TB H1) | SF2301CP |
| | | - Exposed tap extensions for 150mm projection (pair) | SF2701CP |
| | | - Exposed tap extensions for 190mm projection (pair) | SF2702CP |
| | | - Tap extension for concealed pipework (single) | ZQ5567XX |
| | | - Extended 150mm levers (pair) | SF2704CP |

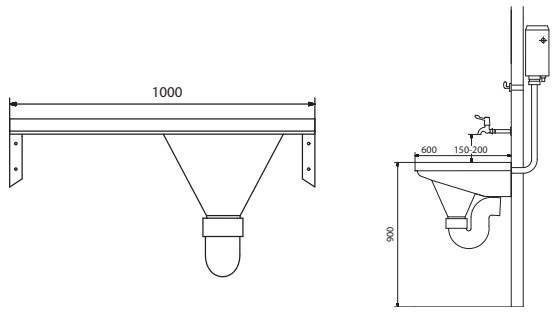

DISPOSAL UNIT

For disposal of liquid and solid waste. For use with concealed services: use with wall mounted supply fittings.

CODE: DU HS

TYPICAL HTM 64 DISPOSAL UNITS REQUIREMENTS

- Hospital pattern disposal unit with sink
- No tap holes
- Right hand drainer available

TWYFORD SOLUTION

- 1600x600mm stainless steel hopper with left hand drainer, right hand hopper, top inlet
- 1600x600mm stainless steel hopper with left hand drainer, right hand hopper, back inlet
- 1600x600mm stainless steel hopper with right hand drainer, left hand hopper, top inlet
- 1600x600mm stainless steel hopper with right hand drainer, left hand hopper, back inlet

Back Inlet Hopper

- Concealed cistern, 6 litre, lever, SS10
- High level adaptor kit
- Plastic flushpipe

SS8105SS

SS8106SS

SS8107SS

SS8108SS

CX9560XX

CF3067CP

CF6217WH

Top Inlet Hopper

- Vitreous china high level 6 litre cistern, complete with valveless fittings and chain pull
- Cistern support brackets
- Plastic flushpipe and clip

For Top Inlet Hopper and Back Inlet Hopper

- P trap, plastic (white)
- S trap, plastic (white)
- Stainless steel removable outlet grating for hopper
- Stainless steel cantilever brackets (pair)
- Stainless steel leg supports (pair)
- Lever bib taps (pair) (TB H1)
- Exposed tap extensions for 150mm projection (pair)
- Exposed tap extensions for 190mm projection (pair)
- Tap extension for concealed pipework (single)
- Extended 150mm levers (pair)

CX7610WH

SR1300XX

CF6409WH

WF8602XX

WF8603XX

SS9017SS

SS9018SS

SS9019SS

SF2301CP

SF2701CP

SF2702CP

ZQ5567XX

SF2704CP

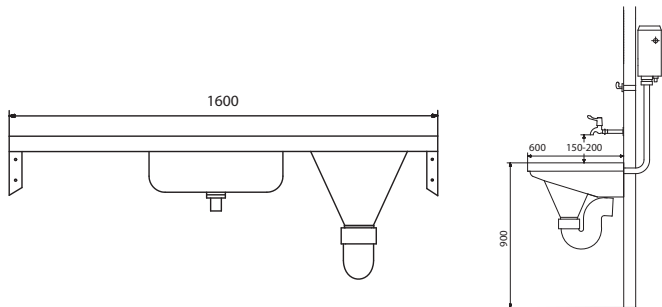

Twyford leads the market in the provision of innovative products that provide a safe environment.



PLASTER SINK

For use with concealed fittings. Use with bib taps. Suitable for mounting on wall brackets, stand supports or base unit.

CODE: PS H
TYPICAL HTM 64 PLASTER SINK REQUIREMENTS

- Stainless steel plaster sink
- Left or right hand drainer
- No tap holes
- No overflow

TWYFORD SOLUTION

- | | |
|---|----------|
| - 1200x600x400mm plaster sink, left hand drainer, right hand sink, satin polish, no tap holes complete with sump basket lid and grated outlet waste | SS9115SS |
| - 1200x600x400mm plaster sink, right hand drainer, left hand sink, satin polish, no tap holes complete with sump basket lid and grated outlet waste | SS9215SS |
| - Stainless steel cantelever brackets (pair) | SS9018SS |
| - Stainless steel leg supports (pair) | SS9019SS |
| - 1½" unslotted chain waste fitting | SS9225CP |
| - Lever bib taps (pair) (TBH 1) | SF2301CP |
| - Exposed tap extensions for 150mm projection (pair) | SF2701CP |
| - Exposed tap extensions for 190mm projection (pair) | SF2702CP |
| - Tap extension for concealed pipework (single) | ZQ5567XX |
| - Extended 150mm levers (pair) | SF2704CP |

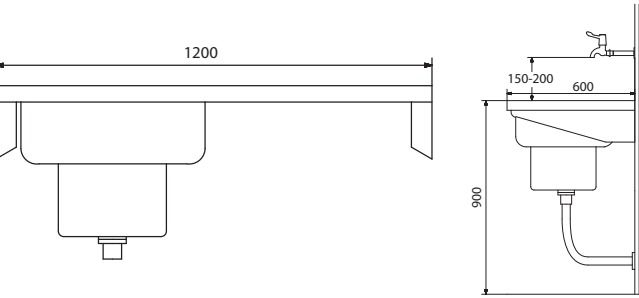

HOSPITAL SINK

For use with concealed services; use with wall mounted supply fittings. Suitable for mounting on base unit, wall brackets or stand support.

CODE: SK1
TYPICAL HTM 64 SINK REQUIREMENTS

- Stainless steel sink single bowl
- No drainer
- 2 tap holes

TWYFORD SOLUTION

- | | |
|--|----------|
| - 600x600x215mm stainless steel sink, single bowl, 2 tap holes (SK1) | SS9223SS |
| - 600x600x215mm stainless steel sink, single bowl, no tap holes | SS9023SS |
| - Stainless steel cantelever brackets (pair) | SS9018SS |
| - Stainless steel leg supports (pair) | SS9019SS |
| - Sola high neck lever taps (pair) (TP3) | SF2403CP |
| - 1½" unslotted chain waste fitting | SS9225CP |

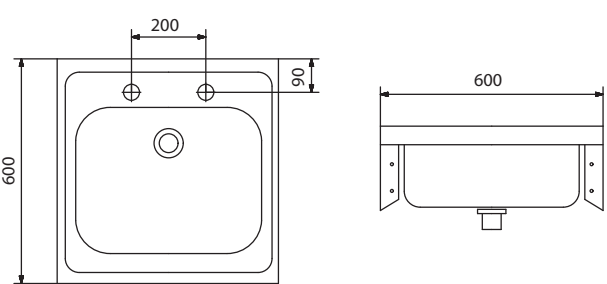

HOSPITAL SINK

For use with concealed services; use with wall mounted supply fittings. Suitable for mounting on base unit, wall brackets or stand support.

CODE: SK2
TYPICAL HTM 64 SINK REQUIREMENTS

- Stainless steel sink single bowl
- No drainer
- 2 tap holes

TWYFORD SOLUTION

- | | |
|---|----------|
| - 1200x600x215mm stainless steel sink, double bowl, 2 tap hole per bowl | SS9424SS |
| - 1200x600x215mm stainless steel sink, double bowl, no tap hole | SS9024SS |
| - Stainless steel cantelever brackets (pair) | SS9018SS |
| - Stainless steel leg supports (pair) | SS9019SS |
| - Sola high neck lever taps (pair) (TP3) | SF2403CP |
| - 1½" unslotted chain waste fitting | SS9225CP |
| - Extended 150mm levers (pair) | SF2704CP |

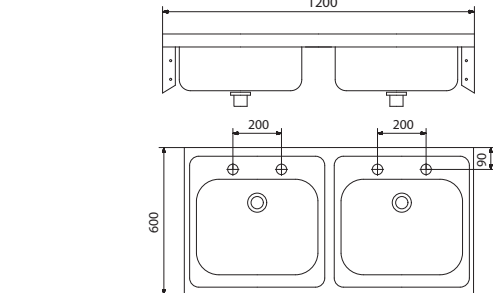

SCRUB UP TROUGH

For use with concealed services; use with wall mounted supply fittings.

CODE: SU H1/2/3
TYPICAL HTM 64 SCRUB UP TROUGH REQUIREMENTS

- Wall mounted stainless scrub up trough, one, two and three persons
- Right hand and left hand outlets available

TWYFORD SOLUTION

- | | |
|--|----------|
| - 750x400x470/500mm, stainless steel, rear outlet waste, right hand outlet (SU H 1) | SS9120SS |
| - 750x400x470/500mm, stainless steel, rear outlet waste, left hand outlet (SU H 1) | SS9220SS |
| - 1500x400x470/500mm, stainless steel, rear outlet waste, right hand outlet (SU H 2) | SS9121SS |
| - 1500x400x470/500mm, stainless steel, rear outlet waste, left hand outlet (SU H 2) | SS9221SS |
| - 2250x400x470/500mm, stainless steel, rear outlet waste, right hand outlet (SU H 3) | SS9122SS |
| - 2250x400x470/500mm, stainless steel, rear outlet waste, left hand outlet (SU H 3) | SS9222SS |
| - Lever bib taps (pair) (TBH 1) | SF2301CP |
| - Exposed tap extensions for 150mm projection (pair) | SF2701CP |
| - Exposed tap extensions for 190mm projection (pair) | SF2702CP |
| - Tap extension for concealed pipework (single) | ZQ5567XX |
| - Sola thermostatic TM3V wall mounted single lever action tap mixer (TBH 2a) | SF1015CP |
| - Sola thermostatic wall mounted infra-red sensor controlled tap mixer (TB H6) | SF1019CP |
| - Extended 150mm levers (pair) | SF2704CP |

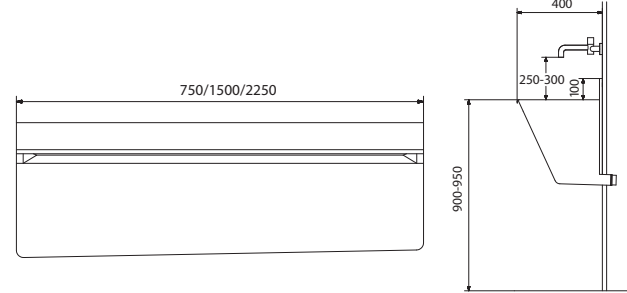
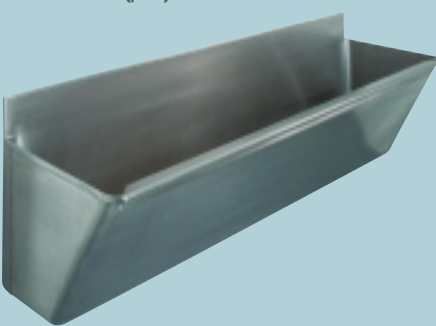

STAINLESS STEEL SINK

For use with concealed services; use with wall mounted supply fittings. Use option with tap holes only when impractical to conceal pipework, then supply pipework is surface mounted below sink. Suitable for mounting on base unit, wall brackets or stand support.

CODE: STA

TYPICAL HTM 64 SINK REQUIREMENTS

- Single bowl single drainer
- Left or right hand stainless sink
- No tap holes

TWYFORD SOLUTION

- | | | | |
|--|----------|--|----------|
| - 1200x600x218mm single left hand sink & right hand drainer, stainless steel, waste, no tap hole (STA) | SS4150SS | - Stainless steel cantilever brackets (pair) | SS9018SS |
| - 1200x600x218mm single left hand sink & right hand drainer, stainless steel, waste, 2 tap hole | SS4050SS | - Stainless steel leg supports (pair) | SS9019SS |
| - 1200x600x218mm single right hand sink & left hand drainer, stainless steel, waste, no tap hole (STA) | SS4151SS | - Lever bib taps (pair) (TBH 1) | SF2301CP |
| - 1200x600x218mm single right hand sink & left hand drainer, stainless steel, waste, 2 tap hole | SS4051SS | - ½" lever action pillar taps (pair) | SF2403CP |
| | | - Exposed tap extensions for 150mm projection (pair) | SF2701CP |
| | | - Exposed tap extensions for 190mm projection (pair) | SF2702CP |
| | | - Tap extension for concealed pipework (single) | ZQ5567XX |
| | | - Extended 150mm levers (pair) | SF2704CP |

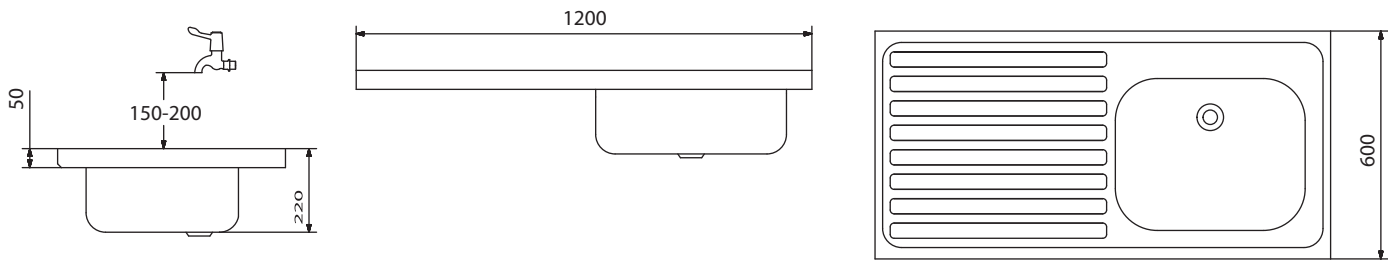

STAINLESS STEEL SINK

For use with concealed services; use with wall mounted supply fittings. Use option with tap holes only when impractical to conceal pipework, then supply pipework is surface mounted below sink. Suitable for mounting on base unit, wall brackets or stand support.

CODE: STB

TYPICAL HTM 64 SINK REQUIREMENTS

- Single bowl double drainer
- No tap holes

TWYFORD SOLUTION

- | | |
|---|----------|
| - 1800x600x218mm single sink and double drainers, stainless steel, waste, no tap hole, central sink (STB) | SS4152SS |
| - 1800x600x218mm single sink and double drainers, stainless steel, waste, 2 tap hole, central sink | SS4052SS |
| - Stainless steel cantilever brackets (pair) | SS9018SS |
| - Stainless steel leg supports (pair) | SS9019SS |
| - Lever bib taps (pair) (TBH 1) | SF2301CP |
| - ½" lever action pillar taps (pair) | SF2403CP |
| - Exposed tap extensions for 150mm projection (pair) | SF2701CP |
| - Exposed tap extensions for 190mm projection (pair) | SF2702CP |
| - Tap extension for concealed pipework (single) | ZQ5567XX |
| - Extended 150mm levers (pair) | SF2704CP |

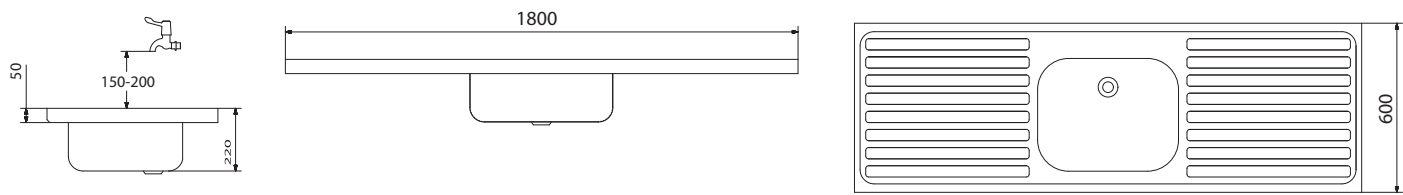

STAINLESS STEEL SINK

For use with concealed services; use with wall mounted supply fittings. Use option with tap holes only when impractical to conceal pipework, then supply pipework is surface mounted below sink. Suitable for mounting on base unit, wall brackets or stand support.

CODE: STC

TYPICAL HTM 64 SINK REQUIREMENTS

- Double bowl single drainer
- No tap holes
- Left or right hand stainless sink

TWYFORD SOLUTION

- 1800x600x218mm double left hand sink and right hand drainer, stainless steel, waste, no tap hole (STC)
- 1800x600x218mm double left hand sink and right hand drainer, stainless steel, waste, 2 tap hole
- 1800x600x218mm double right hand sink and left hand drainer, stainless steel, waste, no tap hole (STC)
- 1800x600x218mm double right hand sink and left hand drainer, stainless steel, waste, 2 tap hole

SS4153SS

SS4053SS

SS4154SS

SS4054SS

- Stainless steel cantilever brackets (three)
- Stainless steel leg supports (three)
- Lever bib taps (pair) (TBH 1)
- ½" lever action pillar taps (pair)
- Exposed tap extensions for 150mm projection (pair)
- Exposed tap extensions for 190mm projection (pair)
- Tap extension for concealed pipework (single)
- Extended 150mm levers (pair)

SS4062SS

SS4063SS

SF2301CP

SF2403CP

SF2701CP

SF2702CP

ZQ5567XX

SF2704CP

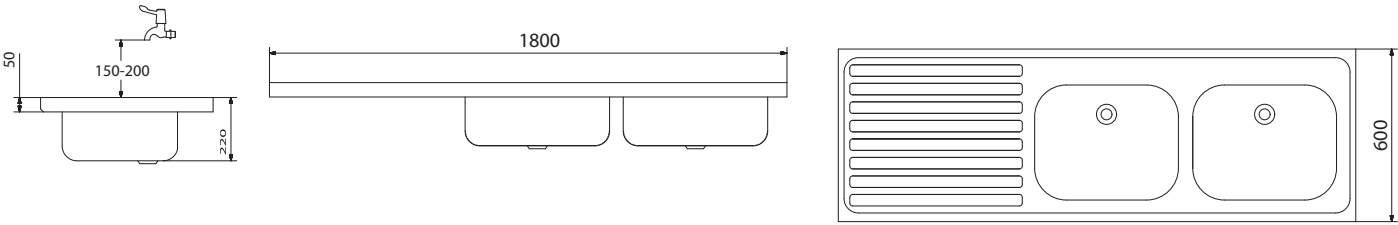

Twyford, the essential choice for complete HTM 64 compliance.



JANITORIAL UNIT

For disposal of liquid waste.

CODE: JU

TYPICAL HTM 64 JANITORIAL UNIT REQUIREMENTS

- Stainless steel combination sink and basin janitorial unit

TWYFORD SOLUTION

- Combination janitorial unit including monobloc mixer, waste leg set and grid

SS8801SS

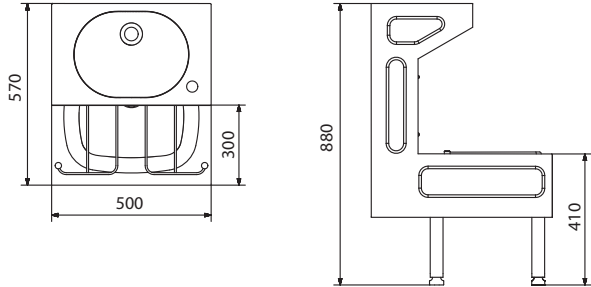

Twyford's healthcare range has been specifically designed following extensive research into the needs of healthcare managers and specifying professionals.



1/2" LEVER ACTION BIB TAP

Suitable for use with sinks and hoppers.

CODE: TB H1 TYPICAL HTM 64 REQUIREMENTS

- Pair, metal bib taps with metal headwork
- Shrouded metal quarter-turn
- Lever-action top with colour temperature indicators

TWYFORD SOLUTION

- | | |
|--|----------|
| - 1/2" bib taps, lever action, back inlet (pair) | SF2301CP |
| - Tap extensions for 150mm projection (pair) | SF2701CP |
| - Tap extensions for 190mm projection (pair) | SF2702CP |
| - Extended 150mm levers | SF2704CP |
| - Tap extensions for concealed pipework (single) | ZQ5567XX |
| - Flow restrictors 6 litre (pair) | SF6006XX |

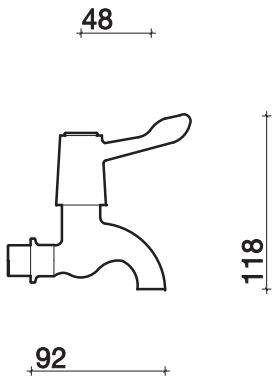

BIB TAP MIXER

Suitable for use in conjunction with hospital pattern basins and scrub-up troughs.

CODE: TB H2A TYPICAL HTM 64 REQUIREMENTS

- Integral thermostatic hospital pattern bib combination mixer tap
- Single lever
- Single flow
- Sequential operation

TWYFORD SOLUTION

- | | |
|---|----------|
| - Thermostatic wall mounted mixer, TMV3 with flexible inlets, sequential single lever | SF1015CP |
|---|----------|

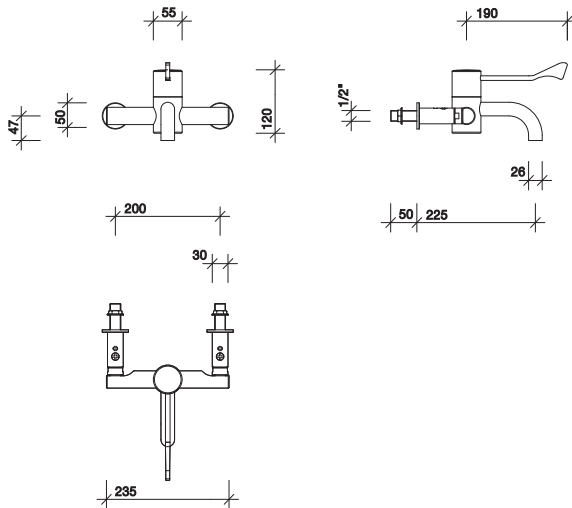

BIB TAP MIXER

Suitable for use in conjunction with hospital pattern basins and scrub-up troughs.

CODE: TB H6

TYPICAL HTM 64 REQUIREMENTS

- Integral thermostatic hospital pattern bib combination mixer tap
- Single flow
- Sequential operation
- Timed flow sensor control

TWYFORD SOLUTION

- Thermostatic wall mounted mixer, TMV3 with infra red sensor SF1019CP
- Electric 240v conversion kit for SF1019CP SF1020CP



BIB COMBINATION TAP

Suitable for use with general baths.

CODE: TB6

TYPICAL HTM 64 REQUIREMENTS

- Metal bib combination tap with all metal headwork
- Rotating lever action taps with coloured indicators

TWYFORD SOLUTION

- 3/4" bib tap for bath, combination tap assembly, fixed nozzle SF1066CP

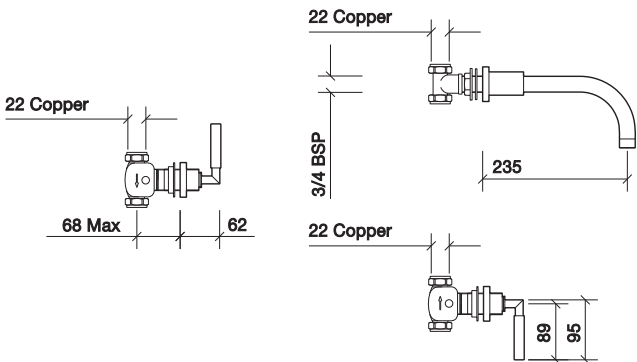

1/2" PILLAR TAP

For use with sinks and sink tops.

CODE: TP3

TYPICAL HTM 64 REQUIREMENTS

- 1/2" pillar taps (pair)
- High neck
- Brass back nut
- Open nozzle and flow straightner

TWYFORD SOLUTION

- 1/2" lever action pillar taps (pair) SF2403CP
- Extended 150mm levers SF2704CP
- Extension tubes (pair) SF2703CP
- Flow restrictors 6 litre (pair) SF6006XX

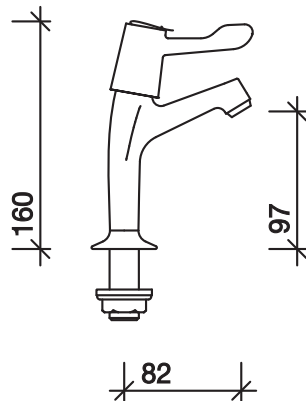

1/2" LEVER PILLAR TAP

Suitable for use with medium/large general basins.

CODE: TP5

TYPICAL HTM 64 REQUIREMENTS

- Metal pillar mixer tap with composite headwork
- Colour temperature indicators
- Thermostatic mixer on hot supply
- Brass back nut

TWYFORD SOLUTION

- 1/2" pillars tap lever action (pair) SF2401CP
- Extended 150mm levers SF2704CP
- 15mm thermostatic mixing valve SF1037XX
- Flow restrictors 6 litre (pair) SF6006XX

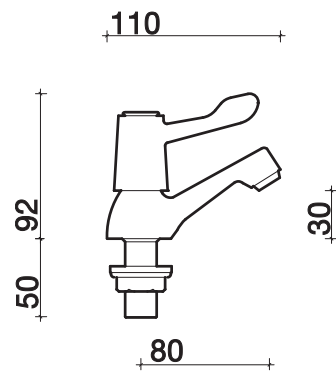

Twyford's healthcare range combines innovation with the highest levels of practicality and attention to detail.

THEMOSTATIC MONOBLOC PILLAR MIXER TAP

For use with general pattern basins in WCs for both hand rinsing and personal washing.

CODE: TP6
TYPICAL HTM 64 REQUIREMENTS

- Metal pillar mixer tap with composite headwork
- Colour temperature indicators
- Short lever

TWYFORD SOLUTION

- Single lever sequential TMV3 thermostatic, monobloc basin mixer, flexible inlets
- SF1014CP

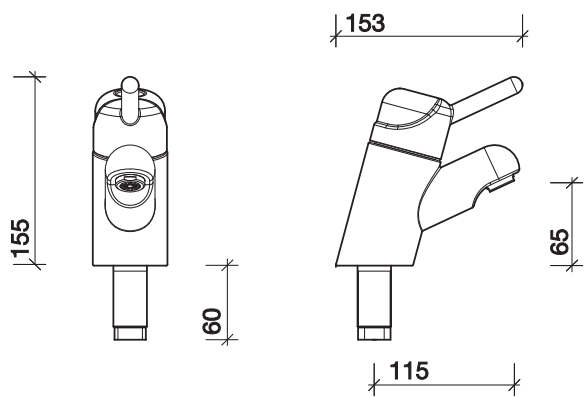

MONOBLOC, PILLAR MIXER, SELF-CLOSING PRESS TAP

For hand washing: use in conjunction with medium and large general basins.

CODE: TPP1
TYPICAL HTM 64 REQUIREMENTS

- Monobloc, pillar mixer tap with metal headwork
- Shrouded metal top
- Colour temperature indicators
- Thermostatic mixer on hot supply
- Non concussive

TWYFORD SOLUTION

- Non concussive monobloc, temperature controlled
 - TMV3 thermostatic 15mm mixing valve
- SF2104CP
SF1037XX

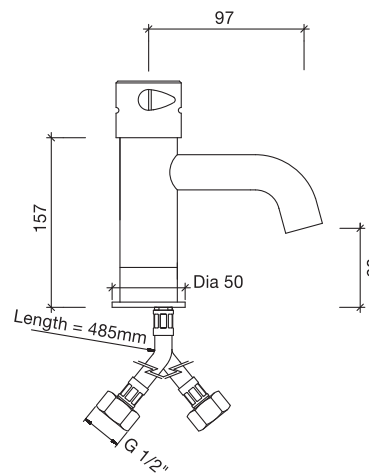

SHOWER FITTINGS

Concealed, wall-mounted thermostatic shower mixer, valve, flexible hose and spray handset, sliding rail kit.

CODE: TM1
TYPICAL HTM 64 REQUIREMENTS

- Metal thermostatic mixer valve (concealed)
- Fail-safe temperature control to TMV3 D08
- Lever-operated metal top

TWYFORD SOLUTION

- Sola thermostatic concealed shower valve TMV3 DO8
 - Sola slide rail, hose & head
- SF1101CP
SF1201CP

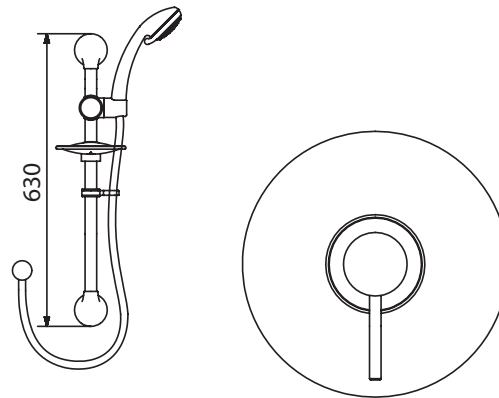

Twyford's healthcare product range exceeds the national standards covering healthcare institutions.



TRAP

All basins.

CODE: TRR1/P

TYPICAL HTM 64 REQUIREMENTS

- 1½" plastic resealing bottle trap
- White

TWYFORD SOLUTION

- 1½" plastic resealing bottle trap

WF8438XX

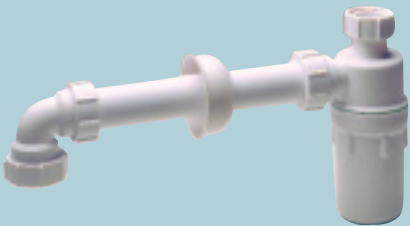

WASTE

For use with small general basins and hospital pattern bidets.

CODE: WT1

TYPICAL HTM 64 REQUIREMENTS

- 1½" unslotted flush-grated waste, chrome plated on brass

TWYFORD SOLUTION

- 1½" unslotted flush grated waste, chrome plated, long tail

WF4341CP



WASTE

For use with bottom outlet scrub-up troughs and sinks used in clinical procedures. Use plastic option with urinals and removable top-access shower wastes.

CODE: WT2

TYPICAL HTM 64 REQUIREMENTS

- 1½" unslotted flush-grated waste, chrome plated on brass

TWYFORD SOLUTION

- 1½" unslotted flush-grated waste, chrome plated, long tail

WF4343CP



WASTE

For use with domestic services sinks, sink tops and baths. Use slotted option for domestic baths.

CODE: WT4

TYPICAL HTM 64 REQUIREMENTS

- 1½" unslotted recessed grated waste, chrome plated on brass, plug with chrome plated link chain and screw stay

TWYFORD SOLUTION

- 1½" unslotted chain waste fitting, plastic plug

WF4338CP



CASESTUDY

BACKGROUND:

The St Helens and Knowsley Strategic Redevelopment (Hospitals) project is part of the UK Government PFI programme. The £338m project is one of the largest healthcare PFI projects ever to be delivered and is the largest single investment in healthcare in Merseyside since the National Health Service was formed. The development is one hospital split over two sites and includes the provision of new build and refurbishment at the Whiston acute General Hospital site and a new Diagnostic Treatment Centre at the St Helens Site. The 35 year PFI contract is being delivered by New Hospitals, a special purpose company formed by Taylor Woodrow and Innisfree.

HTM 64 REQUIREMENTS:

Increased emphasis on infection control, and in particular a rimless WC pan.

WHY TWYFORD WERE CHOSEN

Matt Shinkfield, Senior Project Manager, Vinci Construction UK Ltd, 'I worked with all the stakeholders, the trust, end users and contract partners to ensure that they were buying together as a consensus. The original consensus was to run with Twyford, and when the HTM specification came into the process it was whole heartedly approved as HTM compliance was there. The integrated plumbing system provider was also running with Twyford, so it ticked all the boxes - the look of the product, it was the best there was, and there was a functionality guarantee.'

WHAT TWYFORD DELIVERED

Fully compliant rimless WC pans

- No covered rim, no hidden channels, no box section and no tubes
- High levels of hygiene and easy cleaning
- Water efficient - flushable on 4 litres as well as 6 litres
- Removes all waste products as efficiently as traditional WCs

Additional HTM compliant products

- New brassware which does not allow water to sit in the spout
- Sola medical basins with positive inward draining to reduce water splashes

Taylor Woodrow is now part of Vinci Construction UK Ltd.

ST HELENS & KNOWSLEY HEALTHCARE TRUST **CLIENT** NEW PFI HOSPITALS AT ST HELENS AND WHISTON **PROJECT**

THE RESULTS

'Twyford really covered all the issues, they did all the certification and longevity guarantees, they even scheduled the programme requirements and tailored their manufacturing capability to the project. They also took a lead role in providing a 'cradle to grave' solution. Basically, it's a real solid collaboration - a text book example of working right through the organisation from everyone we saw - from the local representative to the managing director.'

**Matt Shinkfield, Senior Project Manager,
Vinci Construction UK Ltd.**



SAVING WATER AND MONEY

Twyford's water saving WCs are flushable at 4 litres, rather than 6

The average hospital has 800 - 1000 WCs

Several million litres of water can therefore be saved annually

At Whiston alone, that equates to water savings worth £35,000 pa.

**WATER
EFFICIENT**



Nowhere for germs to hide

A text book example of working right through the organisation'

QUICK REFERENCE

FOR ALL YOUR HTM 64 COMPLIANCE CODES

Product	HTM64 code	Twyford solution	SKU	Further Information
WC	WC H	Avalon back-to-wall pan	AV1968WH	Page 5
WC	WC H	Sola wall hung rimless pan	SA1738WH	Page 5
WC	WC HD	Avalon back-to-wall rimless pan	AV1968WH	Page 6
WC	WC HD	Sola wall hung rimless pan	SA1738WH	Page 6
Washbasin	LB H M	500mm Spectrum basin	SA4280WH	Page 8
Washbasin	LB G L	600mm Sola medical basin	SA4352WH, SA4355WH	Page 8
Washbasin	LB G M	500mm Sola medical basin	SA4252WH, SA4255WH	Page 9
Handrinse basin	LB G S	400mm Sola medical basin	SA4155WH	Page 9
Urinal	UR H 1/2/3	Spectrum bowl urinal	VC7004WH	Page 11
Bidet	B D H	Hospital bidet BD H	SA3521WH	Page 11
Disposal unit	DU	600x600mm stainless steel hopper	SS8112SS	Page 12
Disposal unit	DU H	1000x600mm stainless steel hopper and drainer	SS8101SS, SS8102SS, SS8103SS, SS8104SS	Page 13
Disposal unit	DU HS	1600x600mm stainless steel hopper sink and drainer	SS8105SS, SS8106SS, SS8107SS, SS8108SS	Page 14
Plaster sink	PS H	1200x600x400mm sink	SS9115SS	Page 16
Hospital sinks	SK1	600x600x215mm single bowl	SS9223SS, SS9023SS	Page 16
Hospital sinks	SK2	1200x600x215mm double bowl	SS9424SS, SS9024SS	Page 17
Scrub up trough	SU H1	750x400x470/500mm, one person	SS9120SS, SS9220SS	Page 17
	SU H2	1500x400x470/500mm, two persons	SS9121SS, SS9221SS	Page 17
	SU H3	2250x400x470/500mm, three persons	SS9122SS, SS9222SS	Page 17

QUICK REFERENCE

FOR ALL YOUR HTM 64 COMPLIANCE CODES

Product	HTM64 code	Twyford solution	SKU	Further Information
Stainless steel sink	STA	1200x600x218mm single bowl, single drainer	SS4150SS, SS4151SS	Page 18
Stainless steel sink	STB	1800x600x218mm single bowl, double drainer	SS4152SS	Page 19
Stainless steel sink	STC	1800x600x218mm double bowl, single drainer	SS4153SS, SS4154SS	Page 20
Janitorial unit	JU	Combination janitorial unit	SS8801SS	Page 21
Lever action bib tap	TB H1	½" lever action bib tap (pair)	SF2301CP	Page 23
Bib tap mixer	TB H2A	Wall mounted mixer, TMV3, sequential single lever	SF1015CP	Page 23
Bib tap mixer	TB H6	Thermostatic wall mounted mixer, TMV3 with infra red sensor	SF1019CP	Page 24
Bib combination tap	TB6	½" bib tap for bath, lever action	SF1066CP	Page 24
Pillar tap	TP3	½" lever action pillar tap (pair)	SF2403CP	Page 25
Lever pillar tap	TP5	½" pillar tap lever action (pair)	SF2401CP	Page 25
Thermostatic monobloc pillar mixer tap	TP6	Single lever sequential TMV3 thermostatic monobloc basin mixer	SF1014CP	Page 26
Monobloc, pillar mixer, self-closing press tap	TPP1	Non concussive monobloc, temperature controlled and TMV3 thermostatic mixing valve	SF2104CP/SF1037XX	Page 27
Shower fittings	TM1	Sola thermostatic concealed shower valve TMV3	SF1101CP	Page 27
Trap - all basins	TRR1/P	1¼" plastic resealing bottle trap	WF8438XX	Page 28
Trap - small general basins and hospital pattern bidets	WT1	1¼" unslotted flush grated waste	WF4341CP	Page 29
Trap - scrub up troughs and sinks used in clinical procedures	WT2	1½" unslotted flush grated waste	WF4343CP	Page 29
Trap - domestic services sinks, sink tops and baths	WT4	1½" unslotted chain waste fitting	WF4338CP	Page 29

SPECMASTER

SPECIALIST SOLUTIONS FOR SPECIFIERS - IN PRINT AND ONLINE

The Twyford SpecMaster manual simplifies the process of choosing and specifying products for specific applications. Designed in consultation with architects and developed through research with a wide range of clients, it's an essential resource for every specifier.

YOUR ONLINE SPECIFICATION TOOL

www.specmasteronline.com

SpecMasteronline makes life even easier by providing a comprehensive range of interactive design tools which produce a complete washroom specification - right down to pricing.

To order a SpecMaster manual
call 0870 020 0099 or email
twyford@westex.co.uk



For more information on products for the education sector or to arrange a meeting with your Twyford Area Sales Manager
call 01270 871538 or email
twyford.sales@twyfordbathrooms.com

With thanks to

Bushboard Washrooms Systems Ltd.

www.bushboard-washrooms.co.uk

and **Cubicle Systems Ltd.**

www.cubiclesystems.co.uk

Tel: 01425 615 585

Suppliers of Pre Plumbed Modules

Products can be subject to tolerances due to the manufacturing process. Due to the process of continuous development we reserve the right to amend specifications. The information contained in this publication is believed to be correct and complete at the time of printing. All photographs are a guide only and do not necessarily represent all products available. Twyford Bathrooms reserve the right to change product information without prior notice. E&OE. MAY 2010.

All measurements are shown in millimetres. Drawing sizes are not to scale.

TALK TO TWYFORD ABOUT COMPLETE WASHROOM AND WC SOLUTIONS

Call 01270 879777 or email
twyford.sales@twyfordbathrooms.com



BY APPOINTMENT TO
HER MAJESTY THE QUEEN
MANUFACTURERS OF BATHROOM
& WASHROOM FITTINGS
TWYFORD BATHROOMS
STOKE-ON-TRENT

Twyford
bathrooms

Registered office: Lawton Road, Alsager, Stoke-on-Trent ST7 2DF, UK

T: +44(0) 1270 879777 F: +44(0) 1270 873864

www.twyfordbathrooms.com

Part of the Sanitec Group

TWYN0055/1