



AFTERCARE INSTRUCTIONS

Your fitting has a high quality finish and should be treated with care to preserve the visible surfaces. All surface finishes will wear if not cleaned correctly, the only safe way to clean your mixer is to wipe with a soft damp cloth. Stains can be removed using washing up liquid. All bath cleaning powders and liquids will damage the surface of your fitting even the non-scratch cleaners.

GUARANTEE

All products are manufactured to the highest standards and a 5 year guarantee covers any defect in manufacture.

NOTE: The 5 year guarantee on the valve is invalidated if damaged by any waterborne debris.

In the interests of continuous product development we reserve the right to alter specification as necessary.

PRODUCT CODE: PM SABAS C

TELEPHONE HELPLINE: 0844 701 6273

Bristan Group Ltd
Birch Coppice Business Park
Dordon
Tamworth
Staffordshire
B78 1SG
UK
A Masco Company

Web Site: www.bristan.com
Telephone: 0844 701 6274
Facsimile: 0844 701 6275
Email: enquire@bristan.com

(FI PM SABAS)

(R1)

(MZ)

BRISTAN

PRISM SIDE ACTION BASIN MIXER (With Pop Up Waste)

Fitting Instructions & Contents List

Please keep these instructions for future reference and for the ordering of spare parts.

WATER PRESSURE

This mixer is suitable for use at all supply pressures. However for optimum use both the hot and cold supplies should be reasonably balanced. If the fitting is installed at low pressure (tank fed), then the minimum distance from the outlet of the nozzle to the underside of the cold tank should be approximately 2.0 metres to ensure adequate performance.

This mixer should be installed in compliance with Water Regulations. Where the supplies are unbalanced, i.e. hot water from the cylinder tank/cold from the mains, approved check valves must be fitted in supply pipes. For further details contact your Local Water Authority.

INSTALLATION

1. Identify all components and check for completeness, particularly before arranging fitting.
2. Fit the mixer body (6) to the basin using the plinth and washer (7) above the surface and the fixing kit (8) below.
3. Secure the inlet connection tail pipes (9) to the fitting **by hand only** and then connect the hot and cold supplies.
4. Fit the pop up waste (12), with washer (13) below and washer (14) above the basin. It is recommended that a silicon sealant be applied to both sealing faces of the washers. The plug (15) height can be set by adjusting the horizontal rod (11) and pop up rod connecting bracket, and the screw in the base of plug.
6. Fully open the mixer in the mid position, letting it run for a few minutes to check all joints and connections for leaks.
7. See over the page for aftercare instructions.

Please note: In the unlikely event you find a part missing please contact our Customer Service Helpline on 0844 701 6273 or email enquire@bristan.com for immediate dispatch of part.

CONTENTS

1. Handle
2. Grub Screw
3. Shroud
4. Cartridge Retaining Nut
5. Cartridge
6. Body
7. Plinth & Washer
8. Fixing Kit
9. Tail Pipes
10. Pop Up Rod
11. Horizontal Rod
12. Waste
13. Flat Washer
14. Conical Washer
15. Waste Plug

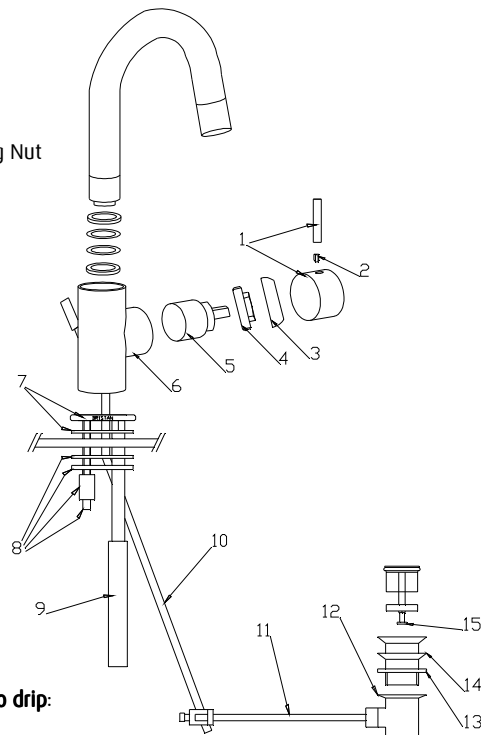

MAINTENANCE

If the fitting begins to drip:

1. Turn off the water supply.
2. Remove the handle lever (1), unscrew the grub screw (2) and then pull off the rest of the handle (1). Unscrew the shroud (3) and then the cartridge retaining nut (4).
3. Remove cartridge (5) from the body (6).
4. Clean or replace cartridge, clean and grease seal and refit. Please note that there are locating pins on the bottom of the cartridge that fit in holes inside the tap, to ensure it is fitted the correct way round.
5. Replace cartridge and head and turn on the water supply.
6. Contact our helpline if problem persists.