

AFTERCARE INSTRUCTIONS

Your fitting has a high quality finish and should be treated with care to preserve the visible surfaces. All surface finishes will wear if not cleaned correctly, the only safe way to clean your mixer is to wipe with a soft damp cloth. Stains can be removed using washing up liquid. All bath cleaning powders and liquids will damage the surface of your fitting even the non-scratch cleaners.

GUARANTEE

All products are manufactured to the highest standards and a 5 year guarantee covers any defect in manufacture. As gold and special effect finishes are softer than chromium plate, special care must be taken when cleaning; a 3 year guarantee covers these .

NOTE: The 5 year guarantee on the valves is invalidated if damaged by any waterborne debris.

In the interests of continuous product development Bristan reserve the right to alter specification as necessary.

PRODUCT CODE: PM 1HBF C / SAT / ST

TELEPHONE HELP LINE: 0844 701 6273

Bristan Group Ltd
Birch Coppice Business Park
Dordon
Tamworth
Staffordshire
B78 1SG
UK
A Masco Company

Web Site: www.bristan.com

Telephone: 0844 701 6273

Facsimile: 0844 701 6275

Email: enquire@bristan.com

(C) PM 1HBF

(D3)

(ST)

BRISTAN

Prism One Hole Bath Filler

Fitting Instructions & Contents List

**Please keep these instructions for future reference
and request of replacement parts.**

For latest prices and delivery to your door visit MyTub Ltd 0845 303 8383 www.mytub.co.uk

WATER PRESSURE

This mixer is suitable for use at all supply pressures from 0.2 bar to 8 bar. However for optimum use both the hot and cold supplies should be reasonably balanced. If the fitting is installed at low pressure (tank fed), then the minimum distance from the outlet of the nozzle to the underside of the cold tank should be 2 metres to ensure adequate performance. This mixer should be installed in compliance with Water Regulations. Where the supplies are unbalanced, i.e. hot water from the cylinder tank / cold from the mains, approved check valves must be fitted in the supply pipes. For further details contact your Local Water Authority.

CONTENTS

- | | | |
|-----|-------------------|------|
| 1. | Head | (x1) |
| 2. | Shroud | (x1) |
| 3. | Retaining Nut | (x1) |
| 4. | Cartridge | (x1) |
| 5. | Mixer Body | (x1) |
| 6. | Rubber Washer | (x1) |
| 7. | Rubber 'C' Washer | (x1) |
| 8. | Metal 'C' Washer | (x1) |
| 9. | Nut | (x1) |
| 10. | Threaded Rod | (x1) |
| 11. | Tails | (x2) |
| 12. | Grub Screw | (x1) |
| 13. | Head Lever | (x1) |

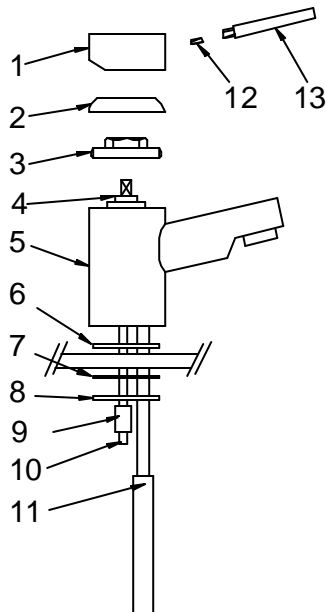

INSTALLATION

1. Identify all components and check for completeness, particularly before arranging fitting.
2. Fit the mixer body to the bath using the full rubber washer (6) between the fitting and the bath, and the 'C' shaped rubber (7) and metal washers (8) on the underside of the bath, to be secured by the nut (9) and threaded rod (10).
3. Fit the tail pipes (11) to the fitting and connect the hot and cold supplies.
4. Fully open the mixer in the mid position, letting it run for a few minutes to check all joints and connections for leaks.
5. See over the page for aftercare instructions.

MAINTENANCE

If the fitting begins to drip:

1. Isolate water supplies.
2. Unscrew lever (13), loosen grub screw (12) and lift off the head (1).
3. Unscrew the shroud (2) and brass retaining nut (3) and lift out the cartridge (4) complete with seal.
4. Clean or replace cartridge, clean and grease seal and refit.

Note: that there are locating pins on the bottom of the cartridge that fit in holes inside the tap, to ensure it is fitted the right way round.

5. Refit the handle and tighten the grub screw. Replace the lever.
6. If problem persists contact our helpline quoting the product code.

Please Note: In the unlikely event you find a part missing please contact our Customer Service Help line on 0844 701 6273 for immediate despatch of part.