

AFTERCARE INSTRUCTIONS

Your fitting has a high quality finish and should be treated with care to preserve the visible surfaces. All surface finishes will wear if not cleaned correctly, the only safe way to clean your mixer is to wipe with a soft damp cloth. Stains can be removed using washing up liquid. All bath cleaning powders and liquids will damage the surface of your fitting, even non scratch cleaners.

GUARANTEE

All products are manufactured to the highest standards and a 5 year guarantee covers any defect in manufacture.

NOTE: The 5 year guarantee on the valve is invalidated if damaged by any water born debris.

In the interests of continuous product development we reserve the right to alter specification as necessary.

PRODUCT CODE: QST BAS C, QST BASNW

Bristan Group Ltd
Birch Coppice Business Park
Dordon
Tamworth
Staffordshire
B78 1SG
UK
A Masco Company

Web Site: www.bristan.com
Telephone: 0844 701 6274
Facsimile: 0844 701 6275
Email: enquire@bristan.com

BRISTAN

Quest Single Lever Basin Mixer and Basin Mixer without Waste

Fitting Instructions & Contents List

Please keep these instructions for future reference and for the ordering of spare parts.

mytub (QST BAS FI)

(D3)

(H)

For latest prices and delivery to your door visit MyTub Ltd 0845 303 8383 www.mytub.co.uk

WATER PRESSURE

This mixer is suitable for use at all supply pressures. However for optimum use both the hot and cold supplies should be reasonably balanced. If the fitting is installed at low pressure (tank fed), then the minimum height from the outlet of the nozzle to the underside of the cold tank should be 2 metres to ensure adequate performance.

This mixer should be installed in compliance with Water Regulations. For further details contact your Local Water Authority.

CONTENTS

- | | |
|---------------------|------|
| 1. Basin mixer body | (x1) |
| 2. Rubber O-Ring | (x1) |
| 3. Rubber C-Plate | (x1) |
| 4. Metal C-Plate | (x1) |
| 5. Tail pipes | (x2) |
| 6. Threaded Rod | (x1) |
| 7. Nut | (x1) |
| 8. Clicker waste | (x1) |
| a. Cartridge | (x1) |
| b. Retaining nut | (x1) |
| c. Shroud | (x1) |
| d. Handle | (x1) |
| e. Grub screw | (x1) |

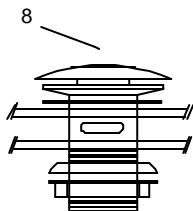
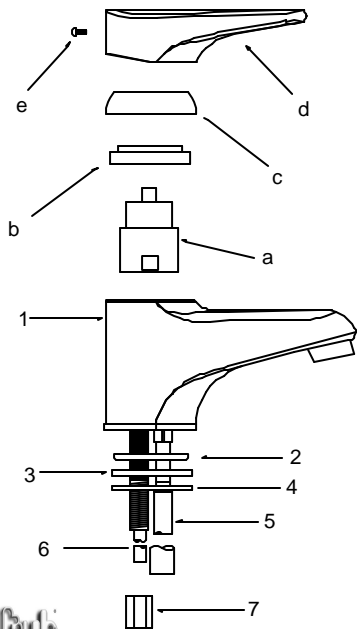

INSTALLATION

1. Identify all components and check for completeness, particularly before arranging fitting.
2. Install the mixer body (1) into the basin using the rubber O rings (2 & 3), C plate (4), threaded rods (6) and nuts (7) provided.
3. Then screw in the copper tail pipes by hand and then connect the hot and cold water supplies.
4. Turn on the water supplies and fully open the mixer in the mid position, letting it run for a few minutes to flush out the system.

5. See over the page for aftercare instructions.

MAINTENANCE

If the fitting begins to drip:

1. Turn off the water supply.
2. Lift out handle cap (at back of handle) and remove grub screw (e), then pull up handle (d).
3. Unscrew the shroud (c) and cartridge retaining nut (b) and lift out the cartridge (a) complete with seal.
4. Clean seating, rubber washer and ceramic disc.
5. Replace all of the above then turn on the water supply.
6. If problem persists contact our helpline quoting the product code.

Please Note: In the unlikely event you find a part missing please contact our Customer Service Help line on 0844 701 6273 or email enquire@bristan.com for immediate despatch of part.