



AFTERCARE INSTRUCTIONS

Your fitting has a high quality finish and should be treated with care to preserve the visible surfaces.

All surface finishes will wear if not cleaned correctly, the only safe way to clean your mixer is to wipe with a soft damp cloth. Stains can be removed using washing up liquid. All bath cleaning powders and liquids will damage the surface of your fitting even the non scratch cleaners.

GUARANTEE

All products are manufactured to the highest standards and a 5 year guarantee covers any defect in manufacture.

As gold and special effect finishes are softer than chromium plate, special care must be taken when cleaning. A 3 year guarantee covers these finishes.

NOTE: - the 5 year guarantee on the valve is invalidated if damaged by any waterborne debris.

PRODUCT CODE: RU SNK C

TELEPHONE HELP LINE! 0870 4425553

Bristan Group Ltd
Lagrange
Lichfield Road Industrial Estate
Tamworth
Staffordshire
B79 7XD
UK

A MASCO COMPANY

Web Site: www.bristan.com

Telephone: 0870 4425556

Facsimile: 0870 4425554

Email: enquire@bristan.com

(FI RU SNK)

(Rev. D3)

(SM)

BRISTAN

Ruby Single Lever Sink Mixer

Fitting Instructions

Please keep these instructions for future reference and for the ordering of spare parts.

WATER PRESSURE

This mixer is suitable for use at a minimum supply pressure of 0.2 bar. However for optimum use both the hot and cold supplies should be reasonably balanced.

If the fitting is installed at low pressure (tank fed), then the minimum distance from the outlet of the nozzle to the underside of the cold tank should be approximately 2.0 metres to ensure adequate performance.

This mixer should be installed in compliance with Water Regulations. For further details contact your Local Water Authority.

CONTENTS

- 1. Mixer Body (x1)
- 2. Sealing Washer (x1)
- 3. Threaded Rod (x1)
- 4. Rubber 'C' Plate (x1)
- 5. Metal 'C' Plate (x1)
- 6. Nut (x1)
- 7. Copper Tail Pipes (x2)
- 8. Check Valve (x1)
- a. Cartridge (x1)
- b. Casing (x1)
- c. Locknut (x1)
- d. Shroud (x1)
- e. Handle (x1)
- f. Grub Screw (x1)
- g. Handle Cap (x1)

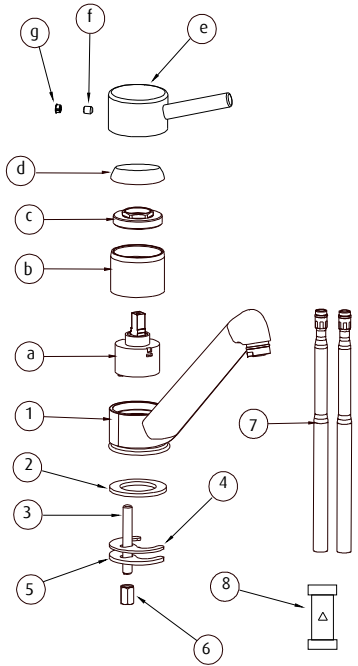

INSTALLATION

1. Identify all components and check for completeness, particularly before arranging fitting.
2. Fit the mixer body (1) to the sink using the 'C' plate fixing kit. The sealing rubber washer (2) goes between the fitting and the sink, and the 'C' shaped rubber and metal washers on the underside of the sink. The nut (6) is then tightened to the sink using the threaded rod (3).
3. Fit the tail pipes (7) to the fitting and connect check valve (8) supplied to hot side (arrow on valve points upwards), then connect the hot and cold supplies.
4. Fully open the mixer in the mid position for a few minutes letting the water flow to check all joints and connections for leaks.
5. See over the page for aftercare instructions.

MAINTENANCE

If the fitting begins to drip:

1. Turn off the water supply.
2. Remove cap (g) and grub screw (f), then remove handle (e) by pulling from cartridge (a). Unscrew shroud (d), lock nut (c), and casing (b).
3. Remove cartridge by pulling out of mixer body. Once removed, carefully clean seating and all exposed parts.
4. Replace all of the above then turn on the water supply.
5. If problem persists contact our helpline quoting the product code.

Please Note: -

In the unlikely event you find a part missing please contact our Customer Service Help line on 0870 4425553 or email enquire@bristan.com for immediate despatch of part.