



For latest prices and delivery to your door visit MyTub Ltd 0845 303 8383 www.mytub.co.uk

## **AFTERCARE INSTRUCTIONS**

Your fitting has a high quality finish and should be treated with care to preserve the visible surfaces.

All surface finishes will wear if not cleaned correctly, the only safe way to clean your mixer is to wipe with a soft damp cloth. Stains can be removed using washing up liquid. All bath cleaning powders and liquids will damage the surface of your fitting even the non-scratch cleaners.

## **GUARANTEE**

All products are manufactured to the highest standards and a 5 year guarantee covers any defect in manufacture.

As gold and special effect finishes are softer than chromium plate, special care must be taken when cleaning, a 3 year guarantee covers these finishes.

**NOTE: - the 5 year guarantee on the valves is invalidated if damaged by any water born debris.**

**PRODUCT CODE: C SNK**

**TELEPHONE HELP LINE! +44 (0)870 4425553**

Bristan Limited  
Lagrange  
Lichfield Road Industrial Estate  
Tamworth  
Staffordshire  
B79 7XD  
UK

A MASCO COMPANY  
Web Site: [www.bristan.com](http://www.bristan.com)  
Telephone: +44 (0)870 4425556  
Facsimile: +44 (0)870 4425554  
Email: [enquire@bristan.com](mailto:enquire@bristan.com)  
(FI C SNK)

(Rev. D1)



# Club Monobloc Kitchen Mixer

## Fitting Instructions

**Please keep these instructions for future reference and for the ordering of spare parts.**

**WATER PRESSURE**

This mixer is suitable for use at all supply pressures. If the fitting is installed at low pressure (tank fed), then the minimum height from the outlet of the nozzle to the underside of the cold tank should be approximately 1.8 metres to ensure adequate performance.

This mixer should be installed in compliance with Water Regulations. For further details contact your Local Water Authority.

### **CONTENTS**

- 1. Mixer Body (x1)
- 2. Spout (x1)
- 3. Full Rubber Washer (x1)
- 4. Rubber 'C' Plate (x1)
- 5. Metal 'C' Plate (x1)
- 6. Copper Tail Pipes (x2)
- 7. Grub Screw (x1)
- 8. Spout Fixing Kit (x1)
- 9. Anti-splash (x1)
- a. Valve (x2)
- b. Handle (x2)
- c. Indices (x2)
- d. Screw (x2)
- e. Cap (x2)

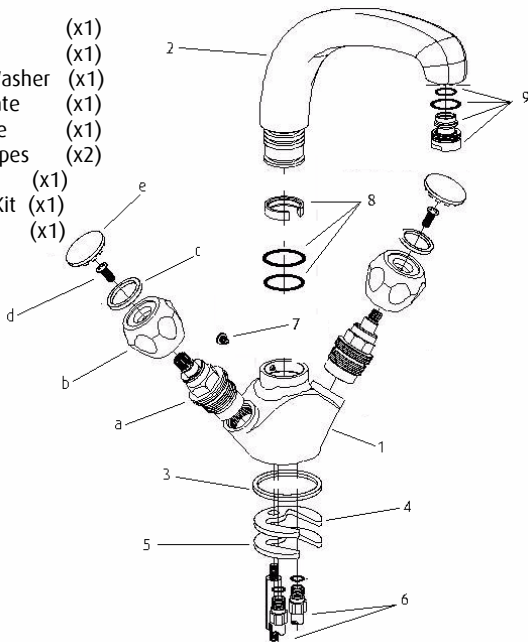

### **INSTALLATION**

1. Identify all components and check for completeness, particularly before arranging installation
2. Fit the mixer body to the sink using the 'C' plate fixing kit (4 & 5). The full rubber washer (3) goes between the fitting and the sink, and the 'C' shaped rubber and metal washers on the underside of the sink.
3. Fit the tail pipes (6) to the fitting and connect the hot and cold supplies.
4. Fully open both valves, letting them run for a few minutes to flush the system.
5. Check all joints and connections for leaks.
6. See over the page for aftercare instructions.

**N.B. please write the name and product code of your fitting in the spaces provided overleaf. This will ensure a speedier service if you should need to phone the help line.**

### **MAINTENANCE**

**All valve types:** - If the fitting begins to drip

1. Turn off the water supply.
2. Remove cap (e), screw (d), indices (c) and handle (b), then remove valve (a).
3. Carefully clean seating and rubber washer.
4. Replace valve and turn on the water supply.
5. Contact our help line if problem persists.

### **Please Note:** -

In the unlikely event you find a part missing please contact our Customer Service Help line on +44 (0)870 4425553 or email [enquire@bristan.com](mailto:enquire@bristan.com) for immediate despatch of part.