



THIS BOOKLET COVERS PRODUCT CODES:

**ARM CTRD01 C
ARM CTRD02 C
ARM WARD01 C
ARM WASQ01 C**

Shower Arm

Fitting Instructions

TELEPHONE HELPLINE: 0844 701 6273

Bristan Group Limited
Birch Coppice Business Park
Dordon
Tamworth
Staffordshire
B78 1SG
UK

A Masco Company

Website: www.bristan.com
Telephone: 0844 701 6274
Facsimile: 0844 701 6275
Email: enquire@bristan.com

(FI ARM CT_WA)

(REV D2)

Please keep these instructions for future reference

For latest prices and delivery to your door visit MyTub Ltd - www.mytub.co.uk - info@mytub.co.uk



This shower arm is intended to be used in conjunction with other products, such as shower or blending valves, diverters and stopcocks from the Bristan ranges in order to create a system to suit your requirements.

COMPONENTS

1. Backnut
2. Locknut
3. Shroud
4. Shower Arm*

INSTALLATION

The shower arm should be arranged to accept a supply of flow controllable mixed water.

1. Identify all components and check for completeness before arranging fitting.
2. The shower arm (4*) should be secured using the backnut (1) and the locknut (2) (where supplied).
3. Rigid pipework should be used to support the arm, via a female G 1/2" BSP to a 15/22mm compression adaptor, (not supplied).

NOTE: Before finishing ceiling, turn on water to supplies to check for leaks at connections.

4. Connect arm to supply using thread sealing compound where necessary.
5. Complete wall finish and slide shroud (3) up to ceiling.

INSTALLATION DIAGRAM

* Design & Dimensions of the shower arm may vary to that shown.

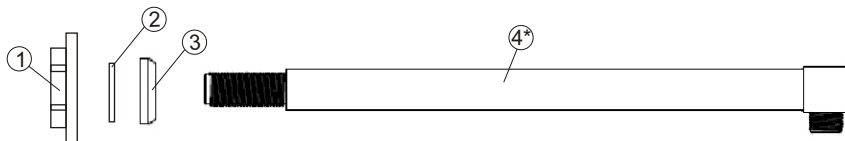

AFTERCARE INSTRUCTIONS

Your fitting has a high quality finish and should be treated with care to preserve the visible surfaces.

All surface finishes will wear if not cleaned correctly, the only safe way to clean your mixer is to wipe with a soft damp cloth. Stains can be removed using washing up liquid. All bath cleaning powders and liquids will damage the surface of your fitting, even the non-scratch cleaners.

NOTE: Never use abrasive detergents or disinfectants or those containing alcohol, hydrochloric acid or phosphoric acid.

Bristan recommend E-Cloth for cleaning all of our bathroom & kitchen products. Using just water, E-cloth gives a smear free, deep clean by breaking up and holding dirt, which normal cloths leave behind. Order through your Bristan stockist. (ORDER CODE: E-CLOTH)



GUARANTEE

All products are manufactured to the highest standards and a 5 year guarantee covers any defect in manufacture.

All products must have access for servicing or replacement during the life of the product.

In the interests of continuous product development we reserve the right to alter specification as necessary