

# DUETTE

DIAGRAM 1

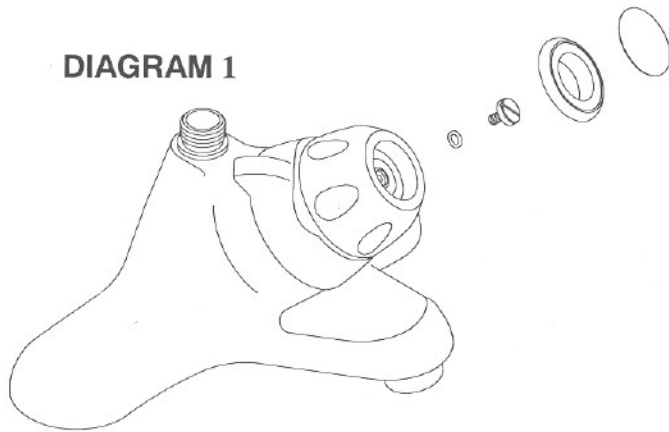
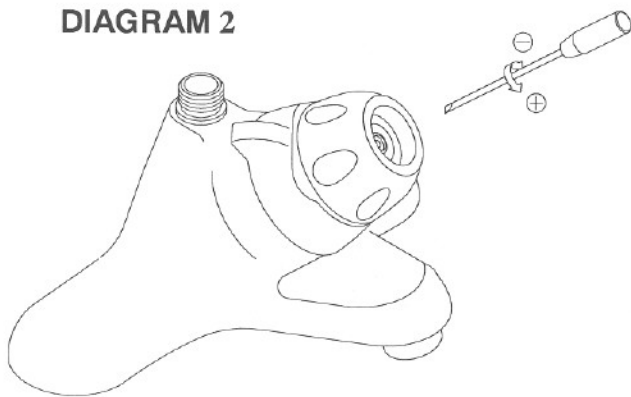

DIAGRAM 2



- TO ADJUST MAXIMUM SET TEMPERATURE
- REMOVE THE INDICE HOLDER TO EXPOSE THE SPINDLE SCREW
- WITH THE TEMPERATURE SET AT THE MAXIMUM SETTING REMOVE THE SPINDLE SCREW.
- PLEASE NOTE WATER WILL RUN THROUGH THIS OUTLET
- USING A SUITABLE SCREWDRIVER (THIN BLADED) LOCATE THE ADJUSTING SCREW THROUGH THE SPIINDLE.
- TURN THE ADJUSTMENT SCREW ANTI-CLOCKWISE FOR WARMER TEMPERATURE AND CLOCKWISE FOR A COOLER TEMPERATURE.
- WHEN THE DESIRED TEMPERATURE IS REACHED REPLACE THE SPINDLE SCREW AND INDICE.